

FAP ROUTE	SECTION	COUNTY	TOTAL SHEETS	SHEET NO.
586	60R-2, 37R-1	MADISON	502	126
STA.	TO STA.			
CONTRACT NO.: 76301				

-  TEMPORARY PAVEMENT
-  WORK AREA
-  LIGHTED DRUM OR BARRICADE (25' CTRS)
-  DIRECTION OF TRAFFIC

PLAN	DATE
BY	
DESIGNED	
CHECKED	
IN CHARGE	
FILE NAME	

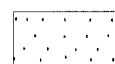
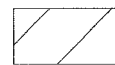
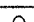
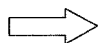
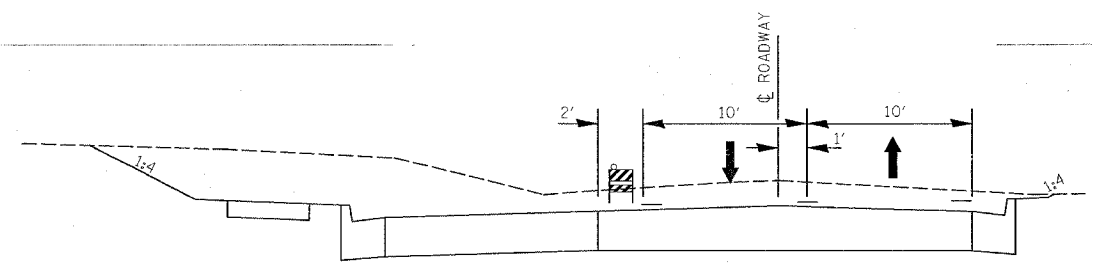
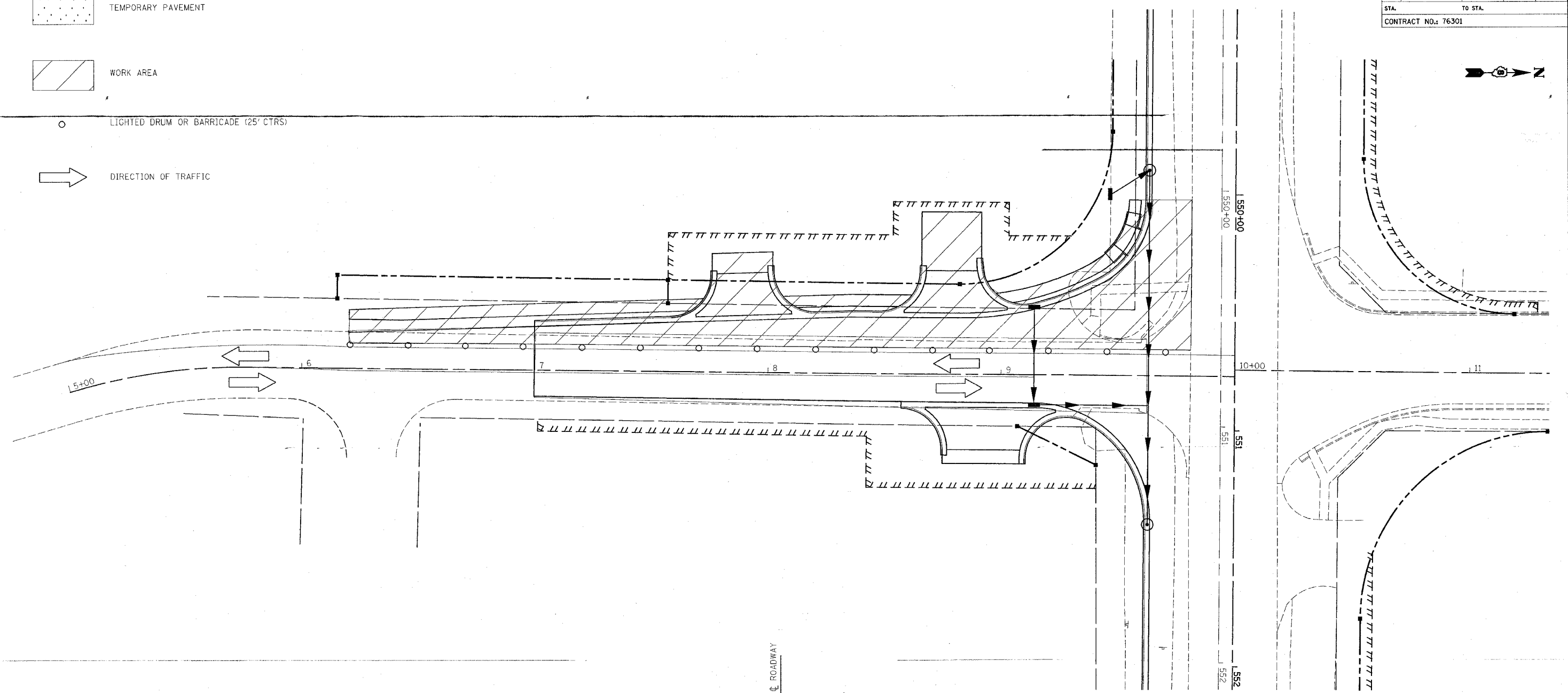

- STAGE 2**
- RELOCATE TEMPORARY SIGNALS
 - SHIFT TRAFFIC
 - REMOVE REMAINING EXISTING PAVEMENT, TEMPORARY PAVEMENT AND TEMPORARY ENTRANCE
 - INSTALL CURB & GUTTER, SIDEWALK, STORM SEWER, INLET AND ENTRANCE
 - PLACE PCC PAVEMENT
 - REMOVE TEMPORARY PAVEMENT MARKING AND PLACE PERMANENT MARKINGS

NOTE: CONTRACTOR SHALL MAINTAIN POSITIVE DRAINAGE AT THE PROPOSED INLETS WITH A METHOD APPROVED OF BY THE ENGINEER. COST TO BE INCLUDED IN 'TRAFFIC CONTROL AND PROTECTION (SPECIAL) LOCATION NO. 1'.

THE RAISED MEDIANS ON IL 162 SHALL NOT BE CONSTRUCTED UNTIL ALL PERMANENT ENTRANCES LOCATED ALONG RIGGIN RD ARE COMPLETED. ACCESS SHALL BE PROVIDED TO THE BANK AND THE PLUMBERS SUPPLY VIA THEIR ENTRANCES ON IL 162 FOR THE DURATION OF THE RIGGIN RD RECONSTRUCTION. COST OF COMPLYING WITH THIS NOTE SHALL NOT BE PAID FOR SEPARATELY, BUT WILL BE INCLUDED IN THE COST FOR 'TRAFFIC CONTROL AND PROTECTION (SPECIAL) LOCATION NO. 1'.

THE CONTRACTOR SHALL MAKE REASONABLE ATTEMPT TO PROVIDE TEMPORARY ACCESS TO THE BANK DURING STAGE 2 AS DIRECTED BY THE ENGINEER.

200 SQ FT OF PAVEMENT MARKING REMOVAL TO BE USED TO REMOVE TEMPORARY PAVEMENT MARKINGS THAT MAY BE IN CONFLICT WITH THE PERMANENT MARKINGS.

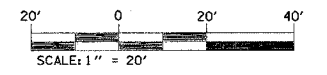

REVISIONS	
NAME	DATE

ILLINOIS DEPARTMENT OF TRANSPORTATION

STAGE CONSTRUCTION

STAGE 2

RIGGIN RD.

FAP ROUTE 586
SECTION 60R-2, 37R-1
MADISON COUNTY

DRAWN BY: