

FAP ROUTE	SECTION	COUNTY	TOTAL SHEETS	SHEET NO.
596	60R-2,37R-1	MADISON	502	219B
STA.	TO STA.		EXISTING CONDITIONS:	
			76301	

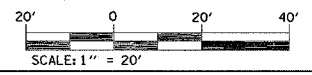

PLAN	SURVEYED	BY	DATE
NOTE BOOK NO.	ADJUSTMENT CHECKED		
	BY		
	FILE NAME		

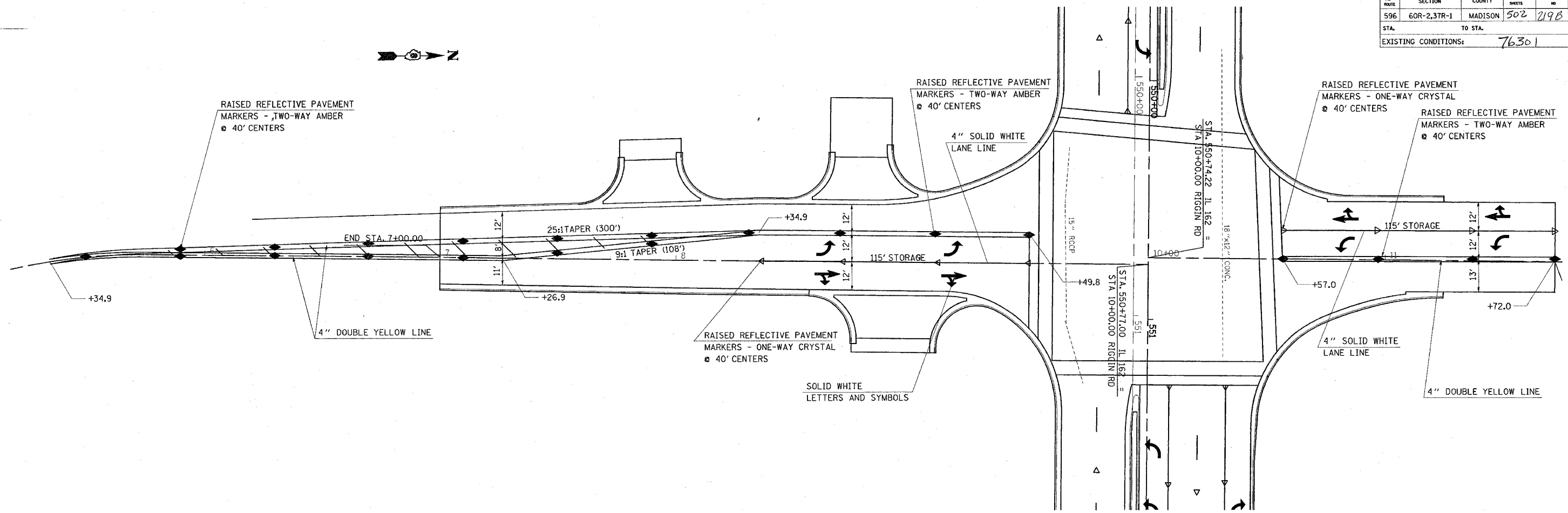

REVISIONS	
NAME	DATE

ILLINOIS DEPARTMENT OF TRANSPORTATION
 PAVEMENT MARKING

FAP ROUTE 586
 SECTION 60R-2,37R-1
 MADISON COUNTY

DRAWN BY:

7/2/2004 9:38:54 AM
 c:\projects\60r237r1\plan\pvmk02b.dgn L:\1-28-04 140-43
 C:\projects\60r237r1\plan\pvmk02b.dgn L:\2-28-04 140-43
 C:\projects\60r237r1\plan\pvmk02b.dgn L:\2-28-04 140-43
 C:\projects\60r237r1\plan\pvmk02b.dgn L:\2-28-04 140-43