

| FAP ROUTE | SECTION      | COUNTY  | TOTAL SHEETS | SHEET NO. |
|-----------|--------------|---------|--------------|-----------|
| 586       | 60R-2, 3TR-1 | MADISON | 502          | 223       |

STA. TO STA.

EXISTING CONDITIONS:

CONTRACT 76301

|               |                    |    |      |
|---------------|--------------------|----|------|
| PLAN          | SURVEYED           | BY | DATE |
| NOTE BOOK NO. | ALIGNMENT CHECKED  |    |      |
|               | PT. OF WAY CHECKED |    |      |
|               | ROAD FILE NAME     |    |      |

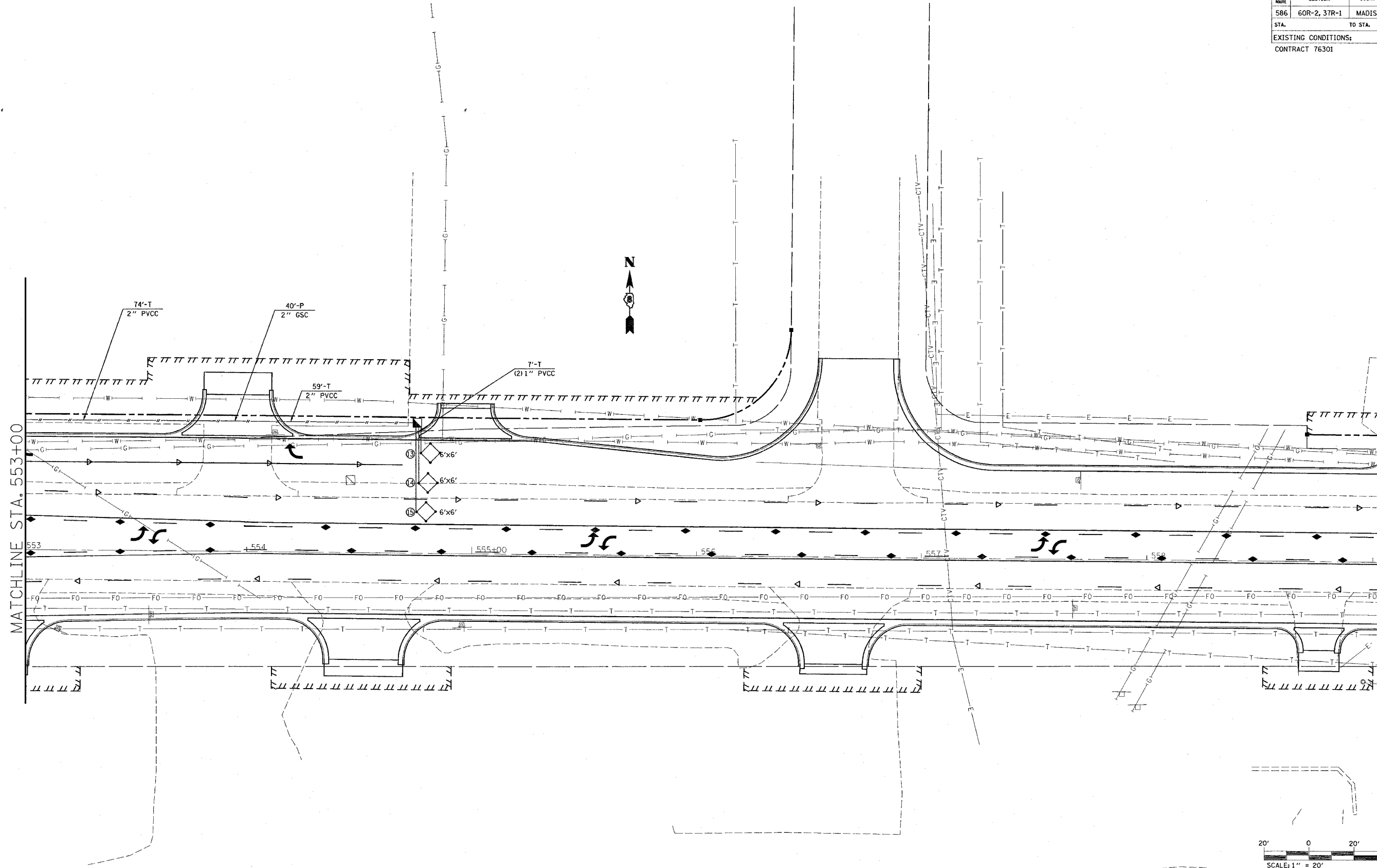

MATCHLINE STA. 553+00

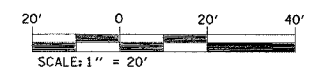

| REVISIONS |      |
|-----------|------|
| NAME      | DATE |
|           |      |
|           |      |
|           |      |
|           |      |
|           |      |

ILLINOIS DEPARTMENT OF TRANSPORTATION  
**TRAFFIC SIGNAL MODERNIZATION**  
**ILL RTE. 162 @ RIGGIN RD.**  
 FAP 586  
 SECTION 60R-2, 3TR-1  
 MADISON COUNTY

DRAWN BY:

PLOT DATE: Wednesday June 30, 2004 @ 9:51:48 AM