

CONTRACT NO. 83560

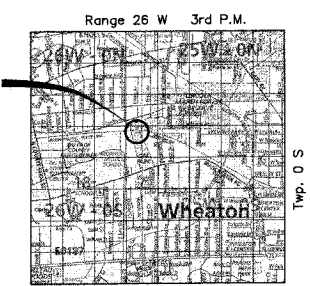

LOCATION SKETCH

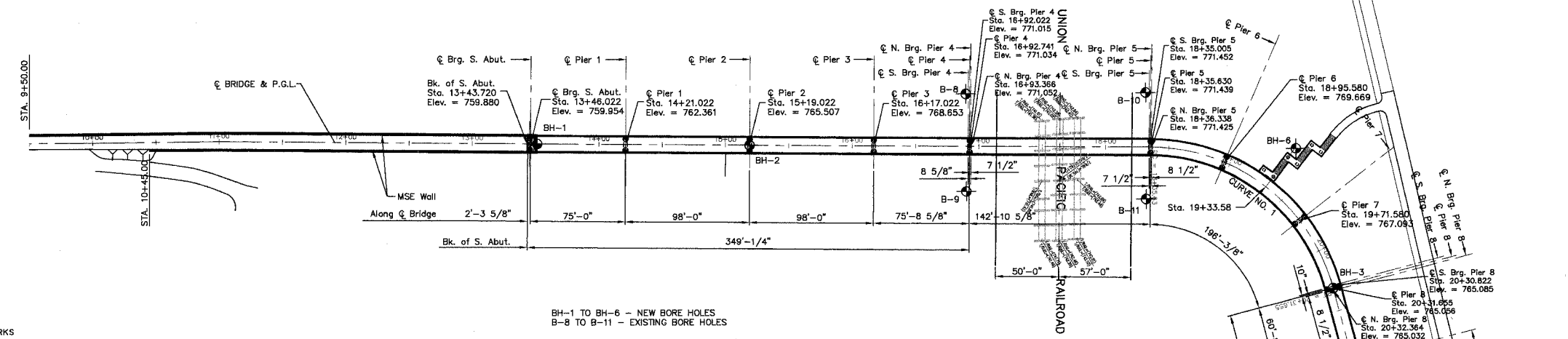

PLAN

**BENCHMARKS**

**ELEVATION REFERENCE MARKS**

DUPAGE COUNTY CONTROL, ALUMINUM DISC # 02943 0.3 MILES EAST OF THE INTERSECTION OF MANCHESTER ROAD AND COUNTY FARM ROAD, ±150' NORTH OF MANCHESTER ROAD. ELEVATION = 735.26

**PROJECT ELEVATION REFERENCE MARKS**

RM1-BOLT BETWEEN "MUE" & "LLER" ON THE FIRST FIRE HYDRANT EAST OF ERIE AVENUE ON THE SOUTH SIDE OF MANCHESTER ROAD. ELEVATION = 757.00

RM2-BOLT UNDER THE LAST "9" IN "1969" ON THE FIRE HYDRANT LOCATED AT THE NORTHWEST CORNER OF MONROE SCHOOL. ELEVATION = 755.82

BH-1 TO BH-6 - NEW BORE HOLES  
B-8 TO B-11 - EXISTING BORE HOLES

**DESIGN SPECIFICATIONS**

- AASHTO Standard Specifications for Highway Bridges - 2002
- AASHTO Guide Specifications for Design of Pedestrian Bridges - 1997
- AASHTO Guide Specifications for Horizontally Curved Steel Girder Highway Bridges - 2003

EVANS AVENUE

**CONSTRUCTION SPECIFICATIONS**

- IDOT - Standard Specifications for Road and Bridge Construction Adopted January 1, 2002
- IDOT - Supplemental Specifications and Recurring Special Provisions Adopted January 1, 2004
- IDOT - Guide Bridge Special Provision

**LOADING**

H10 Truck or Pedestrian Live Load of 85 psf.

**DESIGN STRESSES**

**(FIELD UNITS)**

- $f_c = 3,500$  psi
- $f_y = 60,000$  psi (Rein.)
- $f_y = 50,000$  psi (Structural Steel)
- M-270, Grade 50W

**SEISMIC DATA**

Seismic Performance Category (SPC) = A  
Bedrock Acceleration Coefficient (A) = 0.04g  
Site Coefficient(s) = 1.0

**NOTE:**

THE ELEVATION OF THE EXISTING TOP-OF-RAIL PROFILE SHALL BE VERIFIED PRIOR TO BEGINNING CONSTRUCTION.

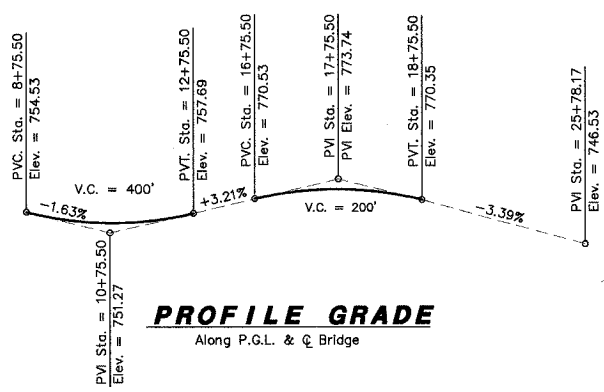

PROFILE GRADE  
Along P.G.L. & Q Bridge

**CURVE 1 DATA**

$\Delta = 74^\circ 52' 34''$   
 $D = 38' 11' 50''$   
 $T = 114.84'$   
 $L = 196.025'$   
 $E = 38.91'$   
 $R = 150.00'$   
 $P.C. = 19+35.63$   
 $P.T. = 20+31.655$   
 $P.L. = 19+50.47$

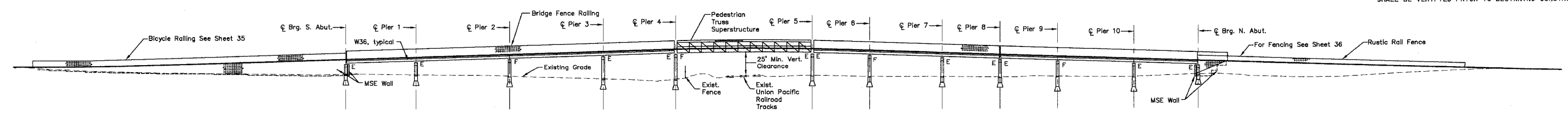

ELEVATION

INDEX OF BRIDGE SHEETS  
SHEET 14 OF 529  
XREF: OVER\_50.DWG  
Copyright © 2003 Cemcon, Ltd. All rights reserved.

PREPARED FOR:  
WHEATON PARK DISTRICT  
666 S. MAIN STREET  
WHEATON, ILLINOIS 60187

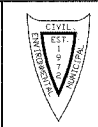

PREPARED BY:  
**CEMCON, Ltd.**  
Consulting Engineers, Land Surveyors & Planners  
2280 White Oak Circle, Suite 100  
Aurora, Illinois 60504-9675  
Ph: 630.862.2100 Fax: 630.862.2199  
E-Mail: cadd@cemcon.com Website: www.cemcon.com

NO.		DATE	DESCRIPTION	NO.		DATE	DESCRIPTION

GENERAL PLAN & ELEVATION - BICYCLE PATH BRIDGE			
PEDESTRIAN/BICYCLE PATH BRIDGE OVER UNION PACIFIC RAILROAD			
FILE NAME: PLAN_50	DSGN. BY: MMH	JOB NO.: 551.007	FLD. BK./PG.: -----
DISC. NUMBER: 551007	DRN. BY: KMS	DATE: 04-26-04	SCALE: 1" = -----
SHEET NO.			14 of 54