

F.A.U. RTE.	SECTION	COUNTY	TOTAL SHEETS	SHEET NO.
2585	00-00068-01-WR	COOK	145	22
STA.	TO STA.			
FED. ROAD DIST. NO.	ILLINOIS	FED. AID PROJECT		
CONTRACT NUMBER 83785				

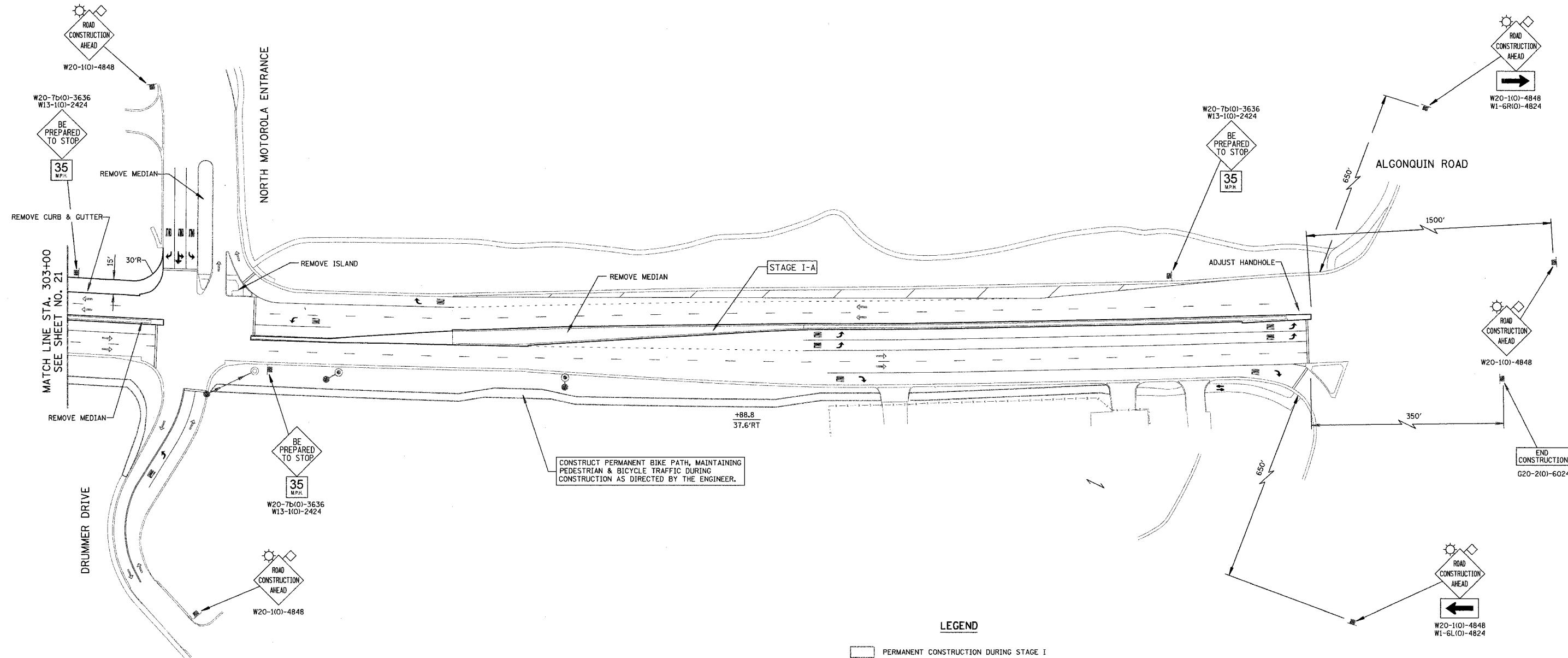
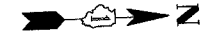

NOTE: SEE SHEET 37 FOR TYPICAL SECTIONS, GENERAL NOTES & CONSTRUCTION SEQUENCE.

CONSTRUCT TEMPORARY PAVEMENT USING TEMPORARY DAYTIME LANE CLOSURES WITH FLAGGERS (REF. STANDARD 701421).

NEW & RELOCATED SIGNS SHALL BE PLACED 3.5 FEET FROM THE EDGE OF TEMPORARY PAVEMENT OR BACK OF CURB.

ALL PAVEMENT MARKINGS SHOWN ARE EXISTING.

- LEGEND**
- PERMANENT CONSTRUCTION DURING STAGE I
 - *TEMPORARY PAVEMENT CONSTRUCTED DURING STAGE I
 - STORM SEWERS INSTALLED DURING STAGE I
 - DIRECTION OF SINGLE LANE OF VEHICULAR TRAFFIC DURING STAGE I
 - PATH OPEN TO PEDESTRIAN & BICYCLE TRAFFIC DURING STAGE I
 - TEMPORARY TRAFFIC SIGN (TYPE & LEGEND AS SHOWN)
- *BITUMINOUS BASE COURSE, SUPERPAVE 8" WITH NO BINDER OR SURFACE COURSE

REVISIONS	
NAME	DATE

ILLINOIS DEPARTMENT OF TRANSPORTATION
MEACHAM ROAD
 SUGGESTED CONSTRUCTION PROCEDURE
 & MAINTENANCE OF TRAFFIC
 STATION 303+00 TO ALGONQUIN ROAD
 STAGE I

50 0 50
 SCALE IN FEET

DATE 12/20/04

DESIGNED BY RJK
 CHECKED BY RRM