

F.A.U. RTE.	SECTION	COUNTY	TOTAL SHEETS	SHEET NO.
2585	00-00068-01-WR	COOK	145	24
STA.		TO STA.		
FED. ROAD DIST. NO.		ILLINOIS	FED. AID PROJECT	
CONTRACT NUMBER 83785				

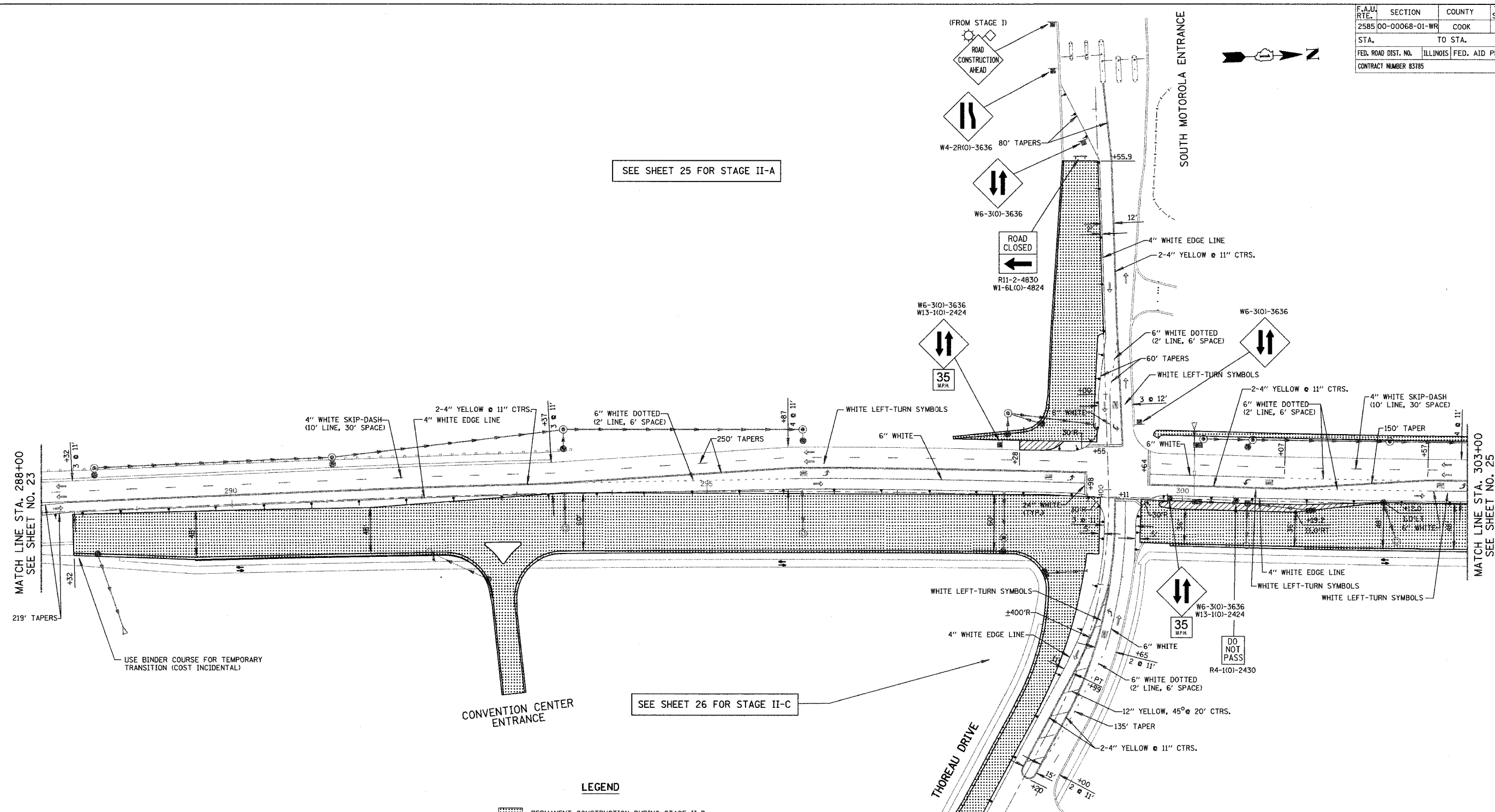

SEE SHEET 25 FOR STAGE II-A

SEE SHEET 26 FOR STAGE II-C

MATCH LINE STA. 288+00
SEE SHEET NO. 23

MATCH LINE STA. 303+00
SEE SHEET NO. 25

LEGEND

- PERMANENT CONSTRUCTION DURING STAGE II-B
 - *TEMPORARY PAVEMENT CONSTRUCTED DURING STAGE II-B
 - STORM SEWERS INSTALLED DURING STAGE II-B
 - DIRECTION OF SINGLE LANE OF VEHICULAR TRAFFIC DURING STAGE II-B
 - PATH OPEN TO PEDESTRIAN & BICYCLE TRAFFIC DURING STAGE II-B
 - TYPE II BARRICADES WITH MONO-DIRECTIONAL STEADY-BURN LIGHTS @ 50' CTRS. (25' SPACING IN TAPERS & CURVES)
 - TYPE III BARRICADE
 - TEMPORARY TRAFFIC SIGN (TYPE & LEGEND AS SHOWN)
- *BITUMINOUS BASE COURSE, SUPERPAVE 8" WITH NO BINDER OR SURFACE COURSE

NOTE: SEE SHEET 37 FOR TYPICAL SECTIONS, GENERAL NOTES & CONSTRUCTION SEQUENCE.

NEW & RELOCATED SIGNS SHALL BE PLACED 3.5 FEET FROM THE BACK OF CURB OR EDGE LINE.

ALL PROPOSED PAVEMENT MARKINGS ON THIS SHEET SHALL BE "TEMPORARY PAVEMENT MARKINGS" IN ACCORDANCE WITH ARTICLE 703.05 OF THE "STANDARD SPECIFICATIONS".

THE REMOVAL OF TEMPORARY PAVEMENT AFTER IT HAS SERVED ITS USEFUL PURPOSE WILL BE PAID FOR AS "BITUMINOUS PAVEMENT REMOVAL".

USE BINDER COURSE FOR TEMPORARY TRANSITION (COST INCIDENTAL)

REVISIONS	
NAME	DATE

ILLINOIS DEPARTMENT OF TRANSPORTATION
MEACHAM ROAD
SUGGESTED CONSTRUCTION PROCEDURE
& MAINTENANCE OF TRAFFIC
STATION 288+00 TO STATION 303+00
STAGE II-B

50 0 50
SCALE IN FEET

DATE 12/20/04

DESIGNED BY RJK
CHECKED BY RRM