

F.A.U. RTE.	SECTION	COUNTY	TOTAL SHEETS	SHEET NO.
2585	00-00068-01-WR	COOK	145	39
STA. 302+00		TO STA. 315+17		
FED. ROAD DIST. NO.	ILLINOIS	FED. AID PROJECT		
CONTRACT NUMBER 83785				

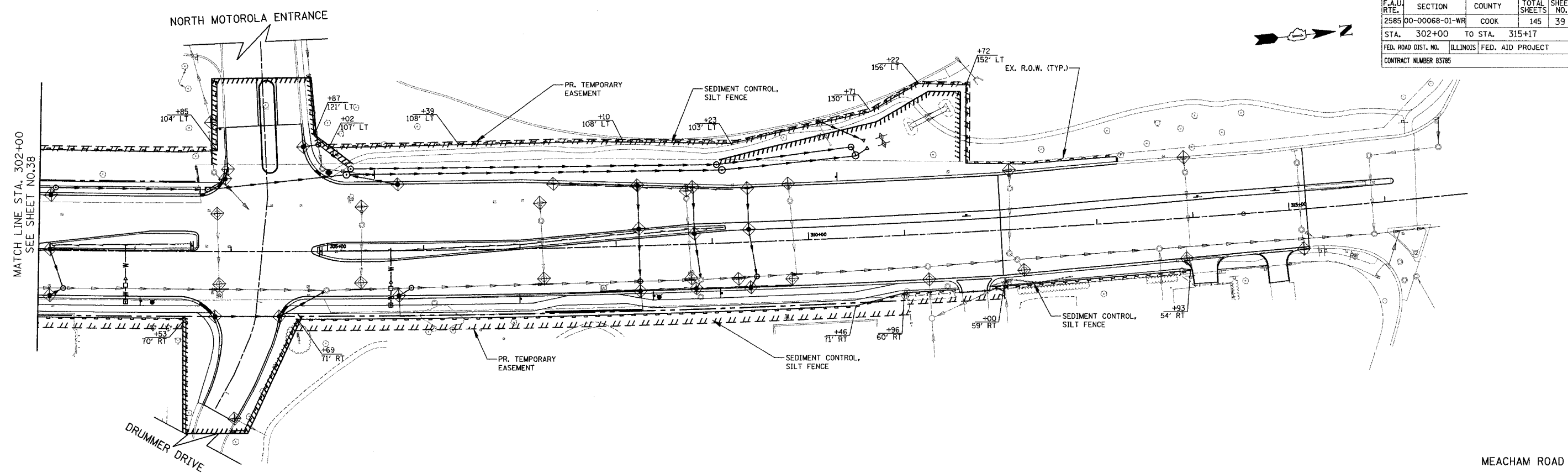

MEACHAM ROAD

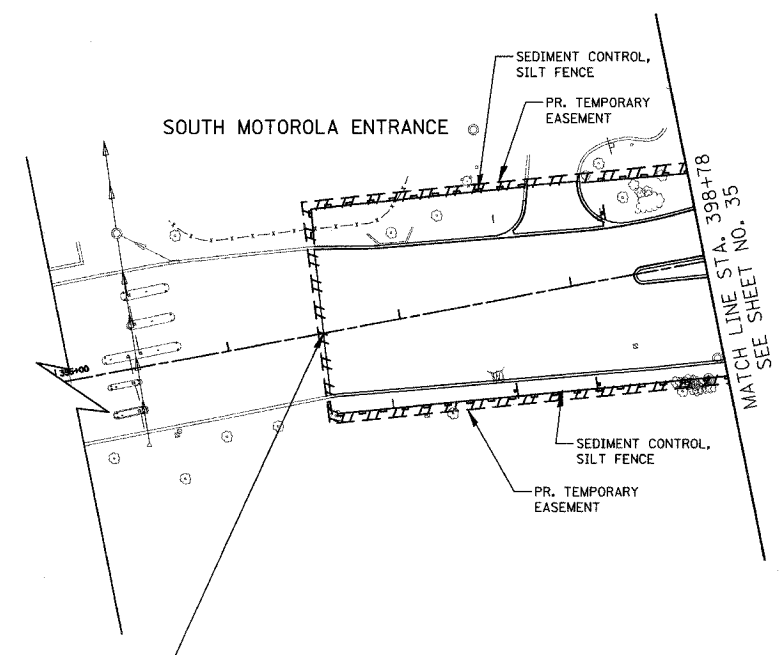

END RECONSTRUCTION IMPROVEMENTS STA. 396+55

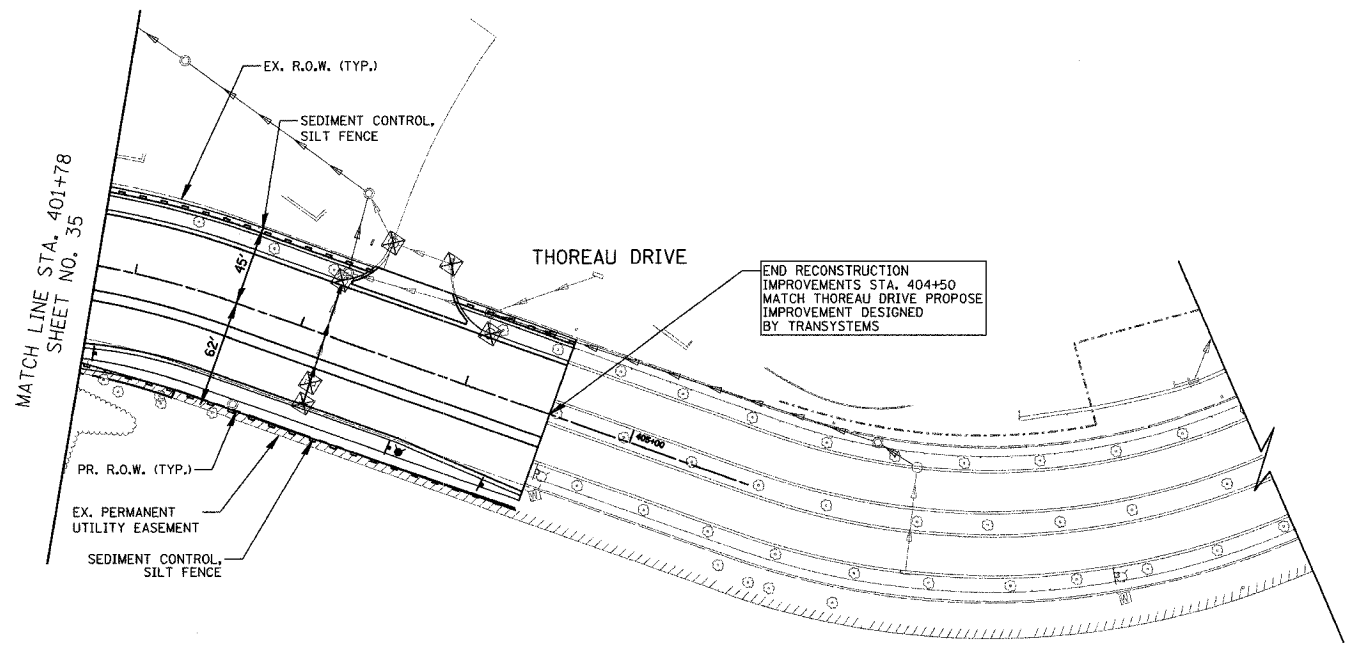

SOUTH MOTOROLA ENTRANCE/THOREAU DRIVE

REVISIONS	
NAME	DATE

ILLINOIS DEPARTMENT OF TRANSPORTATION
 SIDE STREET
 SEDIMENT AND EROSION CONTROL PLANS
 STATION 302+00 TO STATION 315+17
 STATION 395+00 TO STATION 398+78
 STATION 401+78 TO STATION 405+00
 50 0 50
 SCALE IN FEET
 DATE 12/20/04
 DESIGNED BY KKY
 CHECKED BY RRM