

F.A.U. RTE.	SECTION	COUNTY	TOTAL SHEETS	SHEET NO.
2585	00-00068-01-WR	COOK	145	53
STA. 296+85		TO STA. 301+30		
FED. ROAD DIST. NO.	ILLINOIS FED. AID PROJECT			
CONTRACT NUMBER 83785				

SOUTH MOTOROLA ENTRANCE

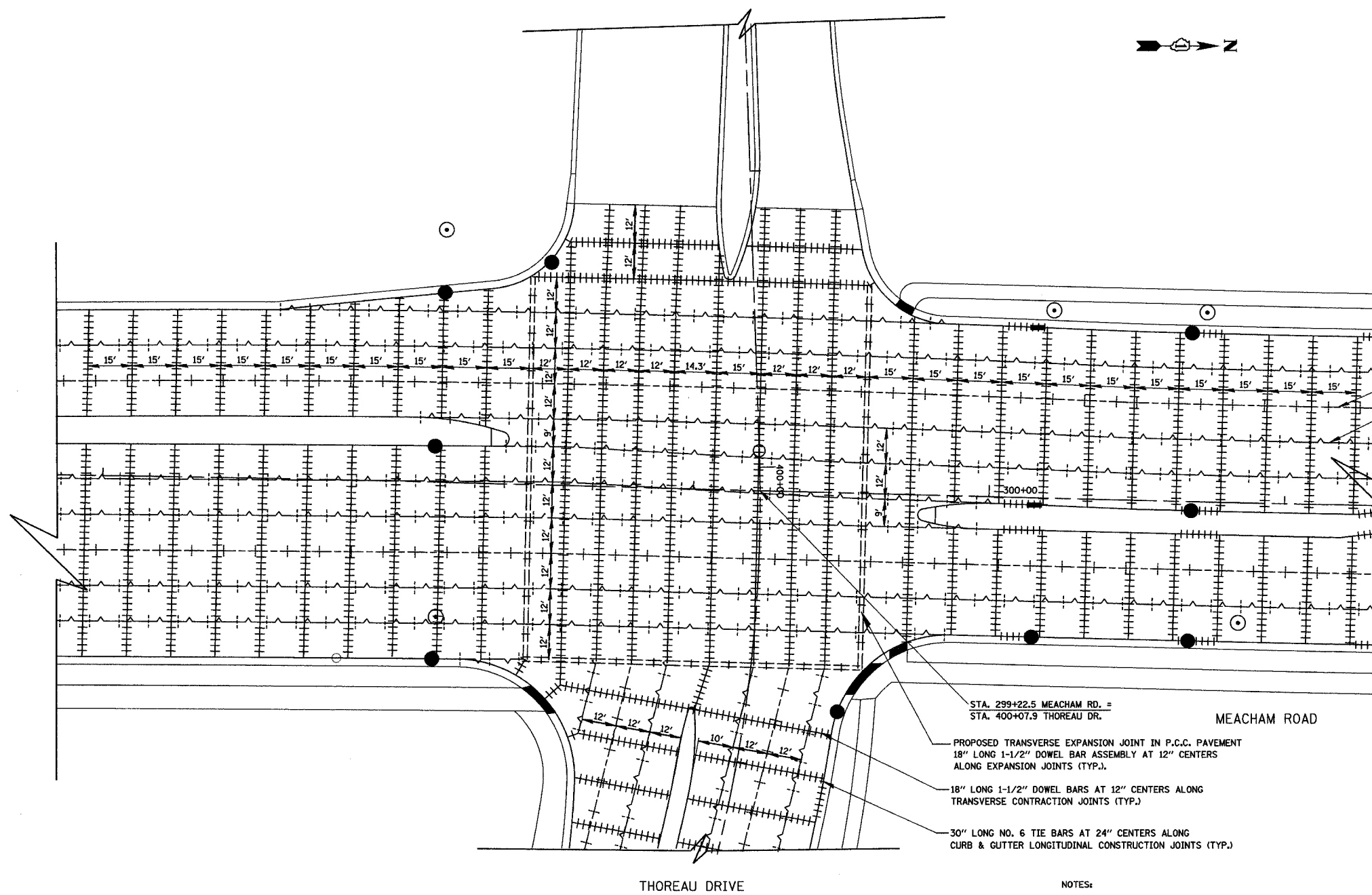

- 30" LONG NO. 6 TIE BARS AT 30" CENTERS ALONG LONGITUDINAL SAWED JOINTS (TYP.)
- 30" LONG NO. 6 TIE BARS AT 24" CENTERS ALONG KEYED LONGITUDINAL CONSTRUCTION JOINTS (TYP.)
- 30" LONG NO. 6 TIE BARS AT 24" CENTERS ALONG MEDIAN LONGITUDINAL CONSTRUCTION JOINTS (TYP.)

- STA. 299+22.5 MEACHAM RD. = STA. 400+07.9 THOREAU DR.
- MEACHAM ROAD
- PROPOSED TRANSVERSE EXPANSION JOINT IN P.C.C. PAVEMENT 18" LONG 1-1/2" DOWEL BAR ASSEMBLY AT 12" CENTERS ALONG EXPANSION JOINTS (TYP.).
- 18" LONG 1-1/2" DOWEL BARS AT 12" CENTERS ALONG TRANSVERSE CONTRACTION JOINTS (TYP.)
- 30" LONG NO. 6 TIE BARS AT 24" CENTERS ALONG CURB & GUTTER LONGITUDINAL CONSTRUCTION JOINTS (TYP.)

LEGEND

- +--- LONGITUDINAL SAWED JOINT WITH TIE BARS
- +--- LONGITUDINAL CONSTRUCTION JOINT WITH TIE BARS
- ||||| TRANSVERSE CONTRACTION JOINT WITH DOWEL BARS
- ==||== EXPANSION JOINT WITH DOWEL BARS
- ▬ DEPRESSED CURB
- ○ UTILITY STRUCTURES

NOTES:

1. TRANSVERSE DOWELED JOINTS SHALL BE SPACED AT 15' O.C. (MAX.) IN THE PORTLAND CEMENT CONCRETE PAVEMENT, 10" (JOINTED) UNLESS OTHERWISE NOTED. JOINT LAYOUT MAY BE MODIFIED UPON APPROVAL BY THE ENGINEER TO INCORPORATE CHANGES DURING CONSTRUCTION.
2. REINFORCING STEEL IS NOT SHOWN ALONG EVERY JOINT BUT IS INTENDED TO BE PLACED ALONG EACH JOINT AS NOTED.
3. REFERENCE IDOT STANDARD DETAILS 420001, 420101 & 420111
4. SEE SHEET 52 FOR GRADE ELEVATIONS

REVISIONS	
NAME	DATE

ILLINOIS DEPARTMENT OF TRANSPORTATION  
MEACHAM ROAD/THOREAU DRIVE  
INTERSECTION JOINTING PLANS

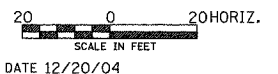

DESIGNED BY KRY  
CHECKED BY RRM

DATE 12/20/04