

F.A.U. RTE.	SECTION	COUNTY	TOTAL SHEETS	SHEET NO.
2585	00-00068-01-WR	COOK	145	104
STA. 273+00		TO STA. 279+00		
FED. ROAD DIST. NO.	ILLINOIS	FED. AID PROJECT		

CONTRACT NO. 83785

LEGEND

- ⊖ - EXISTING LIGHT POLE, SIZE AND TYPE AS NOTED
- ⊖ - INSTALL LIGHT POLE, 45' M.H. AND LUMINAIRE, 400W UNLESS OTHERWISE NOTED
- ⊖ - INSTALL LIGHT POLE, 35' M.H. AND LUMINAIRE, 150W
- UD4C UNIT DUCT WITH 3-1/C NO. 4 AND 1/C NO. 6 GROUND, 600V (XLP-TYPE USE) 1 1/4" POLYETHYLENE
- UD6C UNIT DUCT WITH 5-1/C NO. 4 AND 1/C NO. 6 GROUND, 600V (XLP-TYPE USE) 1 1/2" POLYETHYLENE
- 3"-10' GALVANIZED STEEL CONDUIT, PUSHED, DIAMETER AND LENGTH AS NOTED
- ▣ INSTALL LIGHTING CONTROLLER, 100 AMP, 240/480 VOLT
- ▣ EXISTING LIGHTING CONTROLLER, 100 AMP, 240/480 VOLT
- ▣ INSTALL HANDHOLE
- F INSTALL OFFSET FOUNDATION SEE SHEET 115

NOTE

1. POLES SHOULD BE OFFSET 7.0' FROM EDGE OF PAVEMENT, UNLESS OTHERWISE NOTED

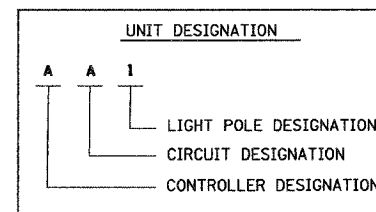

NO UNDERGROUND SPLICING ALLOWED

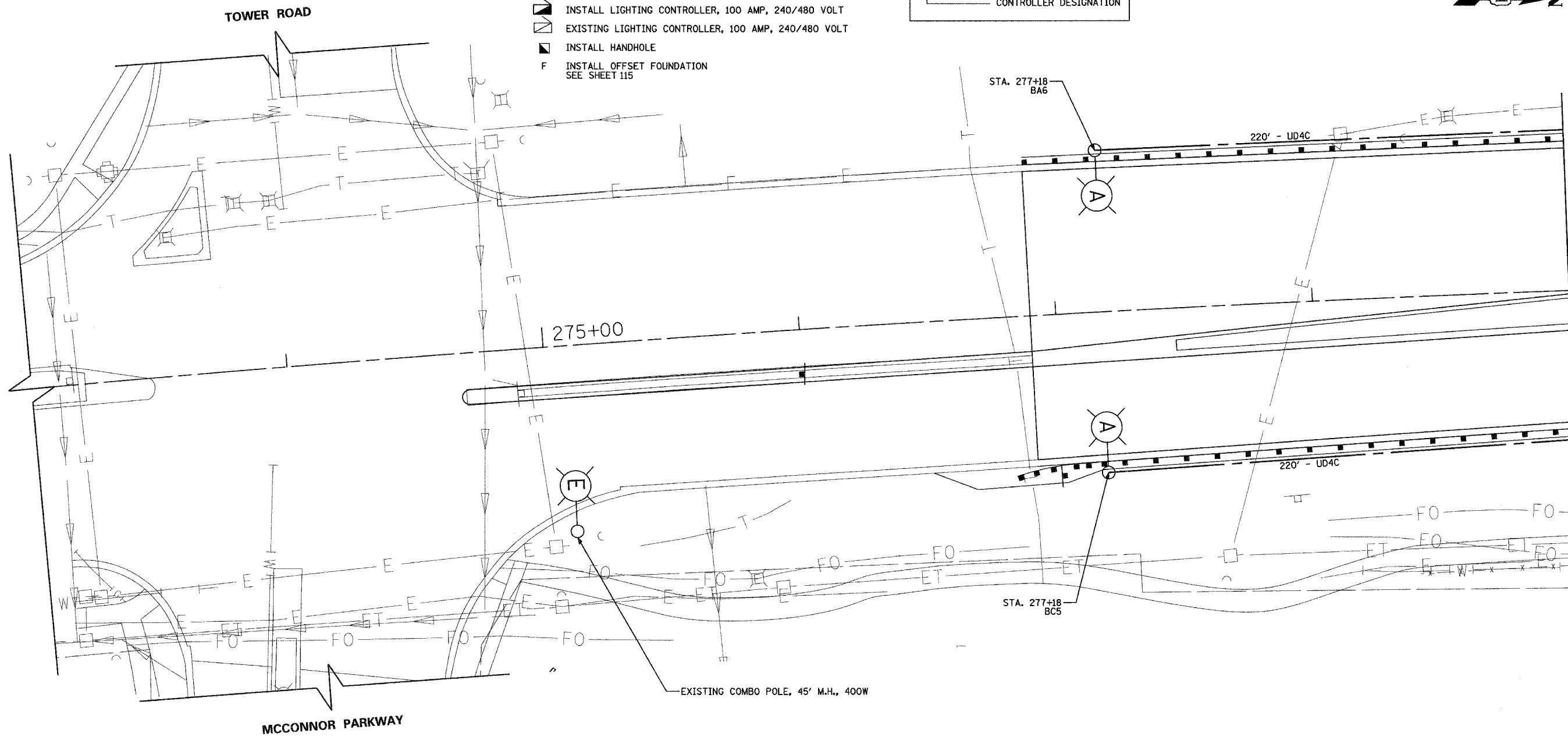

MATCH LINE STA. 279+00
SEE SHEET NO. 105

MEACHAM ROAD

ILLINOIS DEPARTMENT OF TRANSPORTATION
VILLAGE OF SCHAUMBURG
MEACHAM ROAD
LIGHTING IMPROVEMENTS
POLE INSTALLATION PLAN
STA. 273+00 TO STA. 279+00

SCALE: 1"=20'
DATE: DECEMBER 2004
DRAWN BY: KDM
CHECKED BY: JMV

REVISIONS	
NAME	DATE

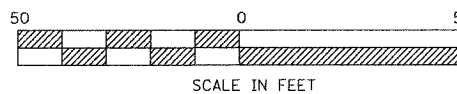

m:\proj\3266\design\lighting\3266-plan\01.dgn