

FILL AT BOTH ABUTMENTS

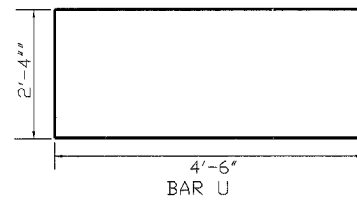

NOTE: FIELD NOTCH SHEET PILING TO ACCOMMODATE S-1 BARS

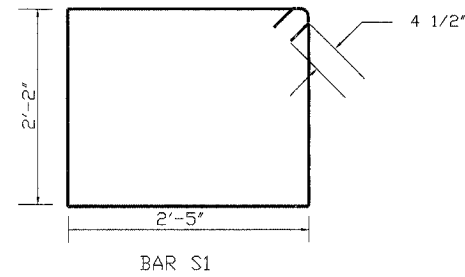
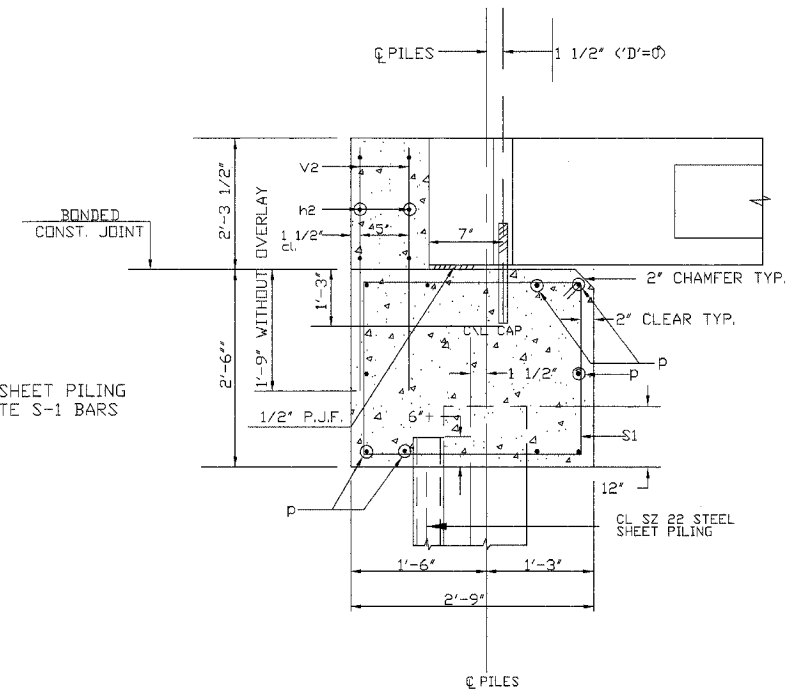

SECTION THROUGH BOTH ABUTMENTS

BILL OF MATERIALS FOR ONE ABUTMENT

BAR	NO.	SIZE	LENGTH	SHAPE	WEIGHT
H ₂	6	#4	28'-10"	————	115.6 lb
P	10	#5	28'-10"	————	300.7 lb
S1	30	#4	9'-11"		198.8
U	8	#6	11'-4"		136.2
V ₂	58	#4	3'-10"	————	136.6
REINFORCEMENT BARS					887.9 lb
CONCRETE STRUCTURES					10.3 CU. YD.

ABUTMENT DETAILS

SEC. 03-00284-00-BR

BUILT 2005, LEE COUNTY

STA. 10+00, THREE MILE BRANCH