

RTE.	SECTION	COUNTY	TOTAL SHEETS	SHEET NO.
FAI 80	(50-2)HDR	LA SALLE	460	42
STA. 663+50		TO STA. 676+50		
FED. ROAD DIST. NO.		ILLINOIS	FED. AID PROJECT	

CONTRACT NO. 86603

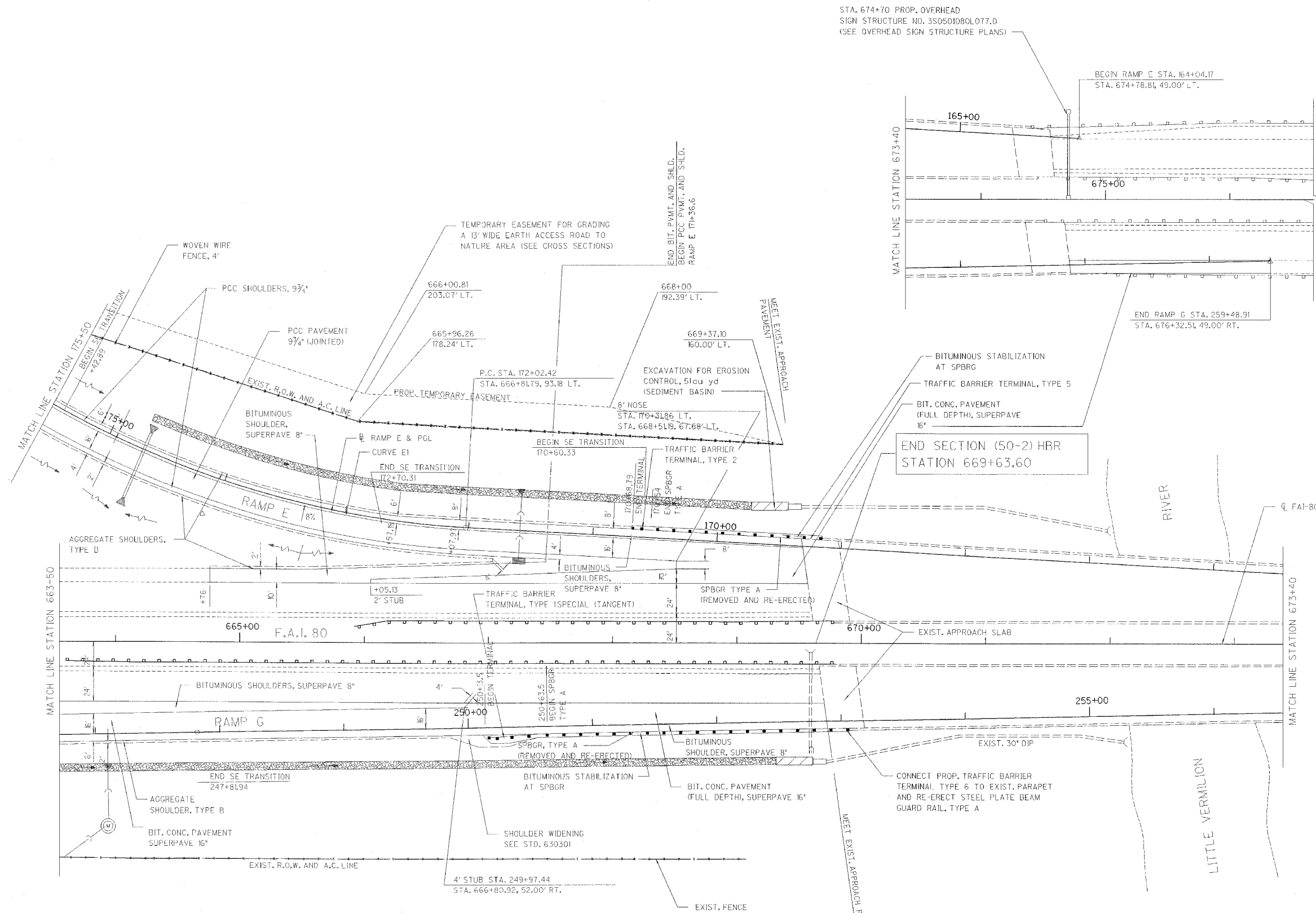

REVISIONS NAME	DATE

ILLINOIS DEPARTMENT OF TRANSPORTATION

**ROADWAY PLAN**

F.A.I. 80 AT ILLINOIS ROUTE 351  
STATION 663+50 TO STATION 676+50

DATE: 09/04  
DRAWN BY: JJK  
CHECKED BY: MTD

SCALE IN FEET: 0 40 80