

RTE.	SECTION	COUNTY	TOTAL SHEETS	SHEET NO.
FAI 80	(50-2)HBR	LA SALLE	460	57
STA. 653+75	TO STA. 663+50			
FED. ROAD DIST. NO.	ILLINOIS	FED. AID PROJECT		

CONTRACT NO. 86603

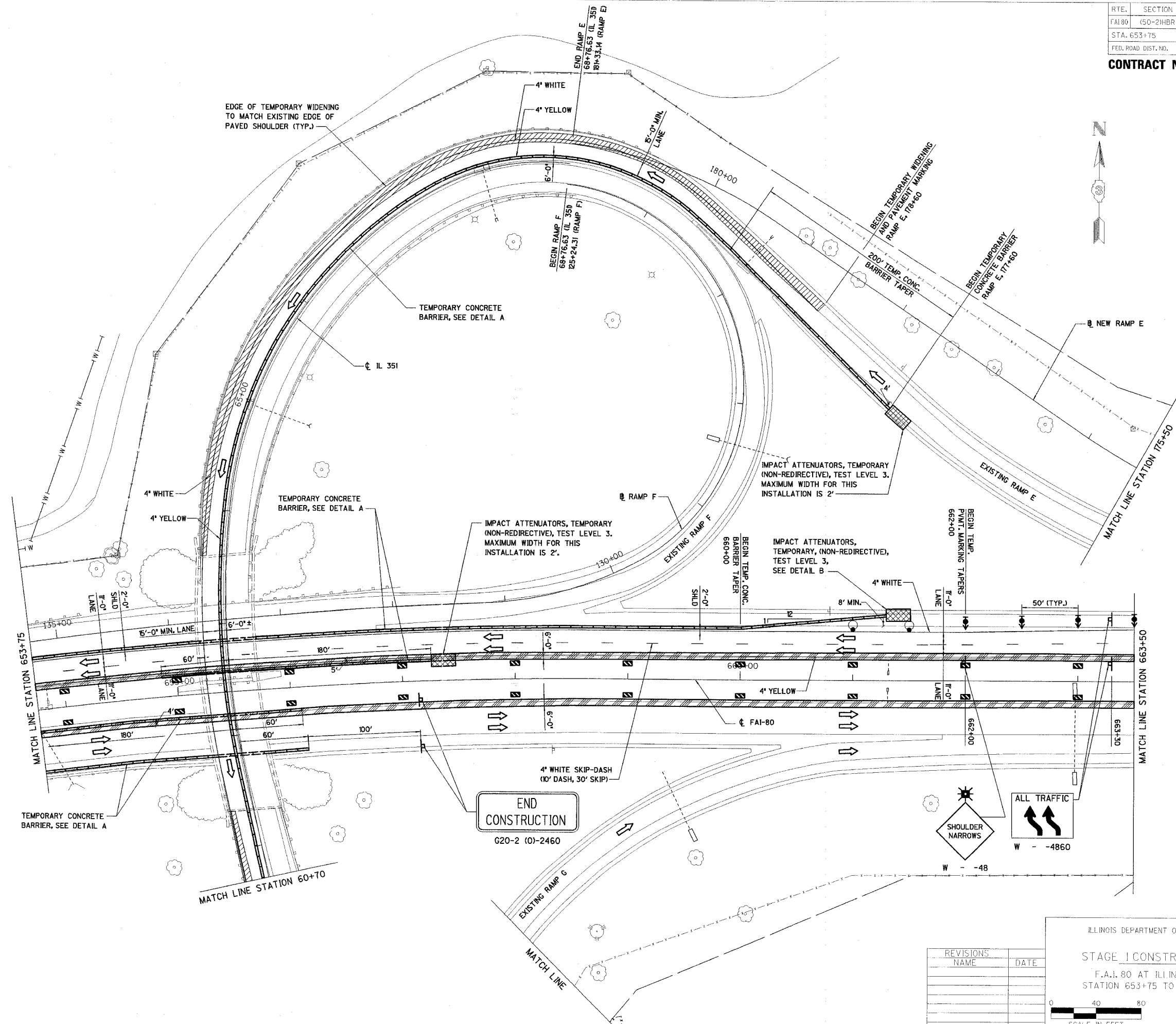

END CONSTRUCTION
G20-2 (O)-2460

REVISIONS	NAME	DATE

ILLINOIS DEPARTMENT OF TRANSPORTATION
STAGE I CONSTRUCTION PLAN
 F.A.I. 80 AT ILLINOIS ROUTE 351
 STATION 653+75 TO STATION 663+50
 DATE: 09/04
 DRAWN BY: MES
 CHECKED BY: MTD

