

RTE.	SECTION	COUNTY	TOTAL SHEETS	SHEET NO.
FAI 80	(50-2)HBR	LA SALLE	460	70
STA. 52+95		TO STA. 60+70		
FED. ROAD DIST. NO.	ILLINOIS	FED. AID PROJECT		

**CONTRACT NO. 86603**

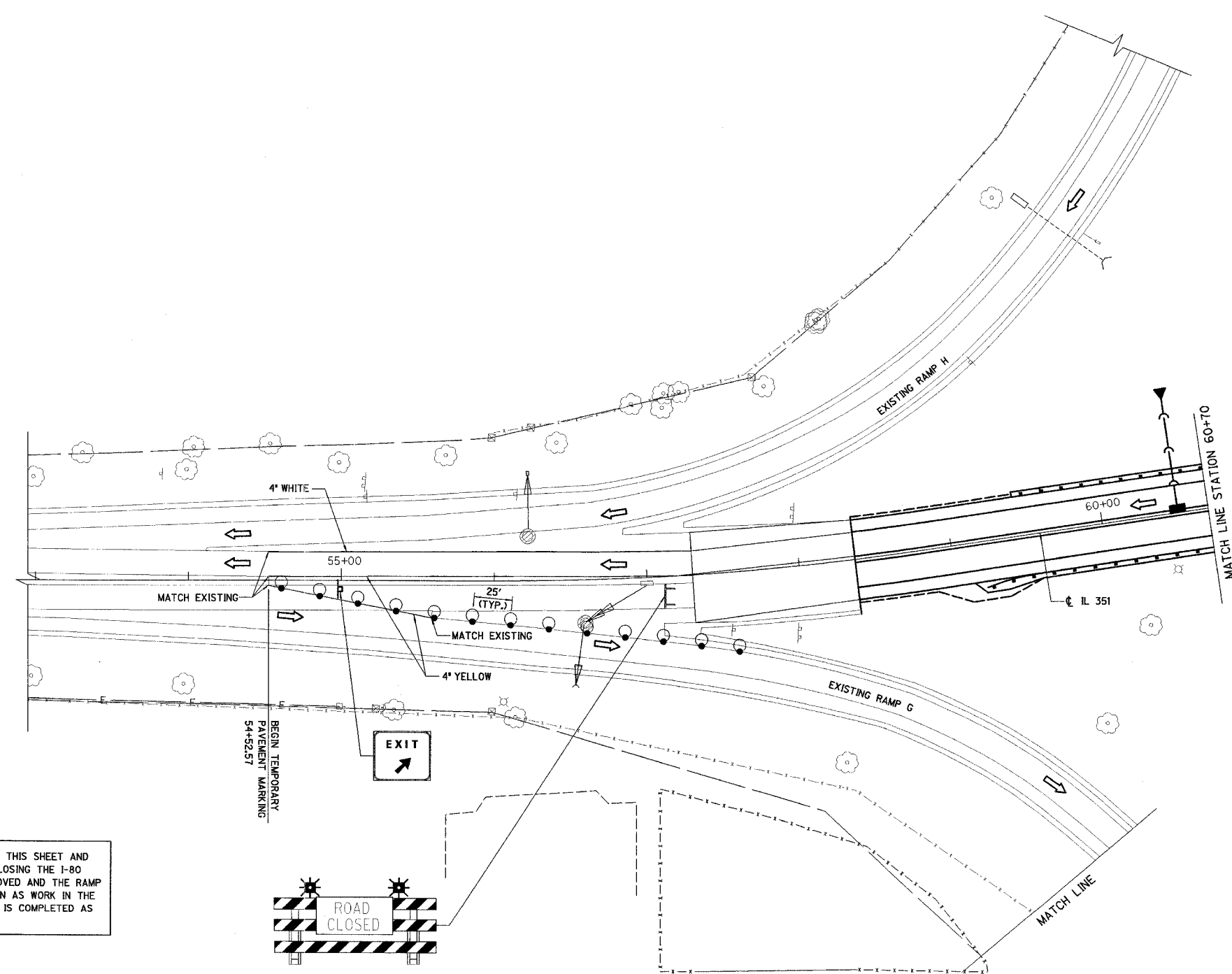

TRAFFIC CONTROL SHOWN ON THIS SHEET AND ELSEWHERE IN THE PLANS CLOSING THE I-80 WB ON-RAMP SHALL BE REMOVED AND THE RAMP OPENED TO TRAFFIC AS SOON AS WORK IN THE RAMP E/RAMP F GORE AREA IS COMPLETED AS DIRECTED BY THE ENGINEER.



REVISIONS NAME	DATE

ILLINOIS DEPARTMENT OF TRANSPORTATION

**STAGE III B CONSTRUCTION PLAN**

F.A.I. 80 AT ILLINOIS ROUTE 351  
STATION 52+95 TO STATION 60+70

DATE: 09/04  
DRAWN BY: MFS  
CHECKED BY: MTD

0 40 80  
SCALE IN FEET