

RTE.	SECTION	COUNTY	TOTAL SHEETS	SHEET NO.
FAI 80	150-21HBR	LA SALLE	460	75
STA. 63H+20	TO STA. 643+00			
FED. ROAD DIST. NO.	ILLINOIS	FED. AID PROJECT		

CONTRACT NO. 86603

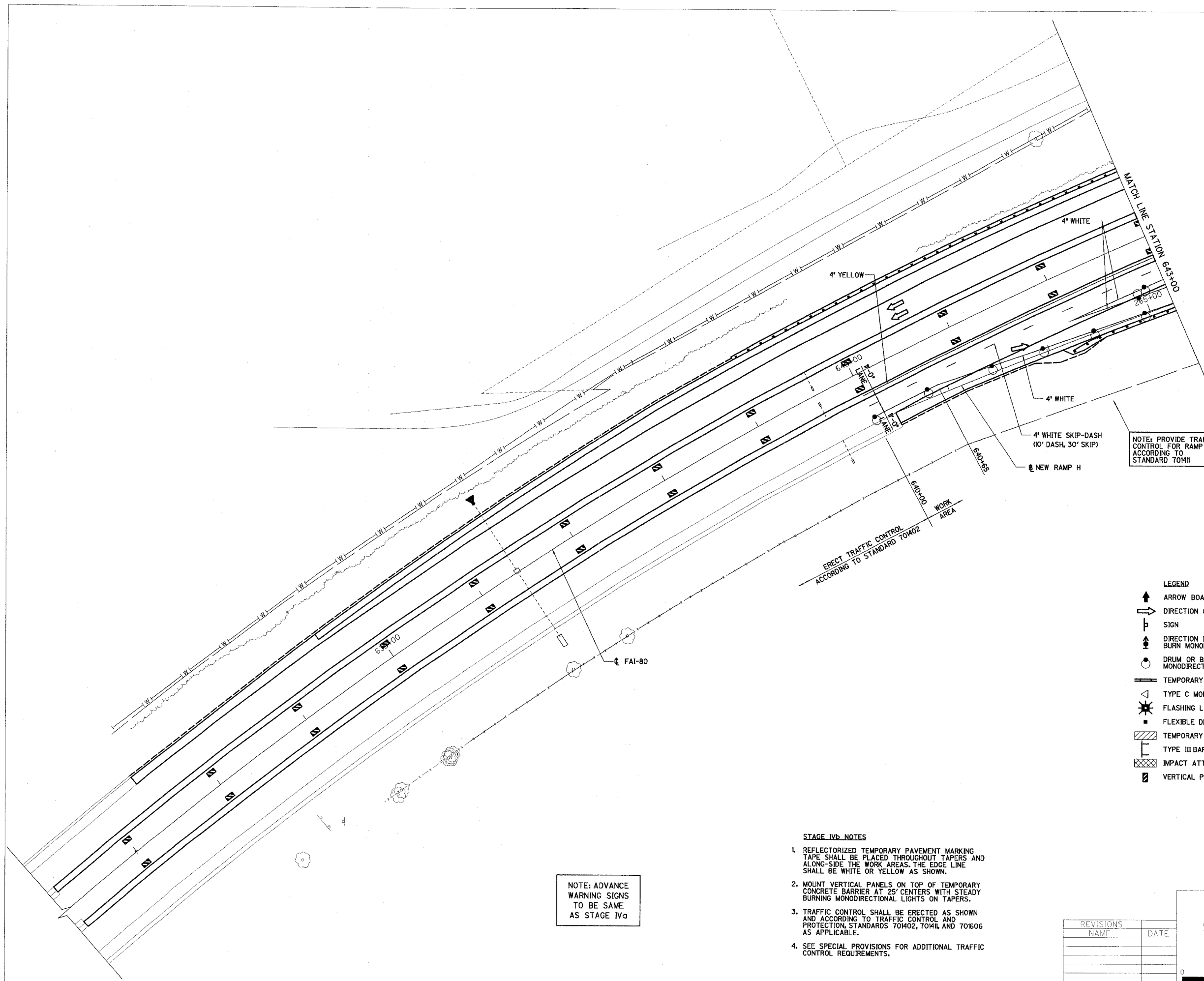
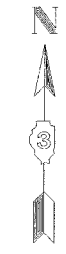

NOTE: PROVIDE TRAFFIC CONTROL FOR RAMP ACCORDING TO STANDARD 70411

NOTE: ADVANCE WARNING SIGNS TO BE SAME AS STAGE IVa

STAGE IVb NOTES

1. REFLECTORIZED TEMPORARY PAVEMENT MARKING TAPE SHALL BE PLACED THROUGHOUT TAPERS AND ALONG-SIDE THE WORK AREAS. THE EDGE LINE SHALL BE WHITE OR YELLOW AS SHOWN.
2. MOUNT VERTICAL PANELS ON TOP OF TEMPORARY CONCRETE BARRIER AT 25' CENTERS WITH STEADY BURNING MONODIRECTIONAL LIGHTS ON TAPERS.
3. TRAFFIC CONTROL SHALL BE ERECTED AS SHOWN AND ACCORDING TO TRAFFIC CONTROL AND PROTECTION, STANDARDS 70402, 70411, AND 70606 AS APPLICABLE.
4. SEE SPECIAL PROVISIONS FOR ADDITIONAL TRAFFIC CONTROL REQUIREMENTS.

LEGEND

- ARROW BOARD
- DIRECTION OF TRAFFIC
- SIGN
- DIRECTION INDICATOR BARRICADE WITH STEADY BURN MONODIRECTIONAL LIGHT
- DRUM OR BARRICADE WITH STEADY BURN MONODIRECTIONAL LIGHT
- TEMPORARY CONCRETE BARRIER
- TYPE C MONODIRECTIONAL REFLECTOR
- FLASHING LIGHT
- FLEXIBLE DELINEATOR
- TEMPORARY WIDENING
- TYPE III BARRICADE
- IMPACT ATTENUATORS
- VERTICAL PANEL

REVISIONS	NAME	DATE

ILLINOIS DEPARTMENT OF TRANSPORTATION

STAGE IVb CONSTRUCTION PLAN

F.A.I. 80 AT ILLINOIS ROUTE 351
STATION 63H+20 TO STATION 643+00

DATE: 09/04
DRAWN BY: MES
CHECKED BY: MTD

0 40 80
SCALE IN FEET