

ROUTE NO.	SECTION	COUNTY	TOTAL SHEETS	SHEET NO.
FA.I. 80 (50-2)HR	LA SALLE	460	198	
STA 142+00		TO STA 144+00		
FED. ROAD DIST. NO. 3	ILLINOIS	FED. AID PROJECT:		

CONTRACT NO. 86603

RAMP F

DATE	BY
DESIGNED	PLOTTED
SURVEY	TEMPLATE
NOTE BOOK	AREAS CHECKED
NO.	

DATE	BY
DESIGNED	PLOTTED
SURVEY	TEMPLATE
NOTE BOOK	AREAS CHECKED
NO.	

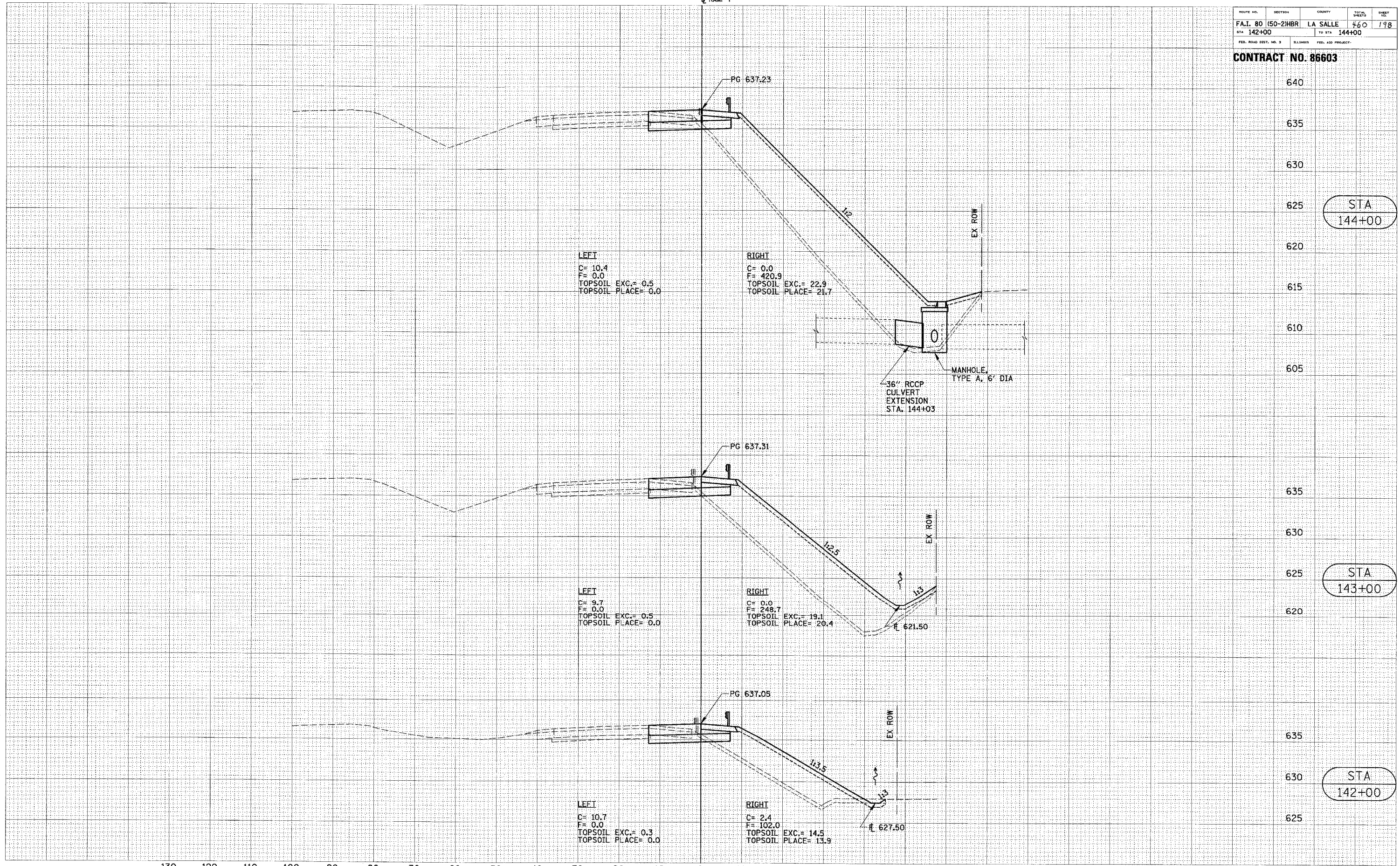

130 120 110 100 90 80 70 60 50 40 30 20 10 0 10 20 30 40 50 60 70 80 90 100 110

CROSS SECTIONS (RAMP F)

STA 144+00

STA 143+00

STA 142+00

640  
635  
630  
625  
620  
615  
610  
605  
635  
630  
625  
620  
635  
630  
625  
620