

STATE OF ILLINOIS  
DEPARTMENT OF TRANSPORTATION  
DIVISION OF HIGHWAYS  
**PLANS FOR PROPOSED  
FEDERAL AID HIGHWAY**  
MAJOR BRIDGE PROGRAM  
FAS RTE 259 (C.H. 3)  
OVER THE FOX RIVER  
SECTION 98-00545-00-BR  
PROJECT NO. BRS-259(108)  
LA SALLE COUNTY  
C-93-063-02

98-00545-00-BR

ROUTE NO.	SECTION	COUNTY	TOTAL SHEETS	SHEET NO.
FAS 259		LA SALLE	79+3	1
FED. ROAD DIST. NO. 7		ILLINOIS	FED. AID PROJECT	

CONTRACT NO. 87240

INDEX OF SHEETS

- 1 COVER SHEET
- 2 GENERAL NOTES
- 3-4 SUMMARY OF QUANTITIES
- 5 TYPICAL SECTIONS
- 6-7 SCHEDULE OF QUANTITIES
- 8 SWING TIES
- 9-14 PLAN & PROFILE COUNTY HIGHWAY 3
- 15 PLAN & PROFILE N 42nd ROAD
- 16 WEST FRONTAGE ROAD
- 17-20 EROSION CONTROL PLANS
- 21-24 TRAFFIC CONTROL
- 25 INTERSECTION DETAILS
- 26-63 BRIDGE PLANS
- 64-77 CROSS SECTIONS COUNTY HIGHWAY 3
- 78-79 CROSS SECTIONS N 42nd ROAD

STANDARDS

- 000001-04 STANDARD SYMBOLS, ABBREVIATIONS AND PATTERNS
- 280001-02 TEMPORARY EROSION CONTROL SYSTEMS
- 420001-05 PAVEMENT JOINTS
- 420101-02 7.2M (24") JOINTED P.C.C. PAVEMENT
- 420401-05 BRIDGE APPROACH PAVEMENT
- 483001-01 PCC SHOULDER
- 515001-02 NAME PLATE FOR BRIDGES
- 542301 PRECAST REINFORCED CONCRETE FLARED END SECTION
- 542401 METAL END SECTION FOR PIPE CULVERTS
- 601101 CONCRETE HEADWALLS FOR PIPE DRAINS
- 602301 INLET, TYPE A
- 602306 INLET, TYPE B
- 602401 MANHOLE, TYPE A
- 602601 PRECAST REINFORCED CONCRETE FLAT SLAB TOP
- 602701 CAST IRON STEPS
- 604001-02 FRAME AND LIDS, TYPE 1
- 604006-02 FRAME AND GRATE, TYPE 3
- 606001-02 CONCRETE CURB & COMBINATION CONCRETE CURB & GUTTER
- 606006 OUTLETS FOR CONC. CURB AND GUTTER TYPE B-15.60 (B-6.24)
- 609006-02 BRIDGE APPROACH PAVEMENT (DRAIN DETAIL)
- 630001-05 STEEL PLATE BEAM GUARDRAIL
- 631031-05 TRAFFIC BARRIER TERMINAL, TYPE 6
- 635006-02 REFLECTOR AND TERMINAL MARKER PLACEMENT
- 666001 RIGHT-OF-WAY MARKERS
- 667101 PERMANENT SURVEY MARKERS
- 701501-03 URBAN LANE CLOSURE 2L, 2W UNDIVIDED
- 702001-05 TRAFFIC CONTROL DEVICES
- 704001-02 TEMPORARY CONCRETE BARRIER
- 780001-01 TYPICAL PAVEMENT MARKINGS
- BLR 10-4 P.C.C. PAVEMENT SPECIAL DETAILS
- BLR 14-8 PORTLAND CEMENT CONCRETE PAVEMENT
- BLR 21-6 TYPICAL APPLICATION OF TRAFFIC CONTROL DEVICES FOR CONSTRUCTION ON RURAL LOCAL HIGHWAYS
- BLR 22-4 TYPICAL APPLICATION OF TRAFFIC CONTROL DEVICES FOR CONSTRUCTION ON RURAL LOCAL HIGHWAYS (TWO LANE -TWO WAY RURAL TRAFFIC) (ROAD CLOSED TO THRU TRAFFIC)

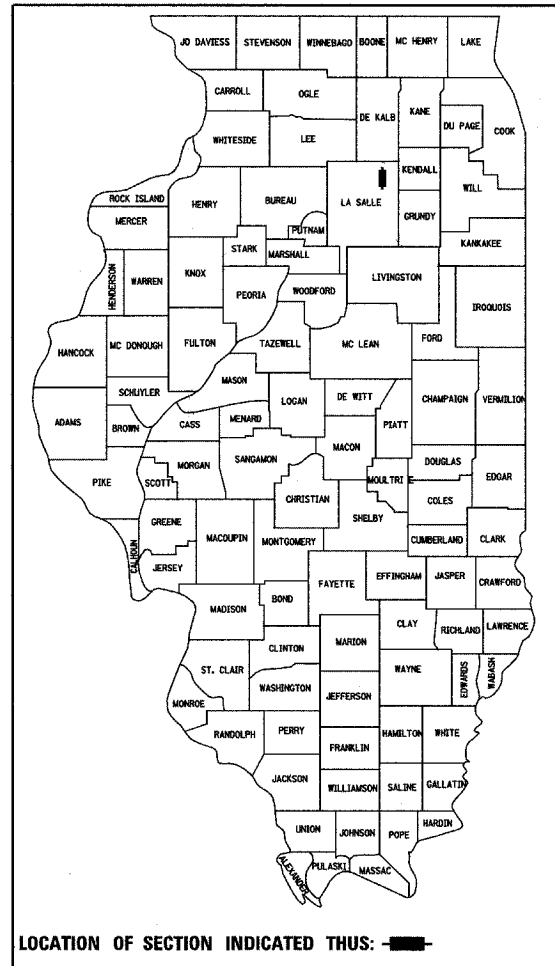

LOCATION OF SECTION INDICATED THUS: [shaded area]

FAS RTE 259 (C.H. 3)  
FUNCTIONAL CLASSIFICATION: MAJOR COLLECTOR

ADT = 2885 (2001)  
PV = 87.7%  
MU = 7.9%  
SU = 4.4%

PROJECT LOCATION  
EXIST. SN 050-3013  
PROP. SN 050-3562

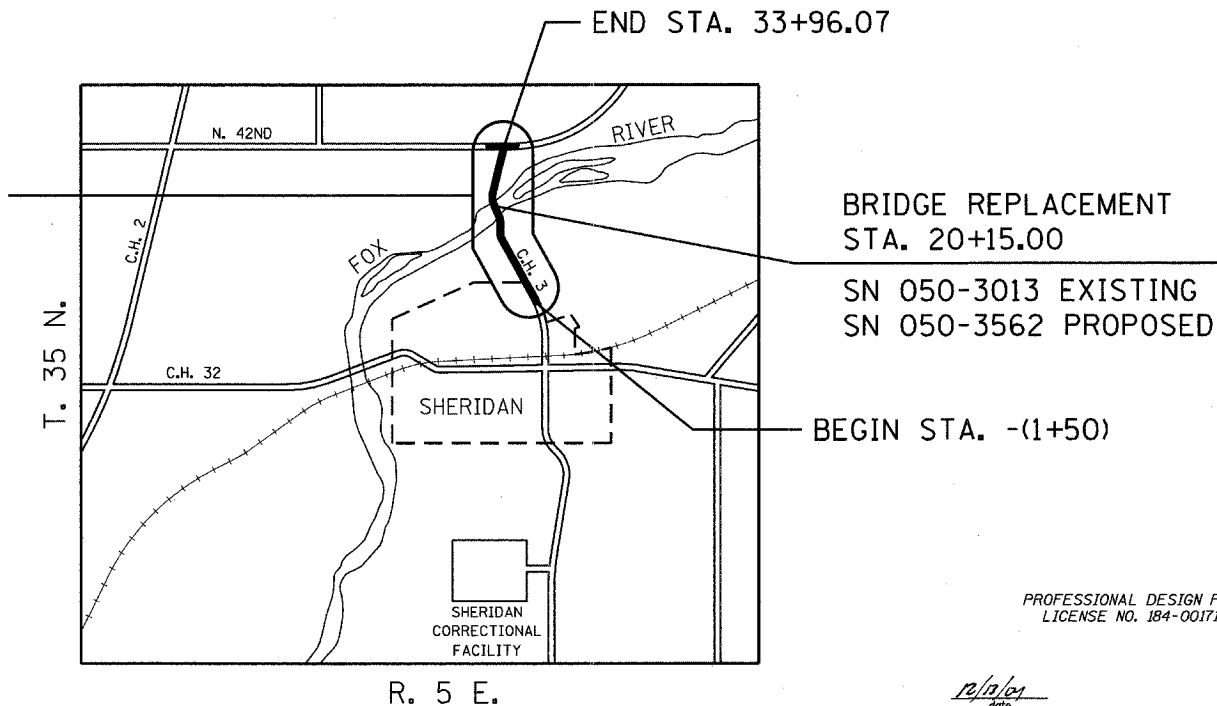

BRIDGE REPLACEMENT  
STA. 20+15.00  
SN 050-3013 EXISTING  
SN 050-3562 PROPOSED

BEGIN STA. -(1+50)

MICROFILMED \_\_\_\_\_  
REEL NUMBER \_\_\_\_\_  
AWARDED \_\_\_\_\_  
RESIDENT ENGINEER \_\_\_\_\_  
AS BUILT CHANGES WERE MADE  
ON THE FOLLOWING SHEETS \_\_\_\_\_

JULIE 1-800-892-0123

DISTRICT 3 NO. (815) 434-6131

TOWNSHIP: NORTHVILLE & MISSION

PROFESSIONAL DESIGN FIRM  
LICENSE NO. 184-001717

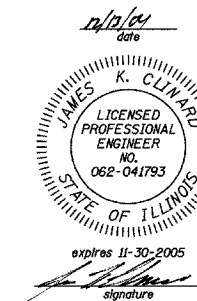
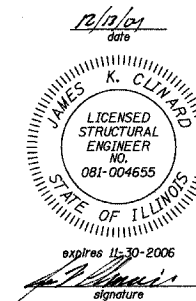

SUBMITTED 12/14/04 2004  
PASSED 12/16/04 2004  
APPROVED 12/14/04 2004  
LOCAL AGENCY  
BUREAU CHIEF OF LOCAL ROADS AND STREETS  
DISTRICT ENGINEER

NET LENGTH OF SECTION 3546.07' (0.672 miles)  
GROSS LENGTH OF SECTION 3546.07' (0.672 miles)