

PIPE CULVERTS, CLASS D, TYPE 1, 18" 50 FOOT
 US 33' LT. STA. 3+71.8 EL. 580.15
 DS 33' LT. STA. 4+25.9 EL. 579.94
 END SECTIONS 18" 2 EACH

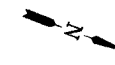

- FIELD ENTRANCE
- BITUMINOUS SURFACE REMOVAL 1 1/2" AND INCIDENTAL BITUMINOUS SURFACING

BEGIN CONSTRUCTION
 STA. -1+50.00

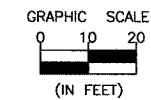
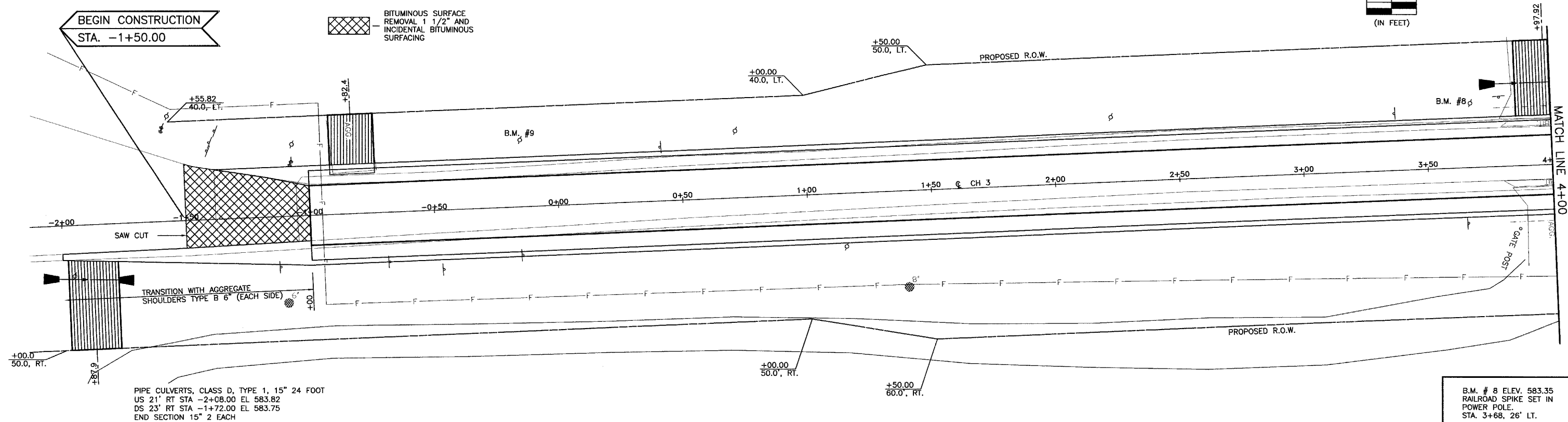

PIPE CULVERTS, CLASS D, TYPE 1, 15" 24 FOOT
 US 21' RT STA -2+08.00 EL 583.82
 DS 23' RT STA -1+72.00 EL 583.75
 END SECTION 15" 2 EACH

B.M. # 8 ELEV. 583.35
 RAILROAD SPIKE SET IN
 POWER POLE.
 STA. 3+68, 26' LT.

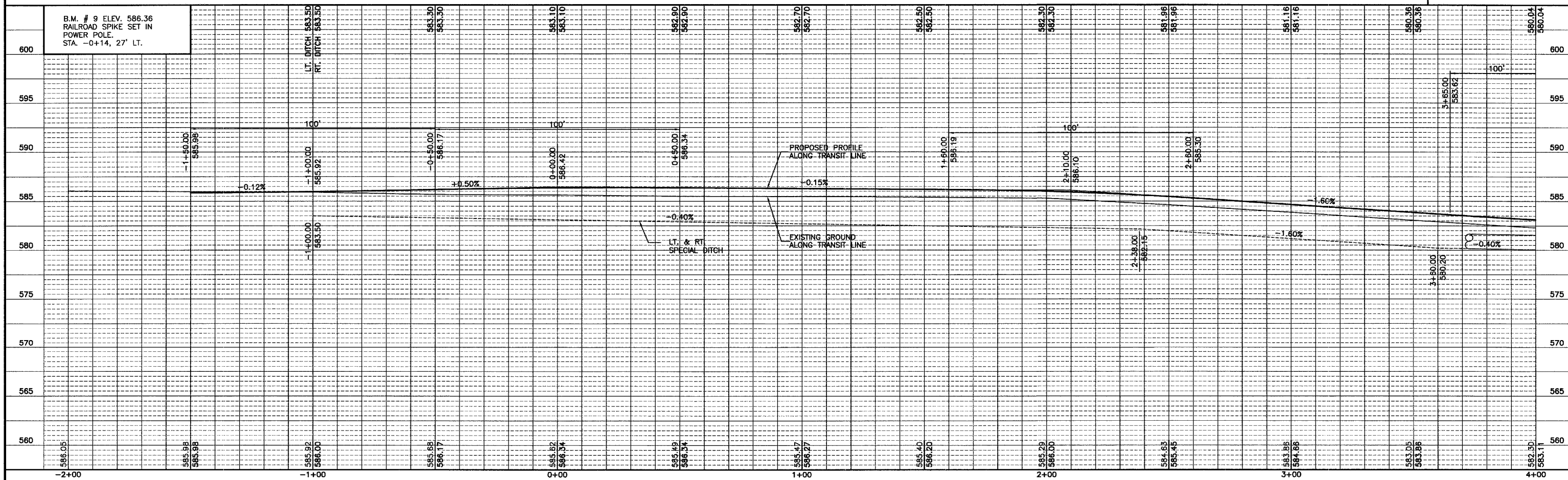

DRAWN BY: ARR
 CHECKED BY: JKC

REVISIONS	
DATE	BY
3/08/04	NET
7/01/04	NET

CHAMLIN ASSOCIATES

PERU MORRIS
 ILLINOIS

FAS 259/COUNTY HIGHWAY 3 OVER FOX RIVER
 SECTION 98-00545-00-BR
 LASALLE COUNTY

PLAN AND PROFILE
 STA. -2+00.00 TO 4+00.00

SCALE: AS NOTED
 SHEET 9
 FILE NO.: 11174.01Y-1 OF 79