

CENTERLINE CURVE DATA
 $\Delta = 25^{\circ}50'19''$
 $R = 467.72'$
 $T = 107.29'$
 $L = 210.92'$
 P.C. STA. 12+64.90
 P.I. STA. 13+72.19
 P.T. STA. 14+75.82
 $SE = 0.038\%$
 SE TRANSITION
 STA. 11+64.90 TO STA. 13+14.90
 STA. 14+29.14 TO STA. 15+69.18

B.M. # 2 ELEV. 566.74 CHISELED SQUARE SET AT THE S.E. COR. OF A CONCRETE SLAB AT THE S.E. CORNER OF TAVERN.

 B.M. # 7 ELEV. 577.43 RAILROAD SPIKE SET IN POWER POLE. STA. 11+27.23' LT.

PIPE NUMBER	①	②	③	④	⑤	⑥	⑦	PIPE NUMBER
SIZE	15"	24"	24"	12"	24"	12"	12"	SIZE
LENGTH	71.2'	2.4'	135.8'	3.5'	191.0'	7.9'	36.5'	LENGTH
CLASS	A	A	A	A	A	A	A	CLASS
TYPE	1	1	1	1	1	1	1	TYPE
% SLOPE	2.7	1.1	1.1	1.0	1.2	1.0	1.0	% SLOPE
TRENCH BACKFILL	7.3						7.9	TRENCH BACKFILL

INLET, TYPE A, TYPE 3 FRAME AND GRATE
 18" LT. STA. 16+00.0
 RIM ELEV. 566.46
 E INV. 562.79

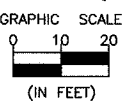

INLET, TYPE B, TYPE 3 FRAME AND GRATE
 18" RT. STA. 16+00.0
 RIM ELEV. 566.70
 W INV. 562.43
 E INV. 562.30

MANHOLE, TYPE A, 5' DIA., TYPE 1 FRAME, CLOSED LID
 32.0' RT. STA. 16+00.0
 RIM ELEV. 570.00
 W INV. 562.22
 S INV. 564.51
 N INV. 561.42

INLET, TYPE A, TYPE 3 FRAME AND GRATE
 18" RT. STA. 14+00.0
 RIM ELEV. 573.11
 E INV. 571.19

MANHOLE, TYPE A, 5' DIA., TYPE 1 FRAME, CLOSED LID
 25.65' RT. STA. 14+00.0
 RIM ELEV. 573.45
 S INV. 568.05
 W INV. 571.16
 N INV. 566.80

- FIELD ENTRANCE
- PORTLAND CEMENT CONCRETE DRIVEWAY 6"
- BITUMINOUS SURFACE REMOVAL VARIABLE DEPTH (MILL AS NECESSARY TO PROVIDE 8" THICKNESS FOR PAVEMENT)

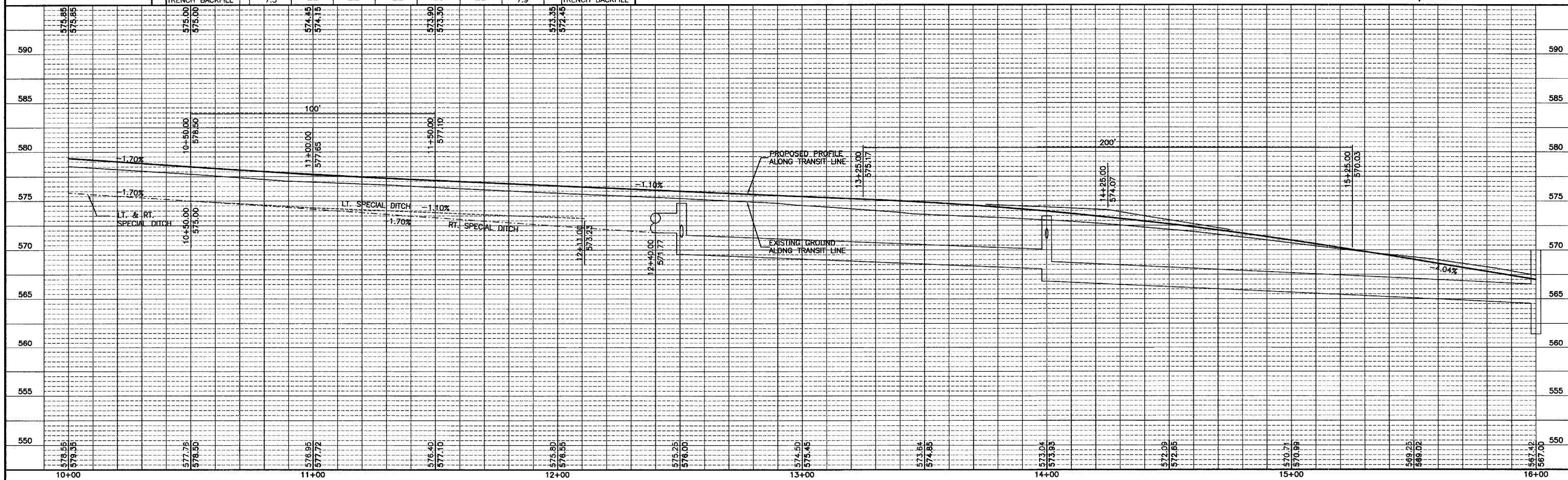

DRAWN BY: ARR
 CHECKED BY: JKC

11174-01/FINAL/
 CAD/DWG: 10-16
 XREF/FIN/PO
 DATE: 3/03

REVISIONS	
DATE	BY
3/08/04	NET
6/29/04	NET

CHAMLIN ASSOCIATES
 PERU MORRIS
 ILLINOIS

FAS 259/COUNTY HIGHWAY 3 OVER FOX RIVER
 SECTION 98-00545-00-BR
 LASALLE COUNTY

PLAN AND PROFILE
 STA. 10+00.00 TO 16+00.00

SCALE: AS NOTED
 SHEET 11
 FILE NO.: 11174.01Y-1 OF 79