

B.M. # 4 ELEV. 549.36
 CHISELED "X" ON S.W. BOLT OF
 WESTERN SAND GRAVEL SIGN AT
 ENTRANCE TO PIT.

CENTERLINE CURVE DATA

$\Delta = 2'58.51"$ (LEFT)
 R = 5000.00'
 T = 130.09'
 L = 260.13'
 P.C. STA. 498+00.00
 P.I. STA. 499+30.09
 P.T. STA. 500+60.13
 SE = NONE

PORTLAND CEMENT
 CONCRETE DRIVEWAY 8"

CENTERLINE CURVE DATA

$\Delta = 4'14.08"$ (RIGHT)
 R = 900.00'
 T = 33.28'
 L = 66.53'
 P.C. STA. 500+62.52
 P.I. STA. 500+95.80
 P.T. STA. 501+29.05
 SE = NONE

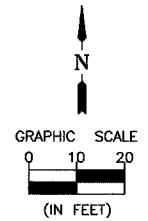

STA. 500+00.00 (N 42ND ROAD) =
 STA. 33+96.07 (CH 3)

REMOVE EXISTING CULVERT
 PIPE CULVERTS, CLASS A,
 TYPE 1 24" 36 FOOT
 US 24" RT. STA 498+87 ELEV 542.95
 DS 24" LT. STA 498+84 ELEV 543.00
 PRECAST REINFORCED CONCRETE FLARED
 END SECTION 24" 2 EACH
 TRENCH BACKFILL 4 CU YD

PIPE CULVERTS, CLASS A,
 TYPE 1 18" 110 FOOT
 US 27.5' LT STA 500+71.5 ELEV 545.50
 DS 24" LT STA 499+50 ELEV 544.55
 PRECAST REINFORCED CONCRETE FLARED
 END SECTION 18" 2 EACH
 TRENCH BACKFILL 22 CU YD

BEGIN CONSTRUCTION
 STA. 498+00.00

END CONSTRUCTION
 STA. 501+60.00

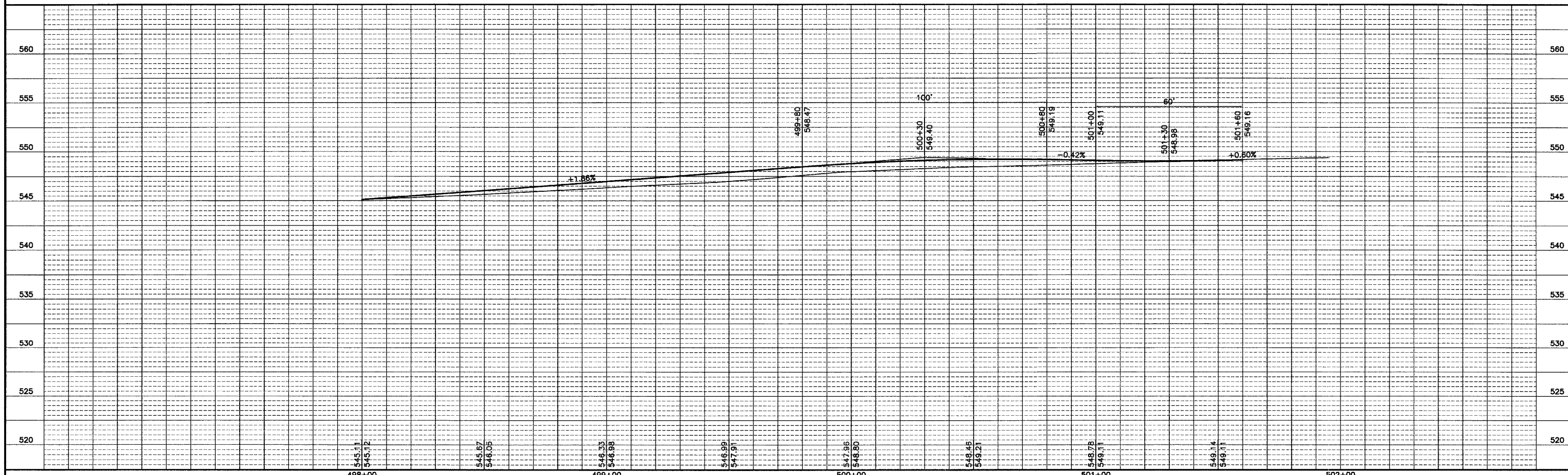
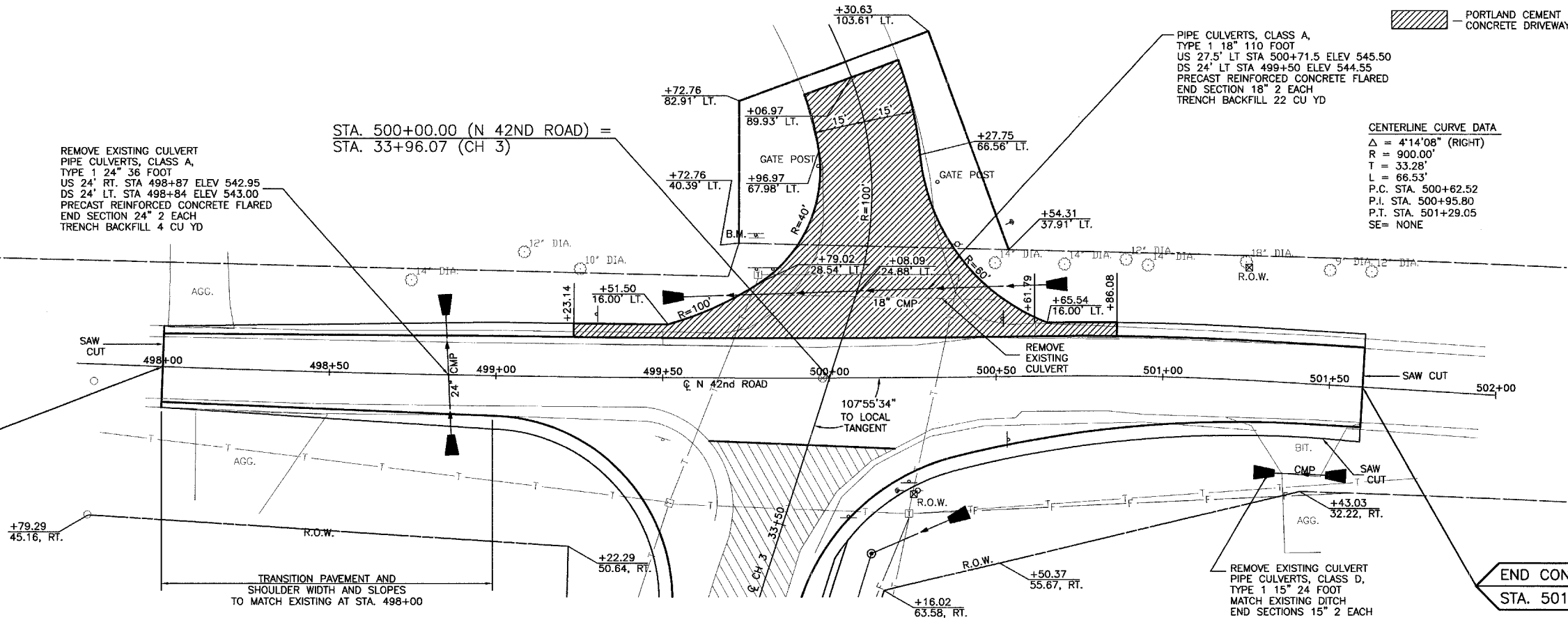

DRAWN BY: ARR
 CHECKED BY: JKC

DATE: 03/03

REVISIONS	
DATE	BY
3/08/04	NET

CHAMLIN ASSOCIATES
 PERU MORRIS
 ILLINOIS

FAS 259/COUNTY HIGHWAY 3 OVER FOX RIVER
 SECTION 98-00545-00-BR
 LASALLE COUNTY

PLAN AND PROFILE
 N. 42nd ROAD

SCALE: AS NOTED
 SHEET 15
 FILE NO.: 11174.01Y-1 OF 79