

PORTLAND CEMENT
CONCRETE DRIVEWAY 8"

STA. 500+00.00 (N 42ND ROAD)
STA. 33+96.07 (CH 3)

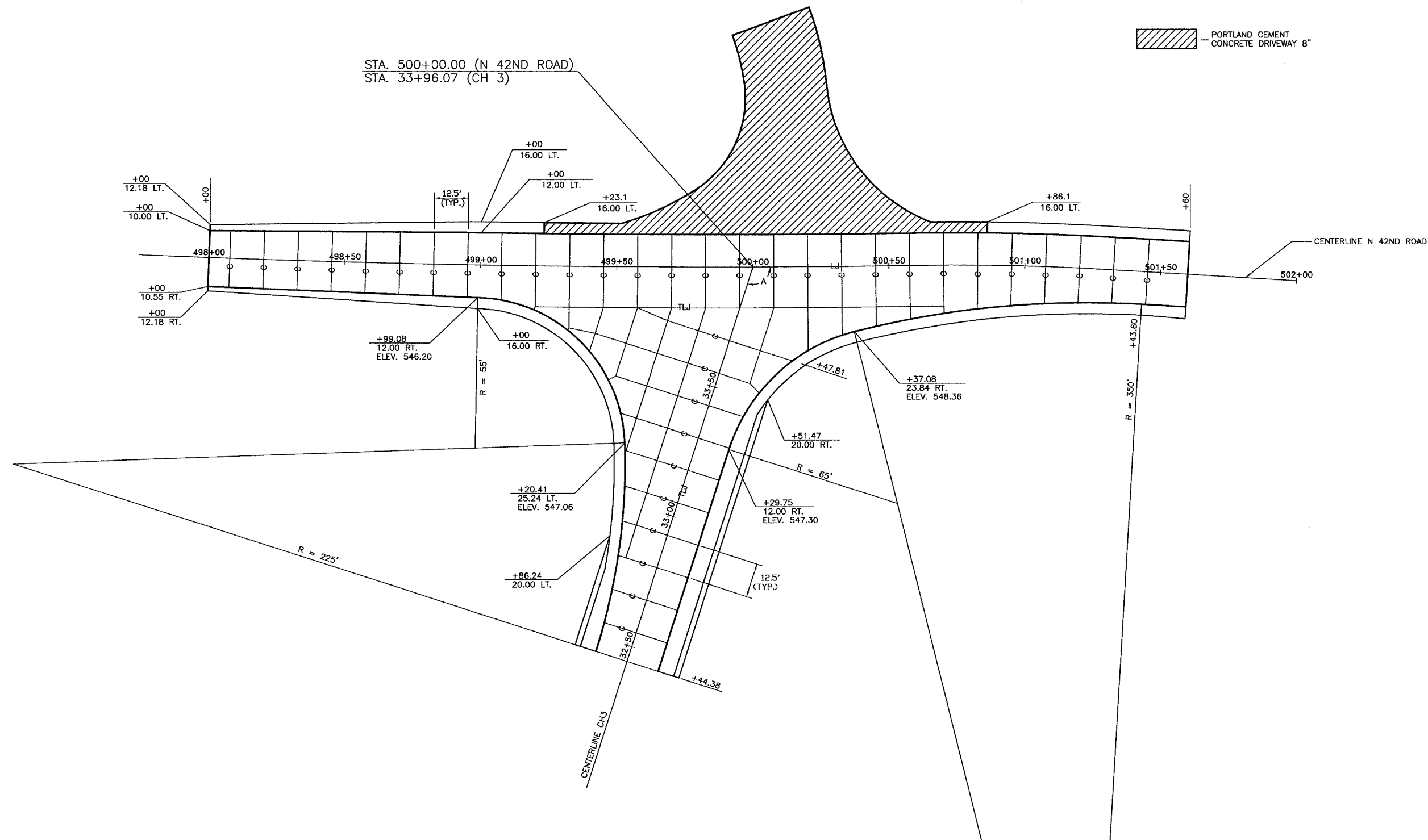

CENTERLINE CURVE DATA
 $\Delta = 4'14''08''$ (RIGHT)
 $R = 900.00'$
 $T = 33.28'$
 $L = 66.53'$
P.C. STA. 500+62.52
P.I. STA. 500+95.80
P.T. STA. 501+29.05
SE= NONE

CENTERLINE CURVE DATA
 $\Delta = 2'58''51''$ (LEFT)
 $R = 5000.00'$
 $T = 130.09'$
 $L = 260.13'$
P.C. STA. 498+00.00
P.I. STA. 499+30.09
P.T. STA. 500+60.13
SE= NONE

A - $107'55''34''$ TO LOCAL TANGENT
 STA. 33+96.07

LEGEND

LJ	- SAWED LONGITUDINAL JOINT
C	- SAWED CONTRACTION JOINT OR TRANSVERSE CONSTRUCTION JOINT
TLJ	- TIED LONGITUDINAL CONSTRUCTION JOINT

- NOTES:
1. USE TRANSVERSE CONSTRUCTION JOINT AT ALL STAGE CONSTRUCTION LINES.
 2. USE SAWED LONGITUDINAL JOINT ALONG CENTERLINE AND WHERE SHOWN.
 3. SEE STANDARDS 420101 AND 420001 FOR ADDITIONAL DETAILS.

INTERSECTION DETAILS
 FAS 259 C.H. 3
 OVER FOX RIVER
 SECTION 98-00545-00-BR
 LASALLE COUNTY

DRAWN BY: ARR	CAD: INTDET	REVISIONS		SCALE: AS NOTED	SHEET 25
		DATE	BY		
CHECKED BY: JKC	DATE: 03/03	3/08/04	NET	FILE NO.: 11174.01Y-1	OF 79