

STATE OF ILLINOIS
DEPARTMENT OF TRANSPORTATION
DIVISION OF HIGHWAYS
**PLANS FOR PROPOSED
FEDERAL AID HIGHWAY**
MAJOR BRIDGE PROGRAM
FAS RTE 259 (C.H. 3)
OVER THE FOX RIVER
SECTION 98-00545-00-BR
PROJECT NO. BRS-259(108)
LA SALLE COUNTY
C-93-063-02

98-00545-00-BR

ROUTE NO.	SECTION	COUNTY	TOTAL SHEETS	SHEET NO.
FAS 259		LA SALLE	74	1
FED. ROAD DIST. NO. 7		ILL. PROJ. NO.	FED. AID PROJECT NO.	

CONTRACT NO. 87240

INDEX OF SHEETS

1	COVER SHEET
2	GENERAL NOTES
3-4	SUMMARY OF QUANTITIES
5	TYPICAL SECTIONS
6-7	SCHEDULE OF QUANTITIES
8	SWING TIES
9-14	PLAN & PROFILE COUNTY HIGHWAY 3
15	PLAN & PROFILE N 42nd ROAD
16	WEST FRONTAGE ROAD
17-20	EROSION CONTROL PLANS
21-24	TRAFFIC CONTROL
25	INTERSECTION DETAILS
26-63	BRIDGE PLANS
64-77	CROSS SECTIONS COUNTY HIGHWAY 3
78-79	CROSS SECTIONS N 42nd ROAD
* 80-82	EXISTING BRIDGE

STANDARDS

000001-04	STANDARD SYMBOLS, ABBREVIATIONS AND PATTERNS
280001-02	TEMPORARY EROSION CONTROL SYSTEMS
420001-05	PAVEMENT JOINTS
420101-02	7.2M (24") JOINTED P.C.C. PAVEMENT
420401-05	BRIDGE APPROACH PAVEMENT
483001-01	PCC SHOULDER
515001-02	NAME PLATE FOR BRIDGES
542301	PRECAST REINFORCED CONCRETE FLARED END SECTION
542401	METAL END SECTION FOR PIPE CULVERTS
601101	CONCRETE HEADWALLS FOR PIPE DRAINS
602301	INLET, TYPE A
602306	INLET, TYPE B
602401	MANHOLE, TYPE A
602601	PRECAST REINFORCED CONCRETE FLAT SLAB TOP
602701	CAST IRON STEPS
604001-02	FRAME AND LIDS, TYPE 1
604006-02	FRAME AND GRATE, TYPE 3
606001-02	CONCRETE CURB & COMBINATION CONCRETE CURB & GUTTER
606006	OUTLETS FOR CONC. CURB AND GUTTER TYPE B-15.60 (B-6.24)
609006-02	BRIDGE APPROACH PAVEMENT (DRAIN DETAIL)
630001-05	STEEL PLATE BEAM GUARDRAIL
631031-05	TRAFFIC BARRIER TERMINAL, TYPE 6
635006-02	REFLECTOR AND TERMINAL MARKER PLACEMENT
666001	RIGHT-OF-WAY MARKERS
667101	PERMANENT SURVEY MARKERS
701501-03	URBAN LANE CLOSURE 2L, 2W UNDIVIDED
702001-05	TRAFFIC CONTROL DEVICES
704001-02	TEMPORARY CONCRETE BARRIER
780001-01	TYPICAL PAVEMENT MARKINGS
BLR 10-4	P.C.C. PAVEMENT SPECIAL DETAILS
BLR 14-8	PORTLAND CEMENT CONCRETE PAVEMENT
BLR 21-6	TYPICAL APPLICATION OF TRAFFIC CONTROL DEVICES FOR CONSTRUCTION ON RURAL LOCAL HIGHWAYS
BLR 22-4	TYPICAL APPLICATION OF TRAFFIC CONTROL DEVICES FOR CONSTRUCTION ON RURAL LOCAL HIGHWAYS (TWO LANE - TWO WAY RURAL TRAFFIC) (ROAD CLOSED TO THRU TRAFFIC)

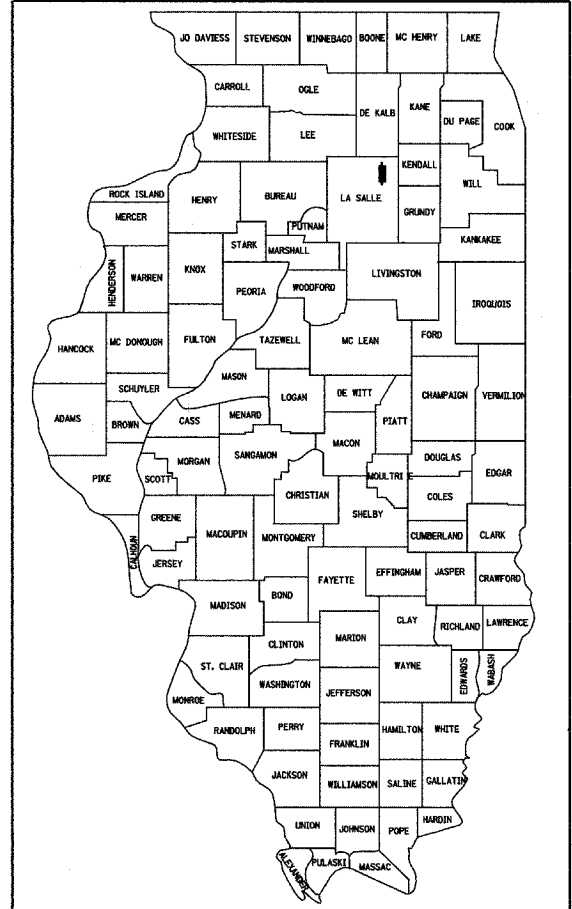

LOCATION OF SECTION INDICATED THUS: [Symbol]

PROJECT LOCATION
EXIST. SN 050-3013
PROP. SN 050-3562

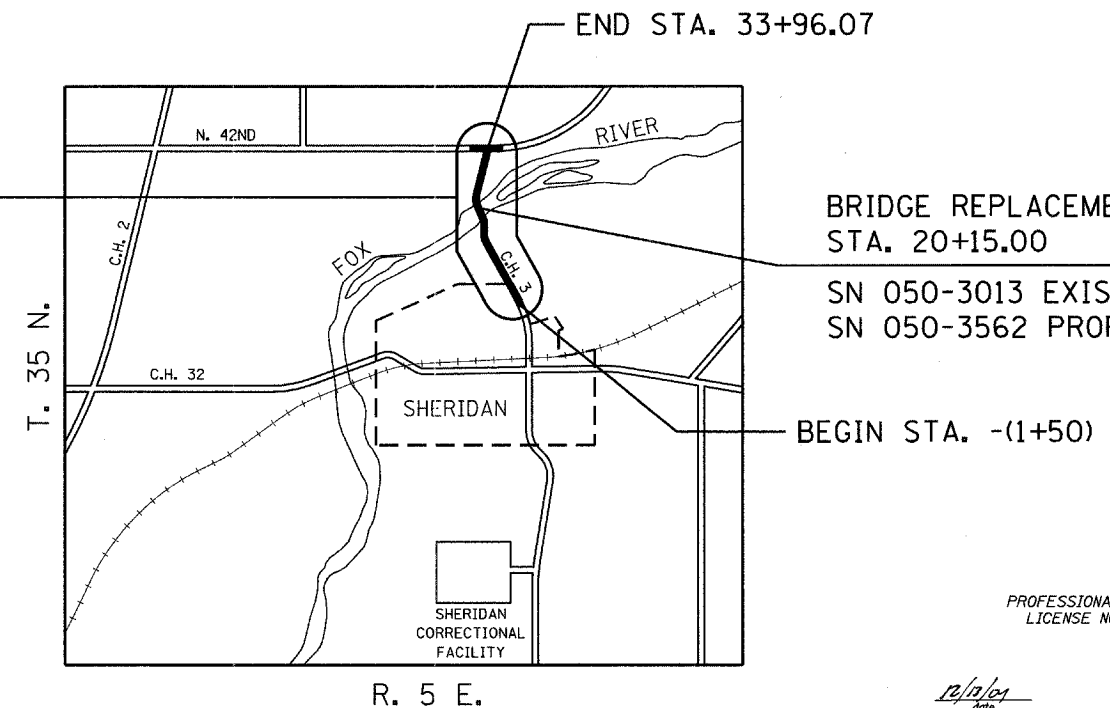

FAS RTE 259 (C.H. 3)
FUNCTIONAL CLASSIFICATION: MAJOR COLLECTOR

ADT = 2885 (2001)
PV = 87.7%
MU = 7.9%
SU = 4.4%

MICROFILMED _____
REEL NUMBER _____
AWARDED _____
RESIDENT ENGINEER _____
AS BUILT CHANGES WERE MADE
ON THE FOLLOWING SHEETS _____

JULIE 1-800-892-0123
DISTRICT 3 NO. (815) 434-6131

TOWNSHIP: NORTHVILLE & MISSION

PROFESSIONAL DESIGN FIRM
LICENSE NO. 184-001717

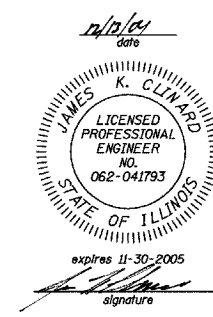
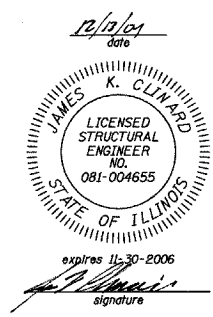

SUBMITTED 12/14 2004
PASSED 12/16 2004
APPROVED 12/16 2004
LOCAL AGENCY
BUREAU CHIEF OF LOCAL ROADS AND STREETS
DISTRICT ENGINEER

NET LENGTH OF SECTION 3546.07' (0.672 miles)
GROSS LENGTH OF SECTION 3546.07' (0.672 miles)