

**INDEX OF SHEETS**

SEE SHEET 2

**STATE OF ILLINOIS**  
**DEPARTMENT OF TRANSPORTATION**  
**DIVISION OF HIGHWAYS**  
**PLANS FOR PROPOSED**  
**FEDERAL AID HIGHWAY**

FAP ROUTE 711 (U.S. ROUTE 136)  
 SECTION 115(BY,BY-1)BR  
 PROJECT NO. F-0711(007)  
 BRIDGE REPLACEMENT  
 VERMILION COUNTY  
 C-95-058-96

R13W R12W  
 2ND P.M. 2ND P.M.

| FAP RTE.  | SECTION        | COUNTY    | TOTAL SHEETS       | SHEET NO. |
|---|----------------|-----------|--------------------|-----------|
| 711   | 115(BY,BY-1)BR | VERMILION | 94                 | 1         |
| FED. ROAD DIST. NO. 7 ILLINOIS FED. AID PROJECT |                |           | CONTRACT NO. 90843 |           |

**D-95-033-96**

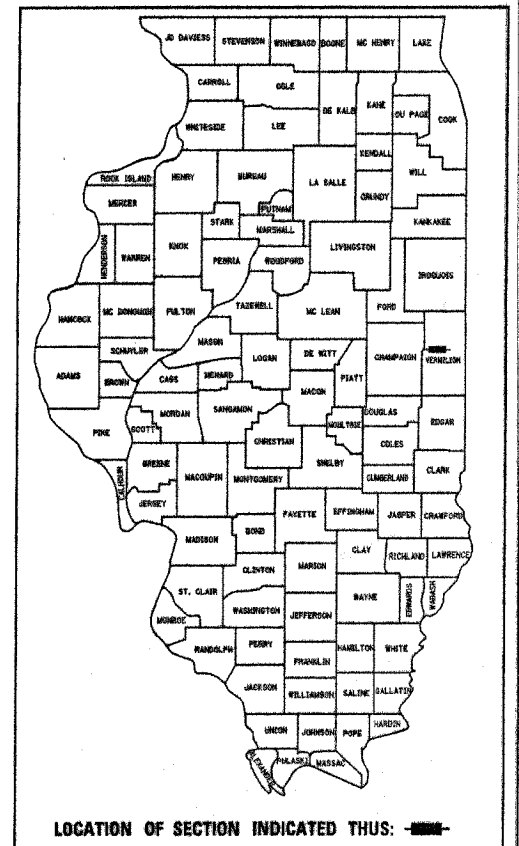

STATE OF ILLINOIS  
 DEPARTMENT OF TRANSPORTATION  
 DIVISION OF HIGHWAYS

SUBMITTED Dec 6 20 04  
Joseph E. Cross DISTRICT ENGINEER

February 4 20 05  
Mike Kane ENGINEER OF DESIGN AND ENVIRONMENT

February 4 20 05  
Victor Modesto DIRECTOR, DIVISION OF HIGHWAYS

**BLANK, WESSELINK, COOK & ASSOCIATES**  
 ENGINEERS - CONSULTANTS  
 DECATUR, ILLINOIS



Sheila Kimlinger  
 SHEILA J. KIMLINGER, P.E.  
 DATE June 14 20 04  
 EXPIRES NOVEMBER 30, 2005

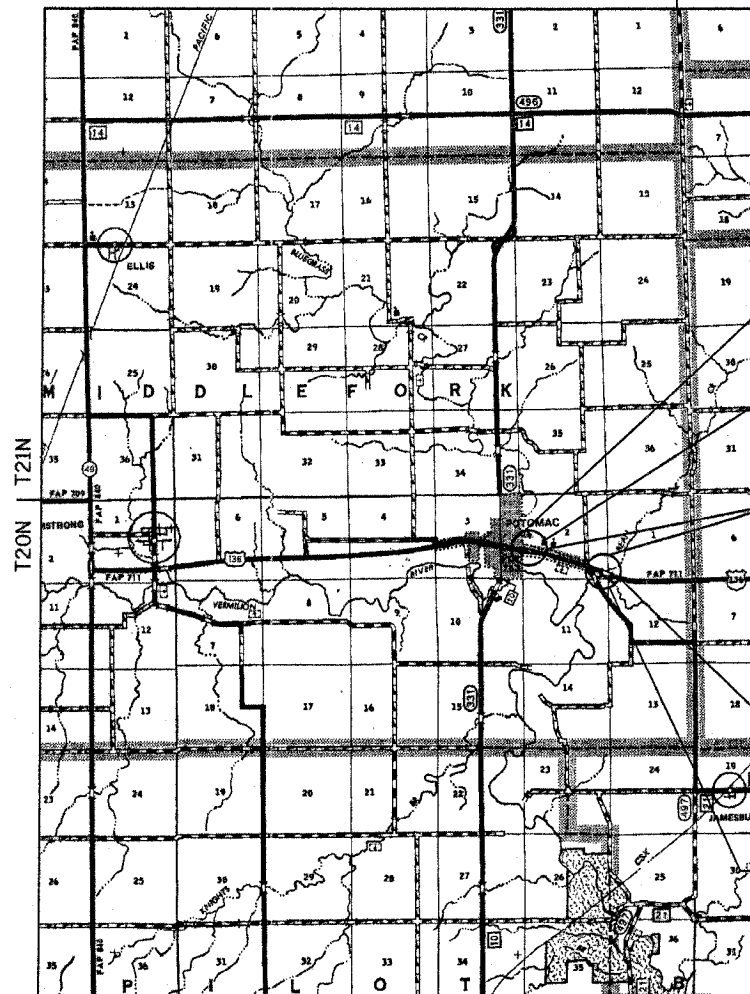

SECTION 115(BY, BY-1)BR  
 PROJECT BEGINS  
 STA. 232 + 32.50  
 S.N. 092-0063 (EXISTING)  
 S.N. 092-0200 (PROPOSED)  
 STA. 236 + 24.70  
 198'-10" BK. TO BK. ABUTMENTS  
 44'-10" OUT TO OUT  
 45 DEGREES, LEFT FORWARD SKEW

ROADWAY OMISSION  
 STA. 243 + 75.00 TO  
 STA. 284 + 85.00

SECTION 115(BY, BY-1)BR  
 PROJECT ENDS  
 STA. 286 + 70.00  
 S.N. 092-0064 (EXISTING)  
 S.N. 092-0201 (PROPOSED)  
 STA. 286 + 77.00  
 196'-0" BK. TO BK. ABUTMENTS  
 39'-2" OUT TO OUT  
 45 DEGREES, LEFT FORWARD SKEW

**LOCATION MAP**

GROSS LENGTH OF PROJECT = 5637.5 FEET = 1.068 MILES  
 NET LENGTH OF PROJECT = 1527.5 FEET = 0.289 MILES  
 ADT = 2700 (2003)

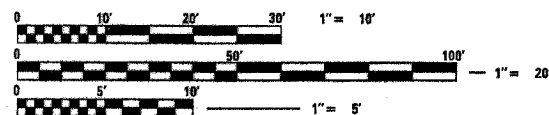

SCALES { PLAN 1" = 20'  
 PROFILE HORIZ. 1" = 20'  
 PROFILE VERT. 1" = 5'  
 CROSS SECTIONS 1" = 10'  
 1" = 5'

FULL SIZE PLANS HAVE BEEN PREPARED USING STANDARD ENGINEERING SCALES. REDUCED SIZED PLANS WILL NOT CONFORM TO STANDARD SCALES. IN MAKING MEASUREMENTS ON REDUCED PLANS, THE ABOVE SCALES MAY BE USED.

FOR UNDERGROUND UTILITY LOCATIONS CALL J.U.L.I.E. TOLL FREE 1-800-892-0123 PILOT TOWNSHIP

**CONTRACT NO. 90843**

PROJECT ENGINEER: KENSIL GARNETT  
 CONSULTANT LIAISON: NANCY FASIG 217-465-4181