

PAVEMENT MARKING REMOVAL	
STATION TO STATION	SQ. FT.
RT 501+00.00 TO RT 507+32.63	210.67
LT 801+00.00 TO LT 807+35.00	211.46
LT 231+00.00 TO LT 273+35.00	1,410.26
LT 509+95.93 TO LT 515+38.36	542.43
RT 510+48.36 TO RT 516+00.00	183.70
RT 298+71.22 TO RT 304+14.03	180.76
RT 306+74.42 TO RT 312+00.00	175.02
RT 306+26.82 TO RT 311+18.96	163.88
TOTAL	3,078.18

TEMPORARY PAINT PAVEMENT MARKING LINE 4"			
STATION TO STATION	FOOT		
RT 501+00.00 TO RT 507+32.63	632.63	WHITE	
LT 801+00.00 TO LT 807+35.00	635.00	YELLOW	
LT 231+00.00 TO LT 273+35.00	4,235.00	WHITE	
LT 509+95.93 TO LT 515+38.36	542.43	YELLOW	
RT 510+48.36 TO RT 516+00.00	551.64	WHITE	
RT 298+71.22 TO RT 304+14.03	542.81	YELLOW	
RT 306+74.42 TO RT 312+00.00	525.58	WHITE	
RT 306+26.82 TO RT 311+18.96	492.14	YELLOW	
TOTAL	8,157.23		

TRAFFIC CONTROL STAGE II

STRUCTURE NUMBER 058-0068 W.B. & 058-0069 E.B.
STRUCTURE NUMBER 058-0070 W.B. & 058-0071 E.B.

F.A.I. RTE.	SECTION	COUNTY	TOTAL SHEETS	SHEET NO.
72	*	MACON	135	58
STA. 501+00		TO STA. 516+00		
FED. ROAD DIST. NO.		ILLINOIS	FED. AID PROJECT	

(58-62,58-62-1,58-63)RS
CONTRACT NO. 90879

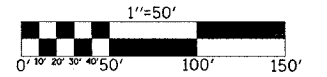

S.N. 058-0068 (WB/SB) & 058-0069 (EB/NB)
STA 305+13.04 (I-72/US 51) &
STA 508+89.58 (I-72/US 51)

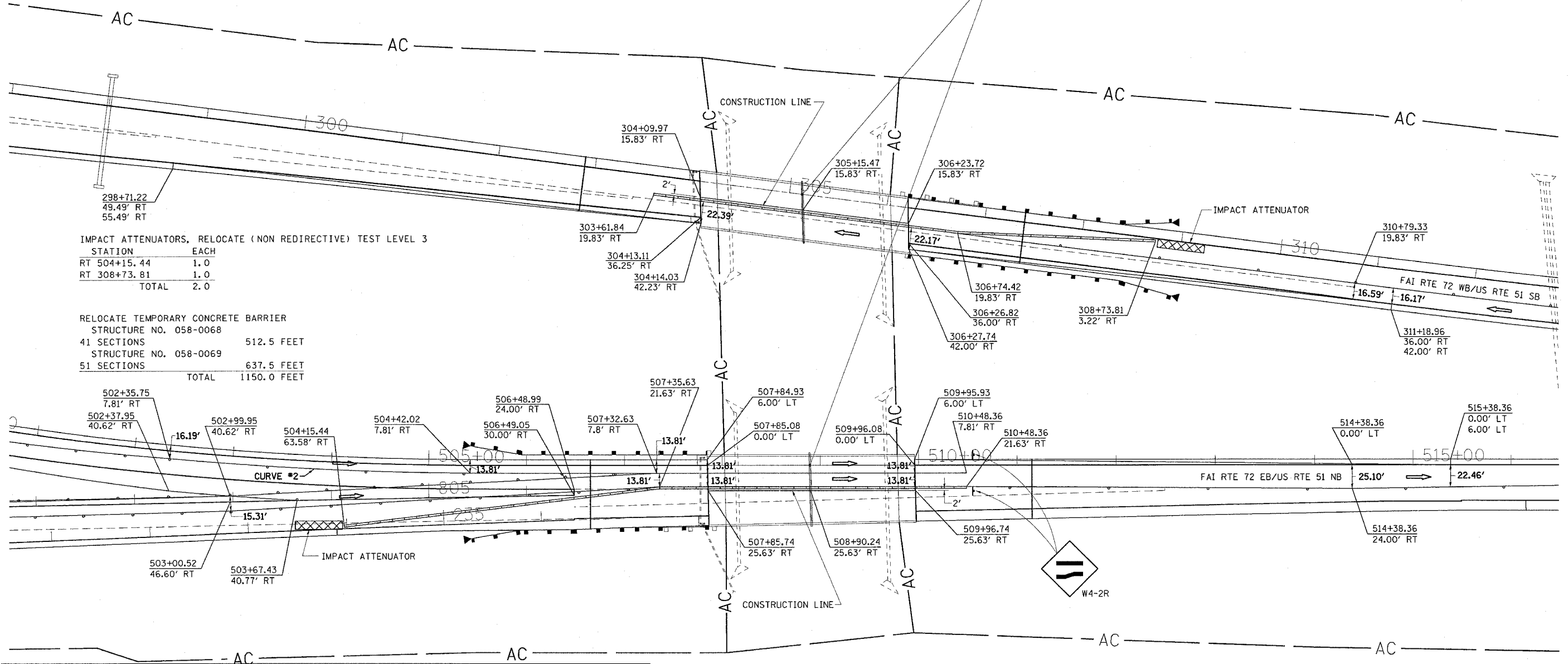

IMPACT ATTENUATORS, RELOCATE (NON REDIRECTIVE) TEST LEVEL 3

STATION	EACH
RT 504+15.44	1.0
RT 308+73.81	1.0
TOTAL	2.0

RELOCATE TEMPORARY CONCRETE BARRIER

STRUCTURE NO.	512.5 FEET
41 SECTIONS	
STRUCTURE NO.	637.5 FEET
51 SECTIONS	
TOTAL	1150.0 FEET

NOTES:

TRAFFIC DETAILS NOT SHOWN ARE TO CONFORM WITH STANDARDS 701401, 701402 AND 701411.

DIRECTION INDICATOR BARRICADES REQUIRED IN ALL LANE CLOSER TAPERS WHEN USING STANDARDS 701401 AND 701402.

THREE TEMPORARY CONCRETE BARRIERS ON STRUCTURE 058-0068 STAGE I WILL BE RELOCATED TO STRUCTURE 058-0069 STAGE II.

MESSAGE BOARD MAY BE ADJUSTED TO MEET FIELD CONDITIONS.

RESIDENT ENGINEER AND TRAFFIC CONTROL SUPERVISOR WILL PROVIDE APPROPRIATE MESSAGE FOR THE CHANGEABLE MESSAGE SIGN.

WHERE SHOULDERS OF SUFFICIENT WIDTH ARE NOT AVAILABLE FOR ACCESS OF THE STRUCTURE, THE CONTRACTOR SHALL PROVIDE TEMPORARY SHOULDER WIDENING AS DEEMED NECESSARY. THIS WORK WILL BE CONSIDERED INCIDENTAL TO THE CONTRACT AND NO ADDITIONAL COMPENSATION WILL BE ALLOWED.

CURVE #2	FAI RTE 72 EB
START	502+35.72
END	505+42.02
RADIUS	3281.85'

REVISIONS	
NAME	DATE

ILLINOIS DEPARTMENT OF TRANSPORTATION

TRAFFIC CONTROL - STAGE II

F.A.I. ROUTE 72

SECTION (58-62,58-62-1,58-63)RS

MACON COUNTY

SCALE: VERT. 1" = 50'
HORIZ. 1" = 50'

DATE 10/22/03

DRAWN BY CADD
CHECKED BY