

STATION 54+40 TO STATION 60+40

F.A.P. RTE.	SECTION	COUNTY	TOTAL SHEETS	SHEET NO.
320		MACON	51	29

\*(126X)RS-1&135[(R)RS&(BR-1)BR]  
CONTRACT NO. 90926

THERMOPLASTIC PAVEMENT MARKING - LETTERS & SYMBOLS

WHITE ARROWS L/R	17 @ 15.6 S.F. = 265.2 S.F.
WHITE ARROWS COMB.	1 @ 26.0 S.F. = 26.0 S.F.
<b>TOTAL</b>	<b>291.2 S.F.</b>

THERMOPLASTIC PAVEMENT MARKING - LINE 12"

WHITE	127 FT.
<b>TOTAL</b>	<b>127 FT.</b>

THERMOPLASTIC PAVEMENT MARKING - LINE 4"

SOLID WHITE	830 FT.
SKIP-DASH WHITE	350 FT.
LANE LINE EXTENSIONS WHITE	56 FT.
SOLID YELLOW	967 FT.
LANE LINE EXTENSIONS DOUBLE YELLOW	36 FT.
<b>TOTAL</b>	<b>2,239 FT.</b>

THERMOPLASTIC PAVEMENT MARKING-LINE 24"

WHITE	219 FT.
<b>TOTAL</b>	<b>219 FT.</b>

THERMOPLASTIC PAVEMENT MARKING - LINE 6"

WHITE	306 FT.
<b>TOTAL</b>	<b>306 FT.</b>

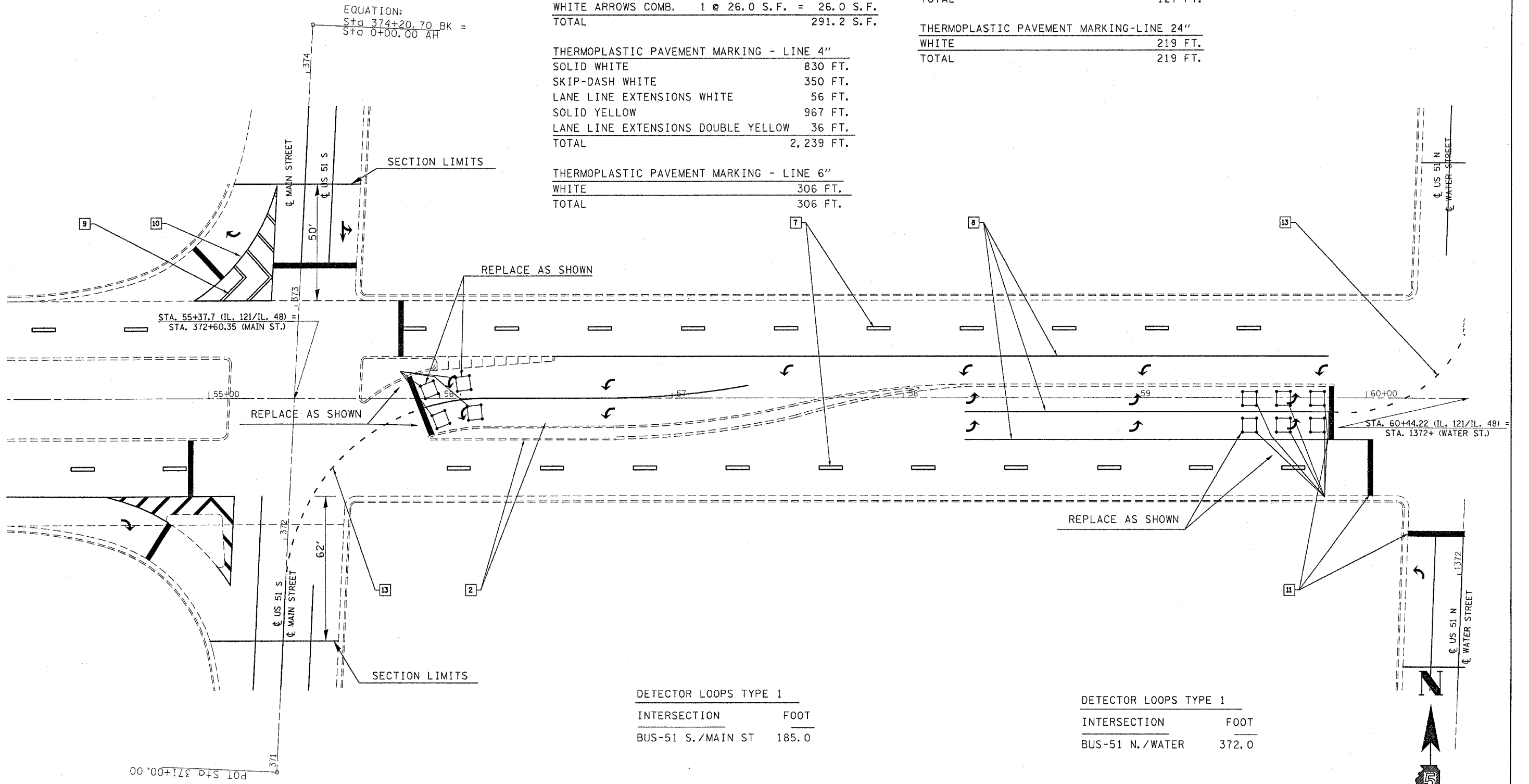

DETECTOR LOOPS TYPE 1

INTERSECTION	FOOT
BUS-51 S./MAIN ST	185.0

DETECTOR LOOPS TYPE 1

INTERSECTION	FOOT
BUS-51 N./WATER	372.0