

ROUTE NO.	SECTION	COUNTY	TOTAL SHEETS	SHEET NO.
T.R. 82	01-11135-00-BR	DEWITT	17	5
ROAD DIST.	ILLINOIS	WAPELLA	CONTRACT NO. 91302	

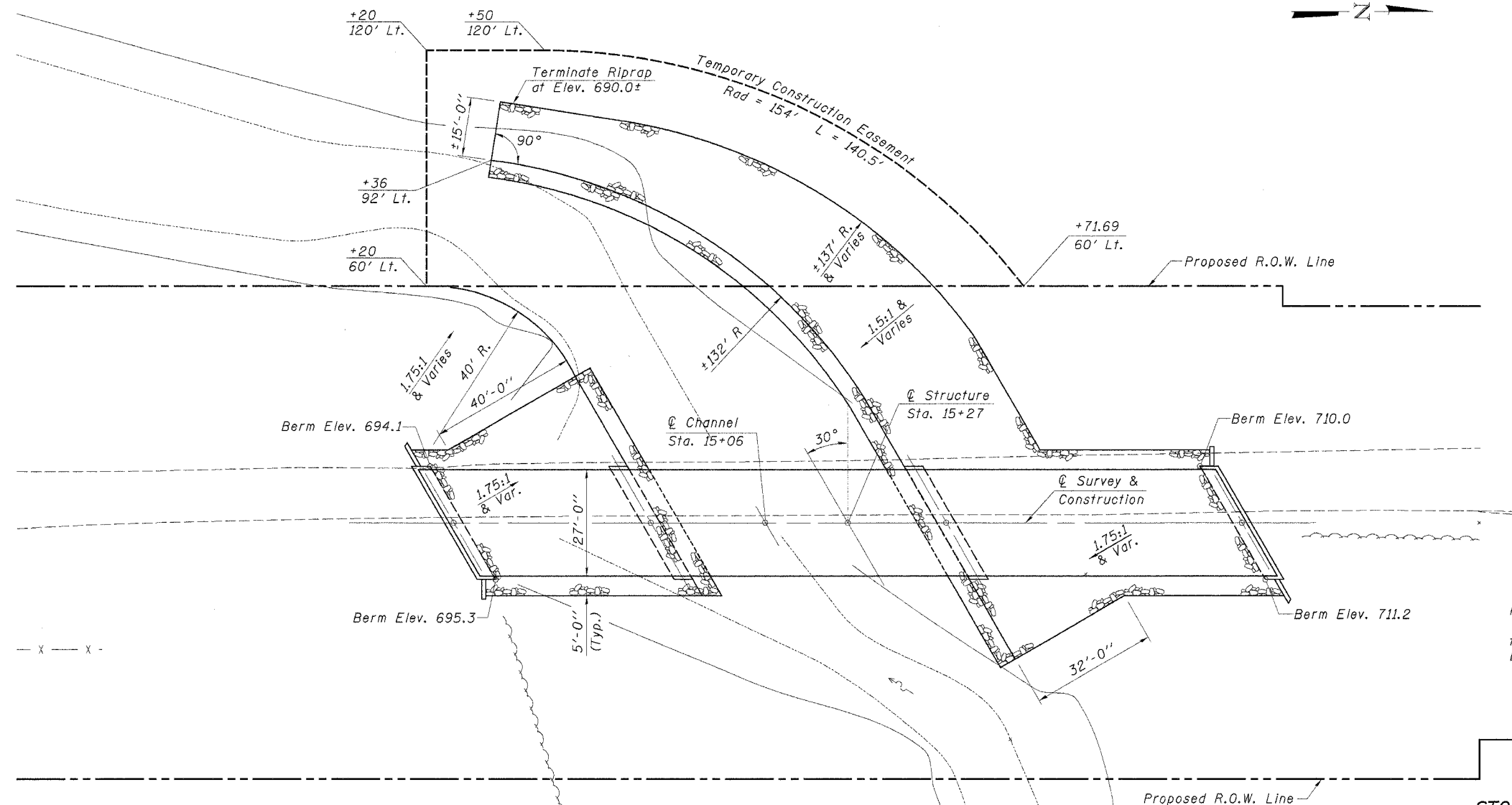

Note:
Layout of slope protection system may be varied in the field to suit ground conditions as directed by the Engineer.

STONE RIPRAP, CLASS A4 (SPECIAL)

Approximate Quantities:
South Abutment = 385 Ton
North Abutment = 1170 Ton
Total = 1555 Ton

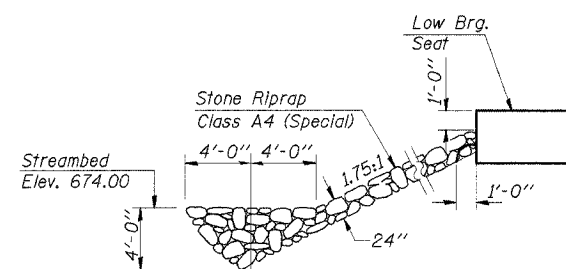

STONE RIPRAP ANCHOR DETAIL

Note: See Special Provisions for Stone Riprap, Class A4 (Special). (1.65 Ton/Cu. Yd.)

DESIGNED	SFM
CHECKED	FJS
DRAWN	SAP & KTR
CHECKED	SFM

RIPRAP DETAILS	
SECTION 01-11135-00-BR WAPELLA ROAD DISTRICT DeWITT COUNTY STATION 15+27	
4440 ASH GROVE SPRINGFIELD, IL 62707 (217) 793-8800 osaino@tamvid.com	OZYURT AND STONE, INC. CONSULTING ENGINEERS
JOB NO.: 0209 FILE: SLOPEWALL.DGN DATE: 05-10-04	