

PERIMETER EROSION CONTROL BARRIER

Station	To	Station	Quantity
144+50, 40' Lt.		148+50, 40' Lt.	400.0
144+50, 40' Rt.		148+10, 40' Rt.	360.0

Page Total = 760.0 ft.

TEMPORARY DITCH CHECKS

Station	o/s	Quantity
145+00	28' Rt.	1.0
145+00	28' Lt.	1.0
148+00	28' Rt.	1.0

Page Total = 3.0 ea.

INLET & PIPE PROTECTION

Station	Quantity
146+60, 28' Rt.	1.0
147+90, 26' Rt.	1.0
Type B's (as needed)	
148+29, Rt. to 149+59, Rt.	3.0
149+52, 27' Lt.	1.0
149+90, 52' Lt.	1.0
149+94, 60' Rt.	1.0

Page Total = 8.0 ea.

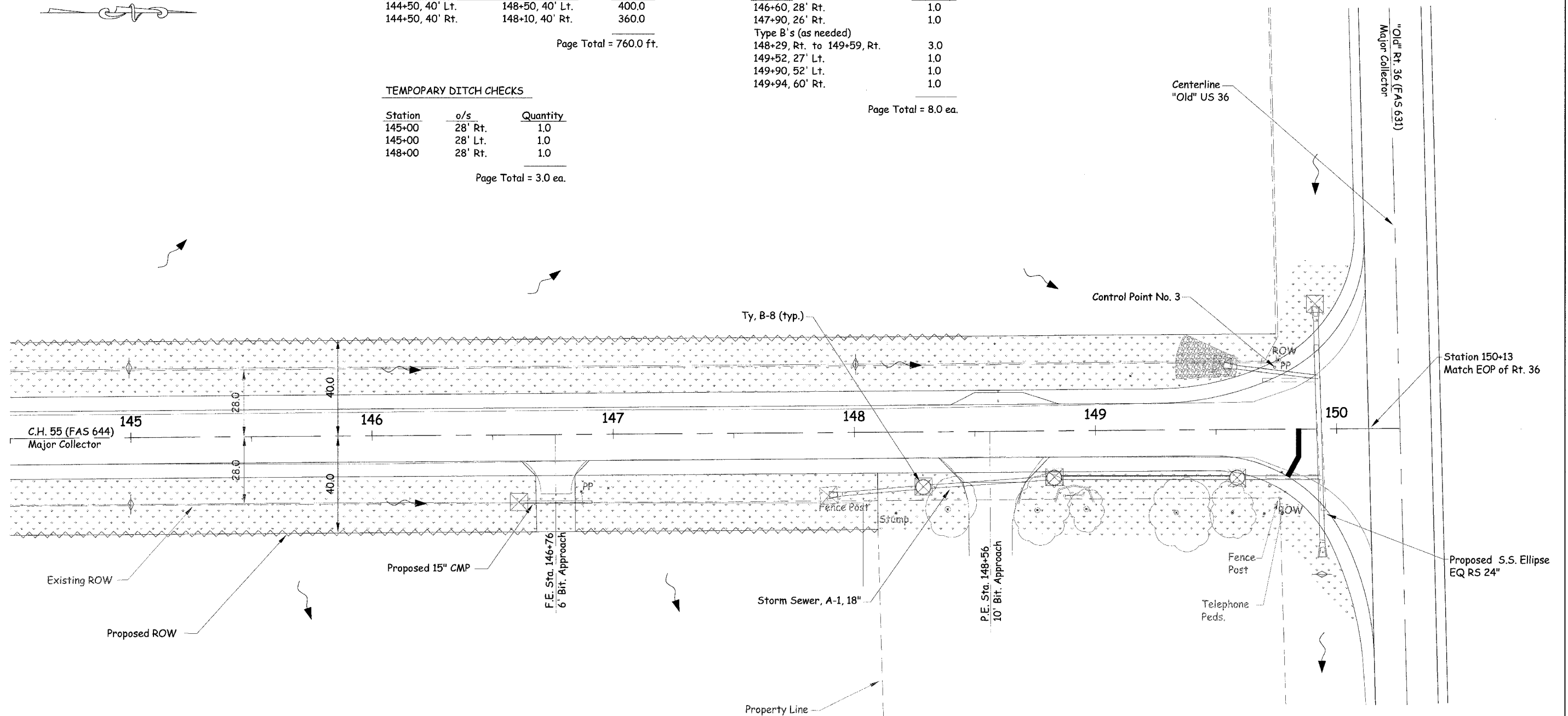

EROSION CONTROL LEGEND

- Permanent Seeding
- Temporary Ditch Check
- Inlet and Pipe Protection
- Perimeter Erosion Control Barrier
- Flow Direction
- Permanent Drainage Structure Number
- Proposed Storm Sewer

NOTES:

1. The Construction limits will be staked by the engineer prior to commencing construction. The construction limits may be adjusted by the engineer to preserve trees and no additional compensation will be paid th the contractor for the change in limits.
2. The Engineer shall have final determination of the placement and location of all erosion control pay items.
3. See proposed drainage specifications for storm sewer information.

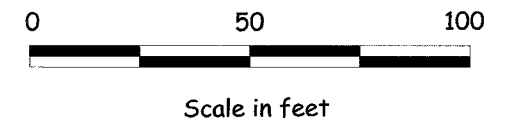

Erosion Control Plan View

Section 03-00176-00-PV
 County Highway 55 (FAS 631)
 MACON COUNTY - ENGINEERING DIVISION

Design by: RAJ	Approved by: XXX
CAD by: RAJ	Date: 09/13/04
Checked by: XXX	CAD Reference: XXXXXXXX
Sheet 11 of 25	