

RECOMMENDED STAGE CONSTRUCTION - STAGE 1

F.A.P. RTE.	SECTION	COUNTY	TOTAL SHEETS	SHEET NO.
328	5R, Y, RS-1	CLAY	376	21
STA.		TO STA.		
FED. ROAD DIST. NO. 7		ILLINOIS FED. AID PROJECT		
CONTRACT No 94367				



TRAFFIC CONTROL STANDARD 701331-01

- A) CONSTRUCT BOX CULVERT USING TRAFFIC CONTROL STANDARD 701321-07 AT: STA 1142+45.00 (SEE STAGE 1 CONSTRUCTION - BOX CULVERTS FOR DETAILS)
CONSTRUCT DETOUR ROADS #1 AND #2, INCLUDING TEMPORARY ENTRANCES, ENTRANCE PIPES, AND MAILBOX TURNOUTS.
CONCURRENTLY WITH THE DETOUR ROADS, CONSTRUCT CROSSOVER CONNECTIONS AT:
STA 998+00 TO STA 1001+00
STA 1017+50 TO STA 1019+40 (ALL EXISTING CENTERLINE STATIONING)
STA 1102+50 TO STA 1106+00
(SEE CROSSOVER DETAIL SHEETS FOR DETAILS)
CONSTRUCT ANY MAINLINE AND CROSSROAD PIPES AND BOX CULVERTS IN THESE AREAS FIRST.
- B) SHIFT TRAFFIC TO COMBINATION OF DETOUR ROADS AND EXISTING PAVEMENT USING CONTROL STANDARD 701331-01.
- C) CONSTRUCT NEW PAVEMENT, SHOULDERS, SLOPES, ETC.
STA 980+00 TO STA 998+00
STA 1001+00 TO STA 1017+00
STA 1019+75 TO STA 1102+00 (ALL PROPOSED MAINLINE CENTERLINE STATIONING)
STA 1106+00 TO STA 1138+00
- D) ANY CHANGES TO STAGING SHALL BE APPROVED BY THE ENGINEER.

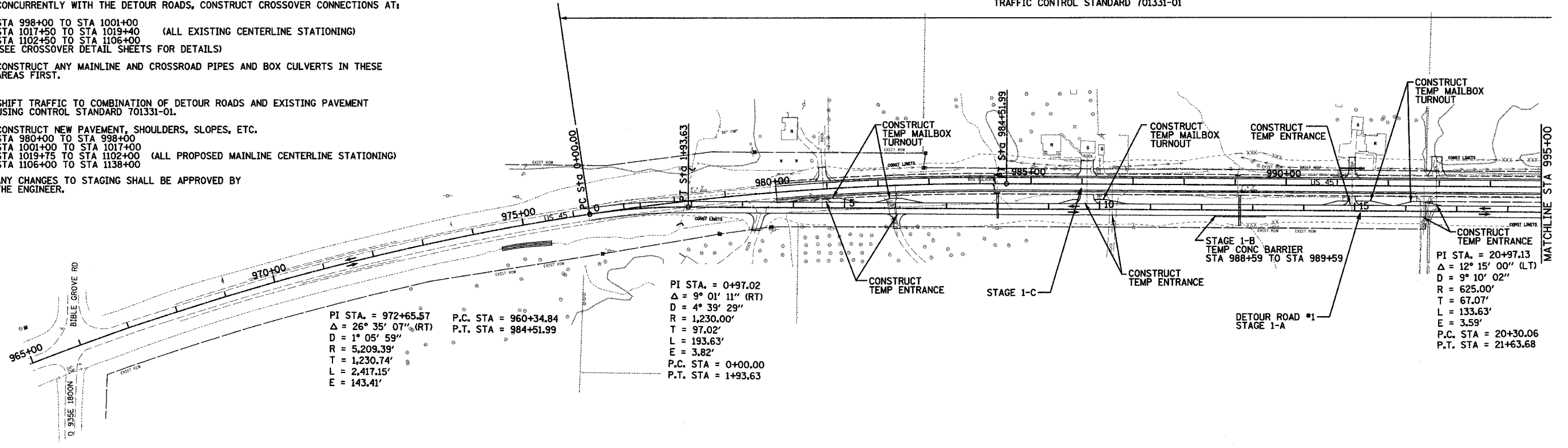

PI STA. = 972+65.57
 $\Delta = 26^\circ 35' 07''$ (RT)
 $D = 1^\circ 05' 59''$
 $R = 5,209.39'$
 $T = 1,230.74'$
 $L = 2,417.15'$
 $E = 143.41'$

P.C. STA = 960+34.84
 P.T. STA = 984+51.99

PI STA. = 0+97.02
 $\Delta = 9^\circ 01' 11''$ (RT)
 $D = 4^\circ 39' 29''$
 $R = 1,230.00'$
 $T = 97.02'$
 $L = 193.63'$
 $E = 3.82'$
 P.C. STA = 0+00.00
 P.T. STA = 1+93.63

CONSTRUCT TEMP ENTRANCE
 PI STA. = 20+97.13
 $\Delta = 12^\circ 15' 00''$ (LT)
 $D = 9^\circ 10' 02''$
 $R = 625.00'$
 $T = 67.07'$
 $L = 133.63'$
 $E = 3.59'$
 P.C. STA = 20+30.06
 P.T. STA = 21+63.68

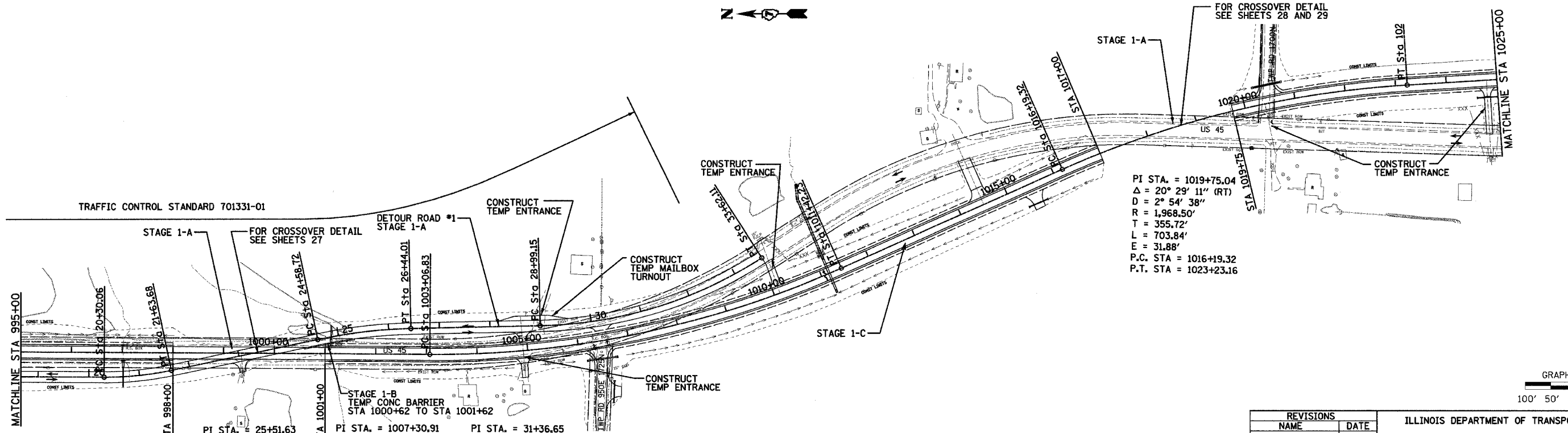

PI STA. = 25+51.63
 $\Delta = 10^\circ 37' 00''$ (RT)
 $D = 7^\circ 43' 46''$
 $R = 1,000.00'$
 $T = 92.91'$
 $L = 185.30'$
 $E = 4.31'$
 P.C. STA = 24+58.72
 P.T. STA = 26+44.01

PI STA. = 1007+30.91
 $\Delta = 24^\circ 18' 55''$ (LT)
 $D = 2^\circ 54' 38''$
 $R = 1,968.50'$
 $T = 424.08'$
 $L = 835.40'$
 $E = 45.16'$
 P.C. STA = 1003+06.83
 P.T. STA = 1011+42.23

PI STA. = 31+36.65
 $\Delta = 31^\circ 31' 19''$ (LT)
 $D = 6^\circ 48' 32''$
 $R = 790.00'$
 $T = 237.50'$
 $L = 462.96'$
 $E = 32.87'$
 P.C. STA = 28+99.15
 P.T. STA = 33+62.11

PI STA. = 1019+75.04
 $\Delta = 20^\circ 29' 11''$ (RT)
 $D = 2^\circ 54' 38''$
 $R = 1,968.50'$
 $T = 355.72'$
 $L = 703.84'$
 $E = 31.88'$
 P.C. STA = 1016+19.32
 P.T. STA = 1023+23.16

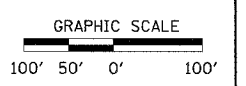

REVISIONS	
NAME	DATE

ILLINOIS DEPARTMENT OF TRANSPORTATION

STAGE 1 CONSTRUCTION

SCALE: VERT. HORIZ.
 DATE: 12/14/04

DRAWN BY: JJC
 CHECKED BY: MAR