

F.A.P. RTE.	SECTION	COUNTY	TOTAL SHEETS	SHEET NO.
328	5R, Y, RS-1	CLAY	376	22
STA.		TO STA.		
FED. ROAD DIST. NO. 7		ILLINOIS		FED. AID PROJECT
CONTRACT No 94367				

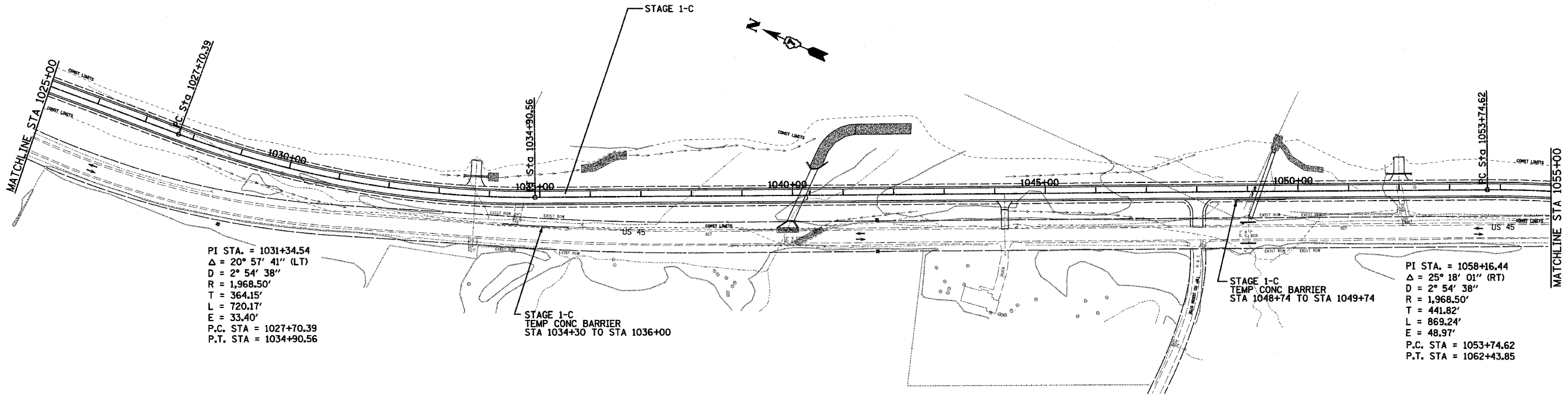

PI STA. = 1031+34.54  
 $\Delta$  = 20° 57' 41" (LT)  
 D = 2° 54' 38"  
 R = 1,968.50'  
 T = 364.15'  
 L = 720.17'  
 E = 33.40'  
 P.C. STA = 1027+70.39  
 P.T. STA = 1034+90.56

STAGE 1-C  
 TEMP CONC BARRIER  
 STA 1034+30 TO STA 1036+00

STAGE 1-C  
 TEMP CONC BARRIER  
 STA 1048+74 TO STA 1049+74

PI STA. = 1058+16.44  
 $\Delta$  = 25° 18' 01" (RT)  
 D = 2° 54' 38"  
 R = 1,968.50'  
 T = 441.82'  
 L = 869.24'  
 E = 48.97'  
 P.C. STA = 1053+74.62  
 P.T. STA = 1062+43.85

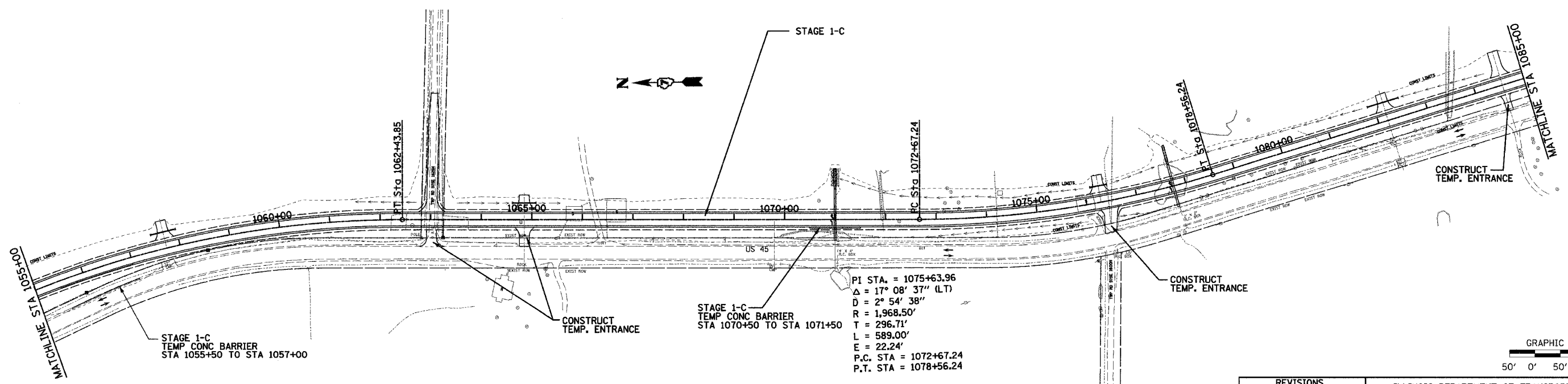

STAGE 1-C  
 TEMP CONC BARRIER  
 STA 1055+50 TO STA 1057+00

STAGE 1-C  
 TEMP CONC BARRIER  
 STA 1070+50 TO STA 1071+50

PI STA. = 1075+63.96  
 $\Delta$  = 17° 08' 37" (LT)  
 D = 2° 54' 38"  
 R = 1,968.50'  
 T = 296.71'  
 L = 589.00'  
 E = 22.24'  
 P.C. STA = 1072+67.24  
 P.T. STA = 1078+56.24

CONSTRUCT TEMP. ENTRANCE

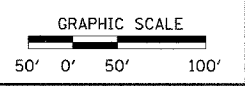

REVISIONS	
NAME	DATE

ILLINOIS DEPARTMENT OF TRANSPORTATION

# STAGE 1 CONSTRUCTION

SCALE: VERT.  
HORIZ.  
DATE: 12/14/04

DRAWN BY: JJC  
CHECKED BY: MAR