

# STAGE 1-A (PHASE 1)

CLASS D PAVEMENT PATCH  
 IMPACT ATTENUATORS, TEMPORARY (FULLY REDIRECTIVE), TEST LEVEL 3

F.A.P. RTE.	SECTION	COUNTY	TOTAL SHEETS	SHEET NO.
328	5R, Y, RS-1	CLAY	376	32
STA. 1142+00		TO STA. 1145+00		
FED. ROAD DIST. NO. 7		ILLINOIS	FED. AID PROJECT	
CONTRACT No 94367				

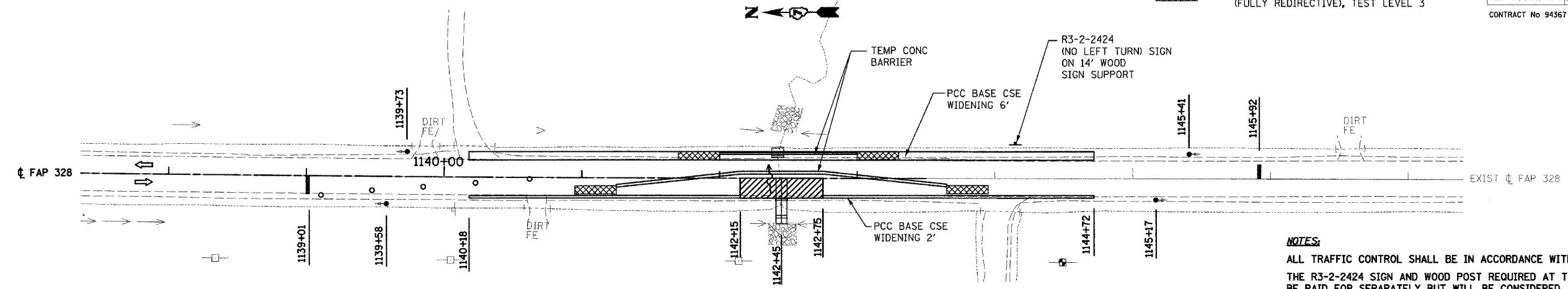

**NOTES:**  
 ALL TRAFFIC CONTROL SHALL BE IN ACCORDANCE WITH STANDARD 701321-07.  
 THE R3-2-2424 SIGN AND WOOD POST REQUIRED AT THIS LOCATION WILL NOT BE PAID FOR SEPARATELY BUT WILL BE CONSIDERED AS INCIDENTAL TO STANDARD 701321-07.

- PAVEMENT PATCHING, TYPE IV, 10 INCH**  
 RT 1142+15 TO RT 1142+75 100 SQ YD
- TEMPORARY CONCRETE BARRIER (STATE OWNED)**  
 LT 1142+00 TO 1143+00 100 FT  
 CL 1141+25 TO 1143+65 240 FT
- TEMPORARY PRECAST CONCRETE BOX CULVERT 4'X2'**  
 LT 1142+45 6 FT
- IMPACT ATTENUATORS, TEMPORARY (FULLY REDIRECTIVE), TEST LEVEL 3**  
 LT 1142+00 1 EACH  
 LT 1143+00 1 EACH  
 CL 1141+25 1 EACH  
 CL 1143+65 1 EACH
- WORK ZONE PAVEMENT MARKING REMOVAL**  
 CL 1141+53 TO 1143+40 62 SQ FT  
 LT 1140+85 TO 1144+05 107 SQ FT
- TEMPORARY PAVEMENT MARKING - LINE 4"**  
 CL 1141+53 TO 1143+40 187 FT  
 LT 1140+85 TO 1144+05 320 FT
- TEMPORARY BRIDGE TRAFFIC SIGNAL**  
 1 EACH
- PCC BASE COURSE WIDENING 6" 6'-0" WIDTH**  
 LT 1140+18 TO LT 1144+72 303 SQ YD
- PCC BASE COURSE WIDENING 6" 2'-0" WIDTH**  
 RT 1140+18 TO RT 1142+15 44 SQ YD  
 RT 1142+75 TO RT 1144+72 44 SQ YD
- TEMPORARY RUMBLE STRIPS**  
 RT 1122+01 1 EACH LT 1152+92 1 EACH  
 RT 1127+01 1 EACH LT 1157+92 1 EACH  
 RT 1132+01 1 EACH LT 1162+92 1 EACH

**SUGGESTED SEQUENCE (MAJOR ITEMS NOTED)**  
 CONSTRUCT BOX CULVERT EXTENSION AND COLLATERAL EARTHWORK FOR SHOULDER WIDENING.  
 CONSTRUCT PCC BASE CSE WIDENING ALONG WEST EDGE OF SHOULDER.  
 INSTALL TEMPORARY TRAFFIC SIGNALS.  
 INSTALL SHEET PILING (SEE TEMP SHEET PILING DETAIL SHEET).  
 SET TEMPORARY CONCRETE BARRIERS (STD 704001) FOR PHASE ONE.  
 CONSTRUCT NEW BOX CULVERT ON WEST SIDE TO 1'-0" WEST OF CENTERLINE.  
 CONSTRUCT GEOTEXTILE RETAINING WALL AND PAVEMENT ON WEST SIDE.  
 SWITCH TRAFFIC TO WEST SIDE.  
 REMOVE SHEET PILING IN PLACE FOR PHASE 1 (SEE PILING DETAIL SHEET).  
 CONSTRUCT REMAINDER OF NEW BOX CULVERT AND PAVEMENT ON EAST SIDE.  
 REMOVE REMAINING STAGING ITEMS.  
 ANY CHANGES TO STAGING SHALL BE APPROVED BY THE ENGINEER.

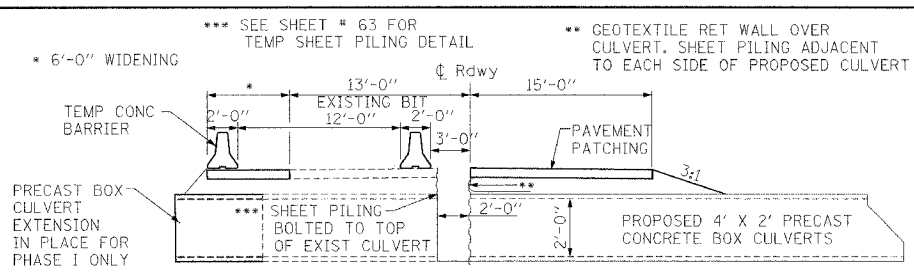

# STAGE 1-A (PHASE 2)

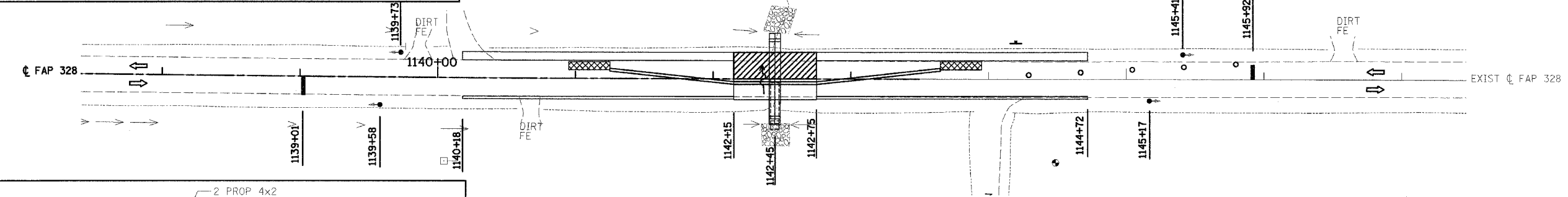
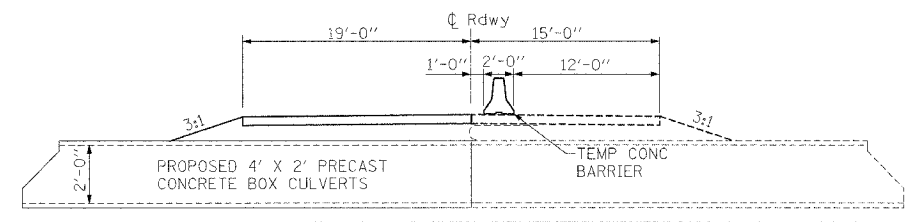

- PAVEMENT PATCHING, TYPE IV, 10 INCH**  
 RT 1142+15 TO RT 1142+75 127 SQ YD
- WORK ZONE PAVEMENT MARKING REMOVAL**  
 CL 1141+65 TO 1143+22 52 SQ FT  
 RT 1140+85 TO 1144+05 107 SQ FT
- TEMPORARY PAVEMENT MARKING - LINE 4"**  
 CL 1141+65 TO 1143+22 157 FT  
 RT 1140+85 TO 1144+05 320 FT
- IMPACT ATTENUATORS, RELOCATE (FULLY REDIRECTIVE), TEST LEVEL 3**  
 CL 1141+25 1 EACH  
 CL 1143+65 1 EACH
- RELOCATE TEMPORARY CONCRETE BARRIER (STATE OWNED)**  
 CL 1141+25 TO 1143+65 240 FT

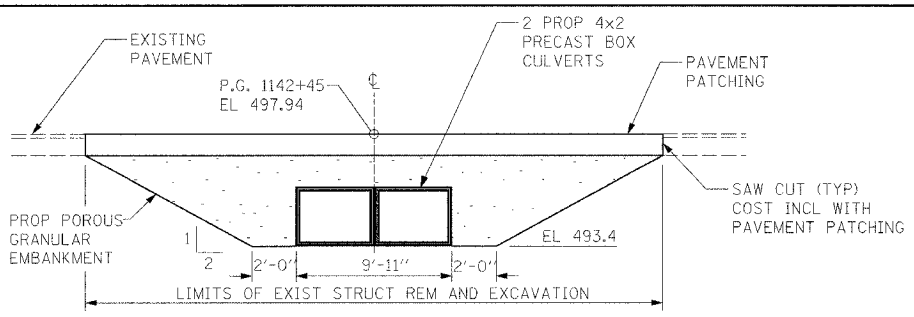

REVISIONS	
NAME	DATE

ILLINOIS DEPARTMENT OF TRANSPORTATION  
**STAGE 1 CONSTRUCTION BOX CULVERT STA 1142 + 45**  
 SCALE: VERT. 1"=10'  
 HORIZ. 1"=40'  
 DATE: 12/14/04  
 DRAWN BY: JJC  
 CHECKED BY: WHG