

F.A.P. RTE.	SECTION	COUNTY	TOTAL SHEETS	SHEET NO.
328	5R, Y, RS-1	CLAY	376	33
STA. 960+00		TO STA. 975+00		
FED. ROAD DIST. NO. 7 ILLINOIS FED. AID PROJECT				
CONTRACT No 94367				

PLAN	SURVEYED	DATE
	PLOTTED	BY
	CHECKED	BY
	BY	DATE
	NO. OF WAYS CHECKED	
	CADD FILE NAME	
	NO.	

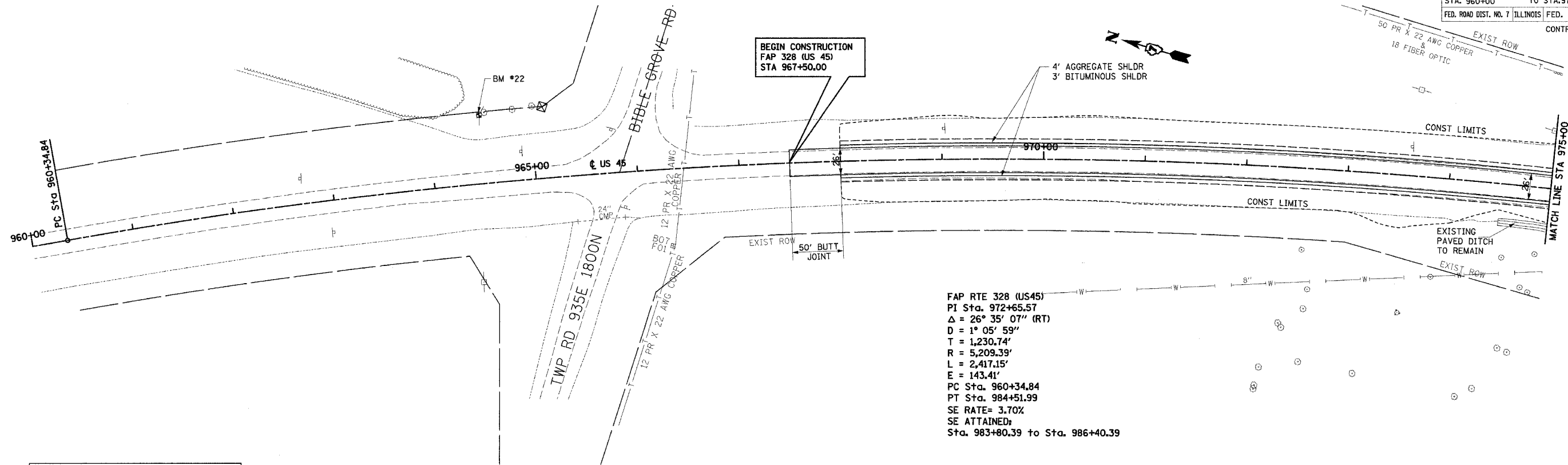

FAP RTE 328 (US45)  
 PI Sta. 972+65.57  
 $\Delta = 26^\circ 35' 07''$  (RT)  
 $D = 1^\circ 05' 59''$   
 $T = 1,230.74'$   
 $R = 5,209.39'$   
 $E = 2,417.15'$   
 $E = 143.41'$   
 PC Sta. 960+34.84  
 PT Sta. 984+51.99  
 SE RATE= 3.70%  
 SE ATTAINED:  
 Sta. 983+80.39 to Sta. 986+40.39

BM #22 STA 964+50.00, 66.90' LT.  
 RR SPIKE IN POWER POLE N.E.  
 QUAD. BIBLE GROVE RD EL 513.46

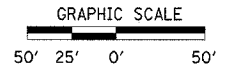

PROFILE	SURVEYED	DATE
	PLOTTED	BY
	CHECKED	BY
	BY	DATE
	NO. OF WAYS CHECKED	
	STRUCTURE NOTATIONS CHFD	
	NO.	

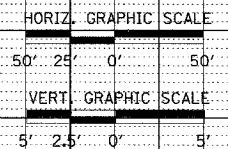
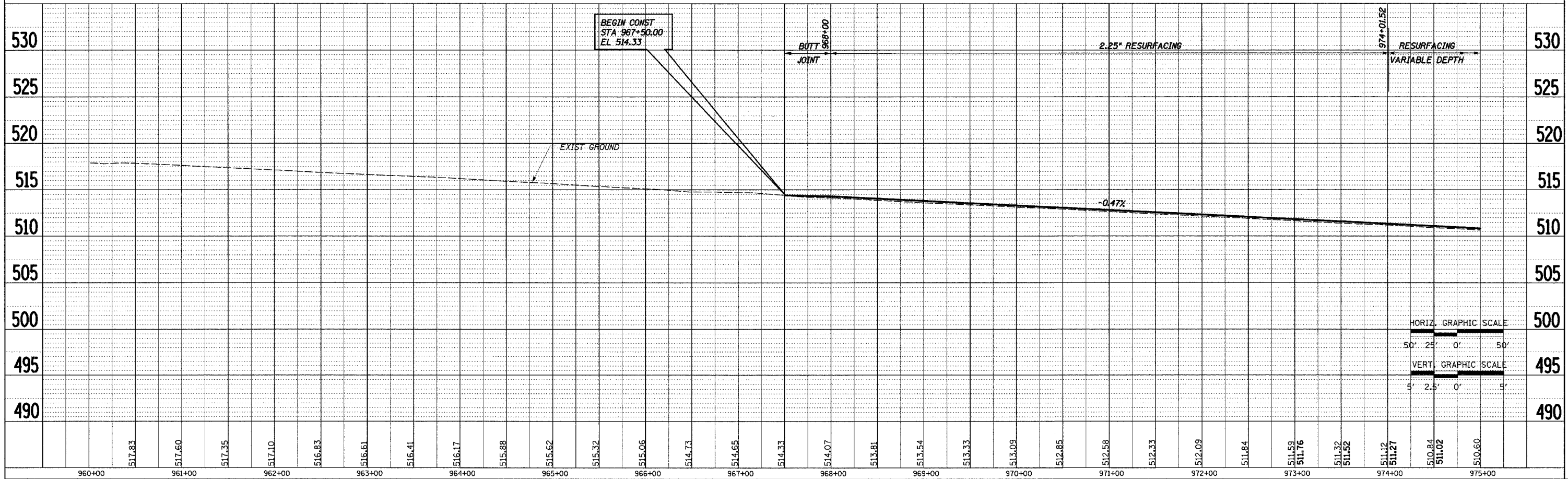

STA 960+00 TO STA 975+00

11/15/04 12:14:20 PM 7:01:39 AM