

F.A.P. RTE.	SECTION	COUNTY	TOTAL SHEETS	SHEET NO.
328	5R, Y, RS-1	CLAY	376	77
STA. 960+00		TO STA. 990+00		
FED. ROAD DIST. NO.		ILLINOIS FED. AID PROJECT		

CONTRACT No 94367

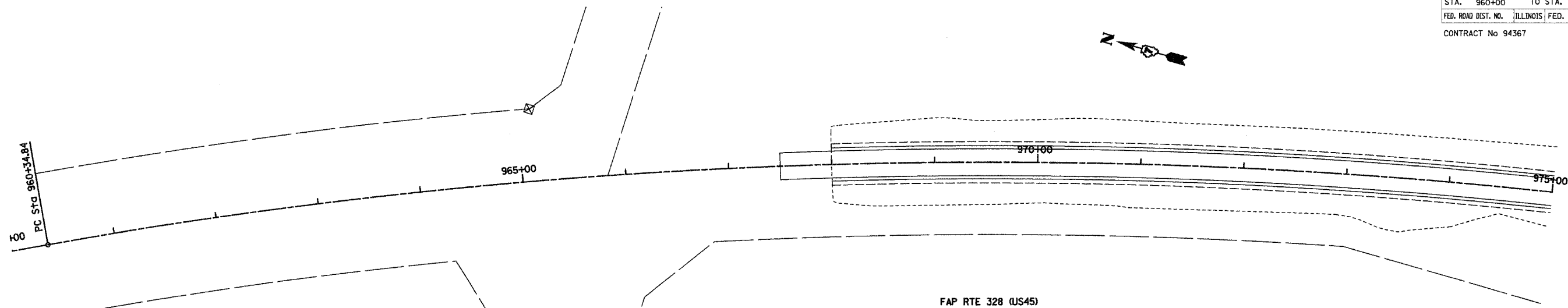

FAP RTE 328 (US45)
 PI Sta. 972+65.57
 $\Delta = 26^\circ 35' 07''$ (RT)
 $D = 1^\circ 05' 59''$
 $T = 1,230.74'$
 $R = 5,209.39'$
 $L = 2,417.15'$
 $E = 143.41'$
 PC Sta. 960+34.84
 PT Sta. 984+51.99
 SE RATE= 3.70%
 SE ATTAINED:
 Sta. 983+80.39 to Sta. 986+40.39

FAP RTE 328 (US45)

LEGEND

ITEM	SYMBOL
TEMPORARY DITCH CHECKS	
TEMPORARY DITCH CHECKS	
TEMPORARY SILT FENCE	
PERIMETER EROSION BARRIER SILT FENCE	
EROSION CONTROL BLANKET	
PRESERVE EXISTING TREES, WOODLANDS, AND UNDERSTORY (OUTSIDE CONSTRUCTION LIMITS)	
ITEMS PLACED AT BEGINNING OF CONSTRUCTION (REQUIREMENT)	
ITEMS PLACED AS DIRECTED BY ENGINEER (WHEN REQUIRED BY SITUATION)	

NOTE:
 ALL ITEMS SHALL BE CONSTRUCTED AS SHOWN ON STANDARD 280001 AND AS DIRECTED BY THE ENGINEER. MAINTENANCE AND CLEANING OF THE EROSION CONTROL ITEMS SHALL BE INCLUDED IN THE RESPECTIVE EROSION CONTROL PAY ITEMS.

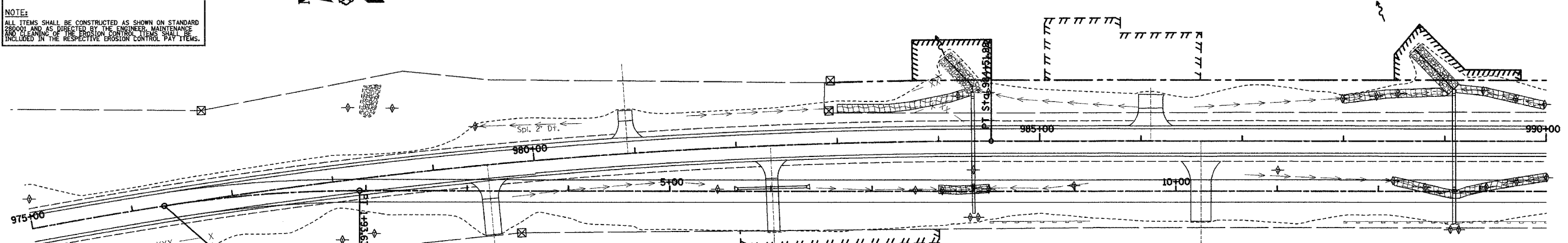
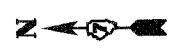

STA EQUATION:
 STA 0+00.00 (DETOUR No 1)=
 STA 976+31.94 (US 45)

DETOUR 1
 PI Sta. 0+97.02
 $\Delta = 9^\circ 01' 11''$ (RT)
 $D = 4^\circ 39' 29''$
 $T = 97.02'$
 $R = 1,230.00'$
 $L = 193.63'$
 $E = 3.82'$
 PC Sta. 0+00.00
 PT Sta. 1+93.63

FAP RTE 328 (US45)
 PI Sta. 972+65.57
 $\Delta = 26^\circ 35' 07''$ (RT)
 $D = 1^\circ 05' 59''$
 $T = 1,230.74'$
 $R = 5,209.39'$
 $L = 2,417.15'$
 $E = 143.41'$
 PC Sta. 960+34.84
 PT Sta. 984+51.99
 SE RATE= 3.70%
 SE ATTAINED:
 Sta. 983+80.39 to Sta. 986+40.39

FAP RTE 328 (US45)

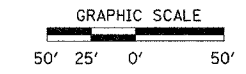

REVISIONS	
NAME	DATE

ILLINOIS DEPARTMENT OF TRANSPORTATION

EROSION CONTROL PLAN

SCALE: VERT. _____
 HORIZ. _____
 DATE 12/14/04

DRAWN BY UJ
 CHECKED BY JJC

12/14/04 12:42:06 PM