

F.A.P. RTE.	SECTION	COUNTY	TOTAL SHEETS	SHEET NO.
328	5R, Y, RS-1	CLAY	376	81
STA.		TO STA.		
FED. ROAD DIST. NO. 7 ILLINOIS		FED. AID PROJECT		
CONTRACT No 94367				

FAP RTE
 PI Sta. 1090+39.21
 $\Delta = 5^\circ 17' 19''$ (RT)
 $D = 1^\circ 05' 29''$
 $T = 242.43'$
 $R = 5,249.33'$
 $L = 484.52'$
 $E = 5.60'$
 PC Sta. 1087+96.83
 PT Sta. 1092+81.36
 SE RATE= 3.70%
 SE ATTAINED:
 Sta. 1086+08.43 to Sta. 1088+68.43
 Sta. 1092+09.76 to Sta. 1094+69.76

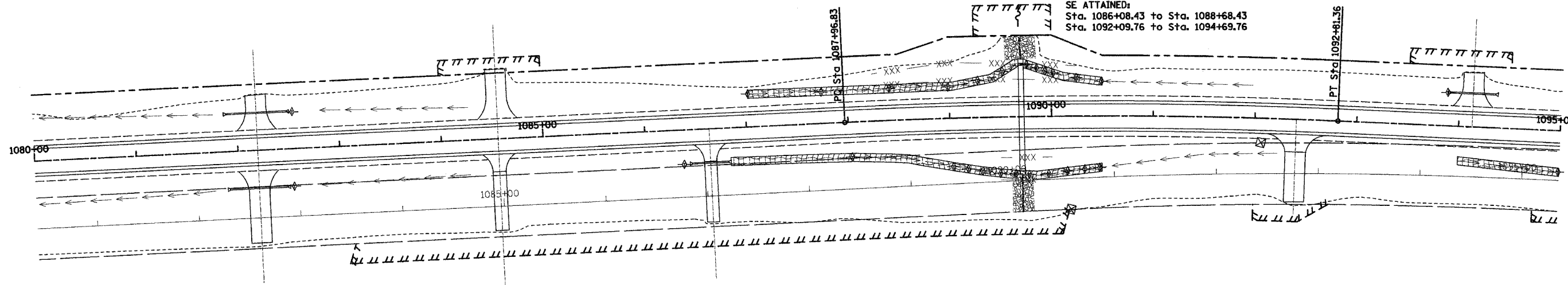

FAP RTE 328 (US45)

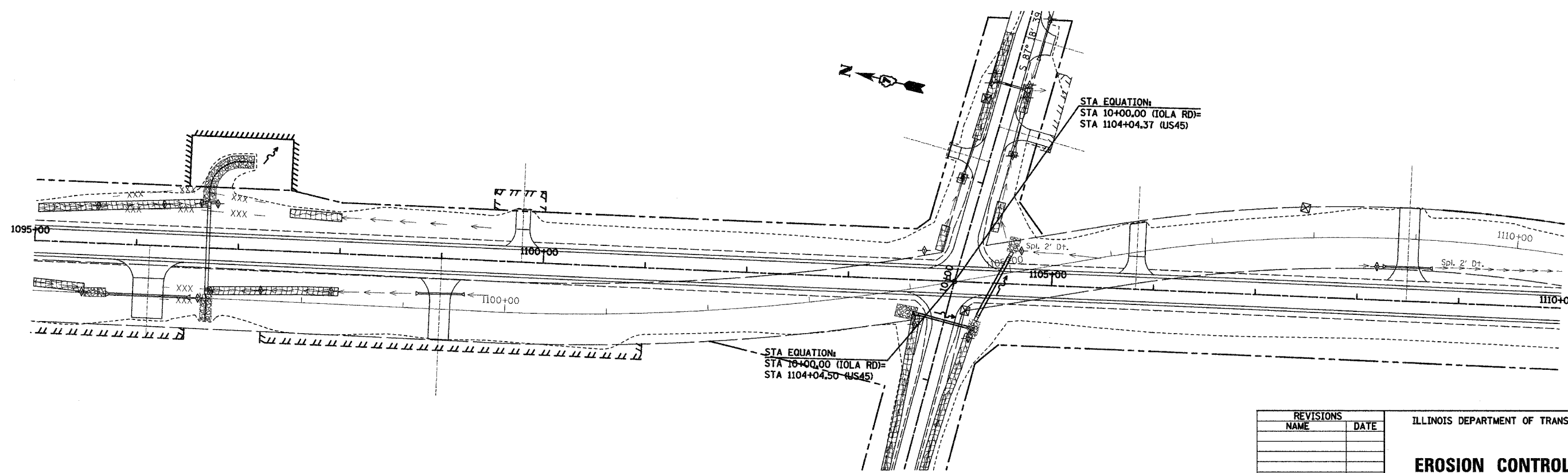

FAP RTE 328 (US45)

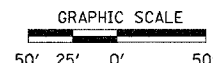

REVISIONS	
NAME	DATE

ILLINOIS DEPARTMENT OF TRANSPORTATION
EROSION CONTROL PLAN
 SCALE: VERT. _____
 HORIZ. _____
 DATE: 12/14/04
 DRAWN BY: UJ
 CHECKED BY: JJC

11/14/04 12:30:14 PM