

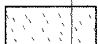

F.A. AVE.	SECTION	COUNTY	TOTAL SHEETS	SHEET NO.
328	5R, Y, RS-1	CLAY	376	98
STA.		TO STA.		
FED. ROAD DIST. NO.		ILLINOIS	FED. AID PROJECT	
CONTRACT No 94367				

**LEGEND**

-  TOPSOIL EXCAVATION
-  REMOVAL & DISPOSAL OF RESTRICTED SOIL (SEE EMBANKMENT SPL PROVISION)
-  PAVEMENT REMOVAL
-  PAVEMENT TO BE BROKEN & LEFT IN PLACE

PLOTTED TEMPLATE AREAS CHECKED  
 NOTE BOOK NO.

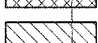
PLOTTED TEMPLATE AREAS CHECKED  
 NOTE BOOK NO.

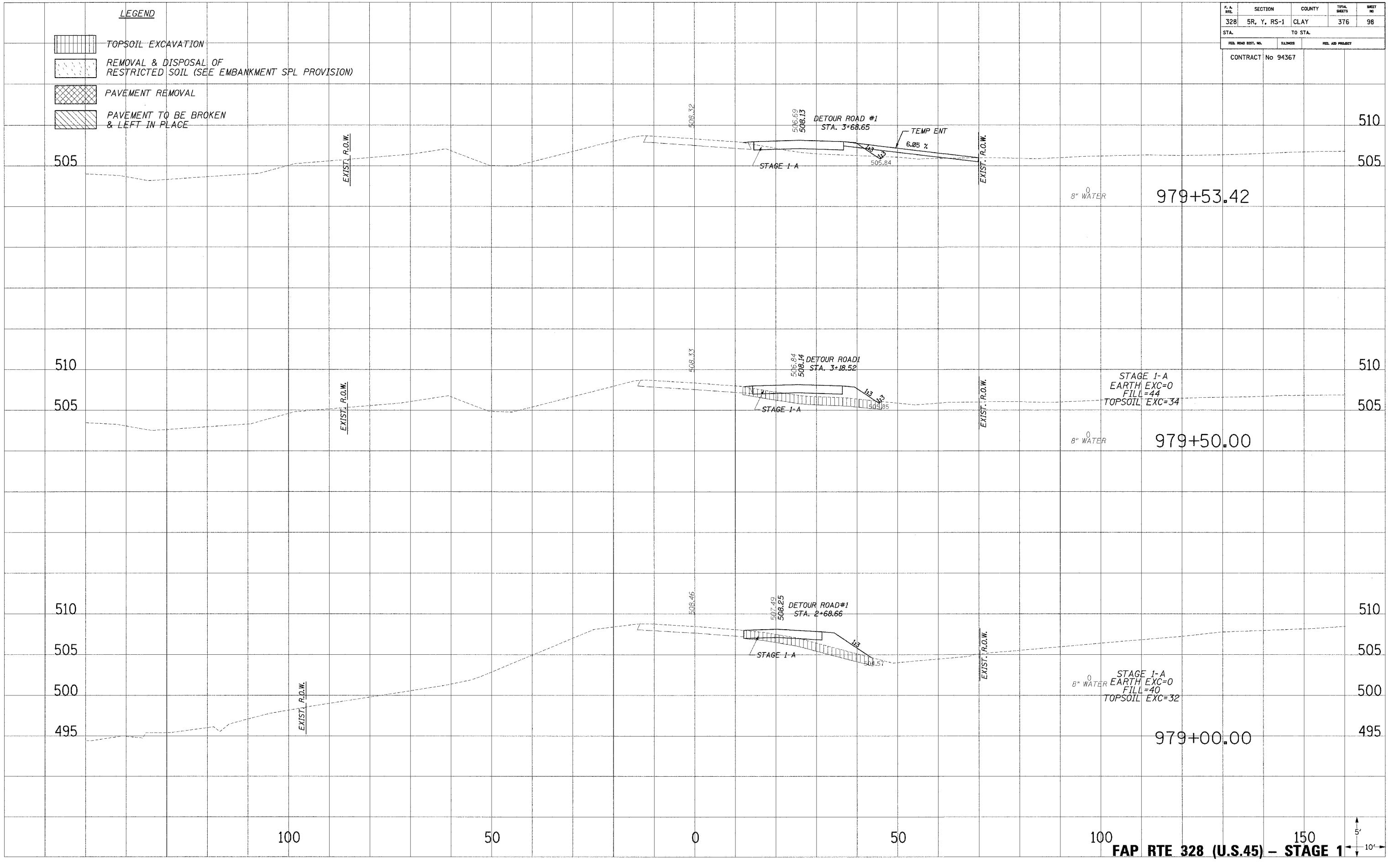

FAP RTE 328 (U.S.45) - STAGE 1

