

P.A.L. WTE.	SECTION	COUNTY	TOTAL SHEETS	SHEET NO.
24	*	**	189	109
STA. TO STA.				
FED. ROAD DIST. NO.		ILLINOIS	FED. AID PROJECT	
* X1-2,44(2,3,4)RS,BSMARTFY04-4				
** WILLIAMSON/JOHNSON				
CONTRACT NO. 98758				

LEGEND

- ⊕ MILE POST
- MP TREE REMOVAL
- ◇ EXISTING EARTH DITCH CHECK
- ◇ TEMPORARY DITCH CHECKS
- EXISTING DITCH FLOW
- x-x- WOVEN WIRE FENCE
- - - CLEARING OR GRADING LIMITS
- ⊠ INLET AND PIPE PROTECTION
- GENERAL CLEANING OF DITCH
- ▨ RIPRAP
- ▨ PERIMETER EROSION BARRIER
- ▨ FENCE (EROSION CONTROL)
- ▨ TEMPORARY EROSION CONTROL SEEDING
- ▨ EROSION CONTROL BLANKET
- ▨ HEAVY DUTY EXCELSIOR BLANKET

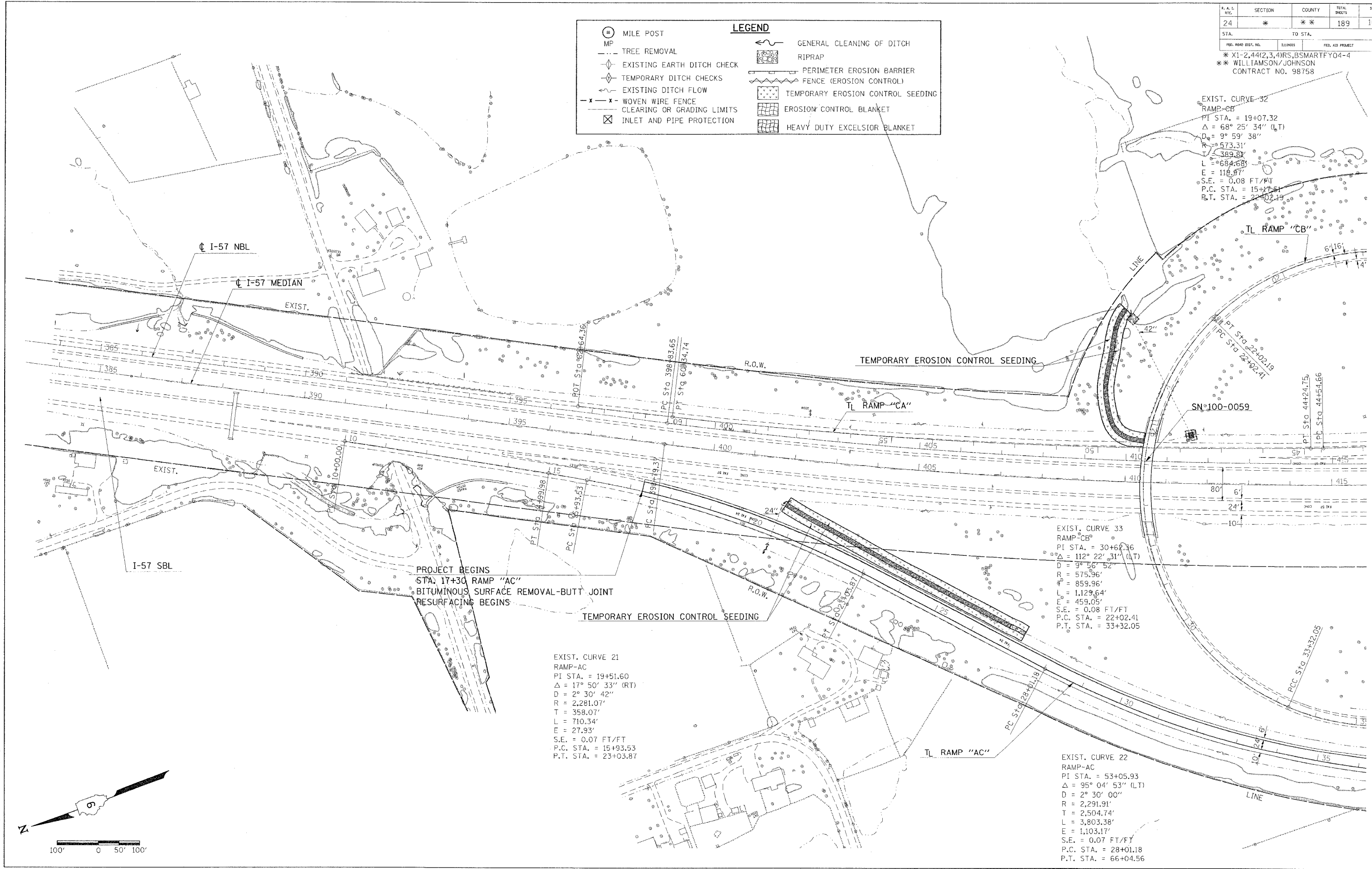

EXIST. CURVE 32
 RAMP-CB
 PI STA. = 19+07.32
 $\Delta = 68^\circ 25' 34''$ (LT)
 $D = 9^\circ 59' 38''$
 $R = 573.31'$
 $T = 389.81'$
 $L = 684.68'$
 $E = 118.87'$
 S.E. = 0.08 FT/FT
 P.C. STA. = 15+17.61
 P.T. STA. = 22+02.19

EXIST. CURVE 33
 RAMP-CB
 PI STA. = 30+62.36
 $\Delta = 112^\circ 22' 31''$ (LT)
 $D = 9^\circ 56' 52''$
 $R = 575.36'$
 $T = 859.96'$
 $L = 1,129.64'$
 $E = 459.05'$
 S.E. = 0.08 FT/FT
 P.C. STA. = 22+02.41
 P.T. STA. = 33+32.05

EXIST. CURVE 21
 RAMP-AC
 PI STA. = 19+51.60
 $\Delta = 17^\circ 50' 33''$ (RT)
 $D = 2^\circ 30' 42''$
 $R = 2,281.07'$
 $T = 358.07'$
 $L = 710.34'$
 $E = 27.93'$
 S.E. = 0.07 FT/FT
 P.C. STA. = 15+93.53
 P.T. STA. = 23+03.87

EXIST. CURVE 22
 RAMP-AC
 PI STA. = 53+05.93
 $\Delta = 95^\circ 04' 53''$ (LT)
 $D = 2^\circ 30' 00''$
 $R = 2,291.91'$
 $T = 2,504.74'$
 $L = 3,803.38'$
 $E = 1,103.17'$
 S.E. = 0.07 FT/FT
 P.C. STA. = 28+01.18
 P.T. STA. = 66+04.56

PROJECT BEGINS
 STA. 17+30 RAMP "AC"
 BITUMINOUS SURFACE REMOVAL-BUTT JOINT
 RESURFACING BEGINS

Wednesday, October 27, 2004 @ 8:03:29 AM
 c:\p\projects\9822182\102\102.dwg LVZ-A-3537-47-52-63
 PLANB C:\p\projects\9822182\102\102.dwg LVZ-A-3537-47-52-62
 PLANB C:\p\projects\9822182\102\102.dwg LVZ-A-3537-47-52-63