

EQ. 64' LT. PC Sta 6+09.57 BK. (TL RAMP "CA") =
STA. 118+90.43 AH (CL MEDIAN)

BM-1241 CHISELED "□" OVERHEAD SIGN TRUSS
FOUNDATION, 43' RT. STA. 118+93

F. A. I. NO.	SECTION	COUNTY	TOTAL SHEETS	SHEET NO.
24	*	**	189	111
STA.	TO STA.			
FED. ROAD DIST. NO.	ELLIGES	FED. AID PROJECT		
* X1-2,44(2,3,4)RS,BSMARTFY04-4				
** WILLIAMSON/JOHNSON				
CONTRACT NO. 98758				

EXIST. CURVE 23
RAMP-CA
PI STA. = 27+65.01
 $\Delta = 66^\circ 32' 07''$ (RT)
D = 1° 44' 38"
R = 3,285.38'
T = 2,155.44'
L = 3,815.18'
E = 643.95'
S.E. = 0.05 FT/FT
P.C. STA. = 6+09.57
P.T. STA. = 44+24.75

EXIST. CURVE 18
RAMP-BC
PI STA. = 19+86.14
 $\Delta = 120^\circ 16' 42''$ (RT)
D = 7° 29' 58"
R = 764.00'
T = 1,330.74'
L = 1,603.83'
E = 770.46'
S.E. = 0.08 FT/FT
P.C. STA. = 6+55.40
P.T. STA. = 22+59.23

BM-1414 N.W. BOLT IN N. LEG OF EXIT 44 AND I-24
OVERHEAD SIGN TRUSS, STA. 457+00 I-57

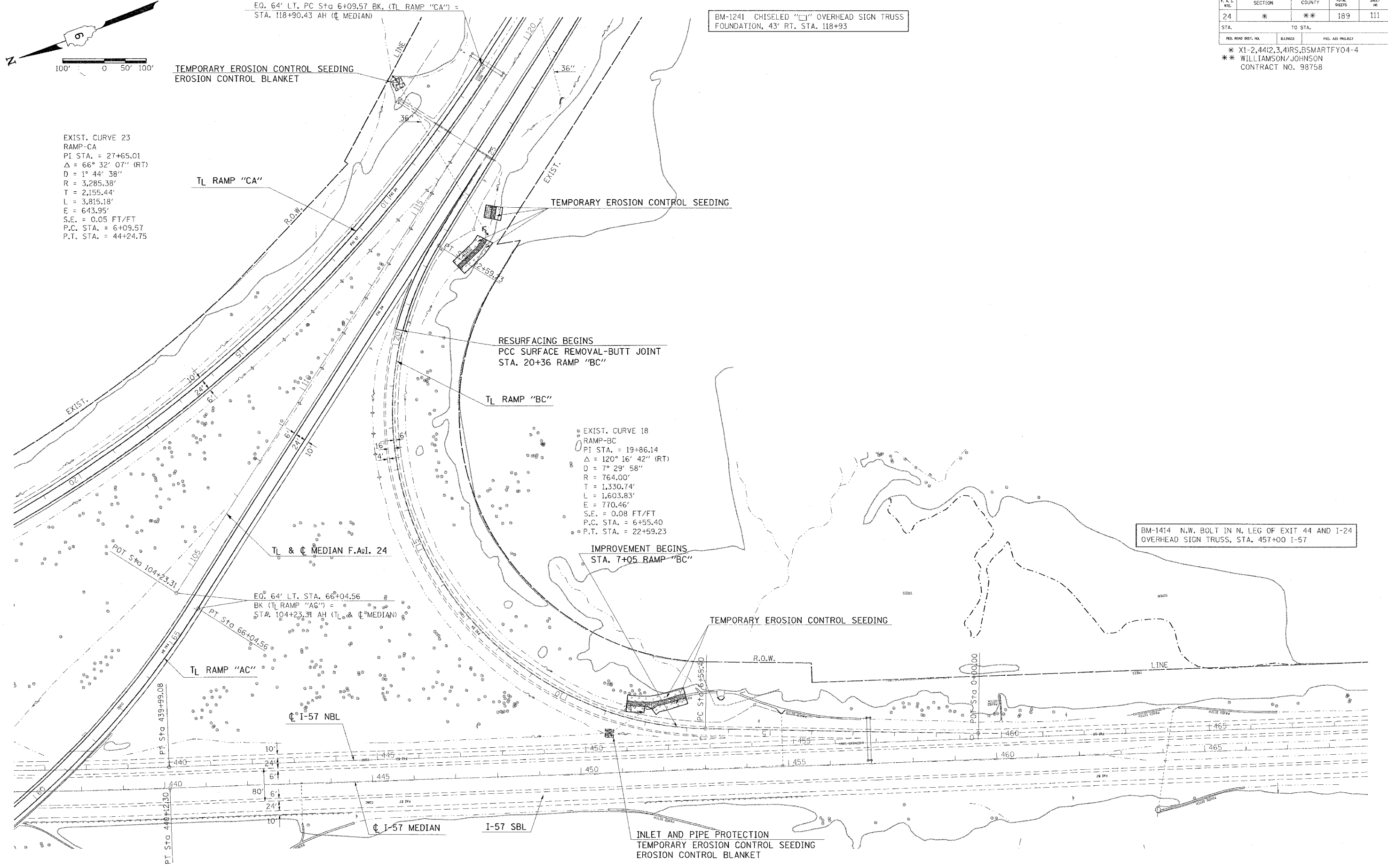

Wednesday, October 27, 2004 @ 10:29:11 AM
 C:\Program Files\AutoCAD 2004\acad2004\acad2004.dwg
 PLINE: C:\Program Files\AutoCAD 2004\acad2004\acad2004.dwg
 PLIN: C:\Program Files\AutoCAD 2004\acad2004\acad2004.dwg
 PLIN: C:\Program Files\AutoCAD 2004\acad2004\acad2004.dwg

TEMPORARY EROSION CONTROL F.A.I. - 24 / I - 57 INTERCHANGE