

F.A.I. REF.	SECTION	COUNTY	TOTAL SHEETS	SHEET NO.
24	*	**	189	115
STA. FROM		TO STA.		
FED. ROAD DIST. NO.		MILEMKS		FED. AID PROJECT
* X1-2.44(2,3,4)RS,BSMARTFY04-4 ** WILLIAMSON/JOHNSON CONTRACT NO. 98758				

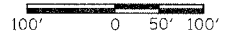

EXIST. CURVE 44
 P.I. STA. = 1342+21.97
 $\Delta = 5^\circ 59' 20''$ (LT)
 $D = 0^\circ 20' 15''$
 $R = 16,973.76'$
 $T = 887.89'$
 $L = 1,774.16'$
 $E = 23.21'$
 S.E. = NORMAL CROWN
 P.C. STA. = 1333+34.08
 P.T. STA. = 1351+08.24

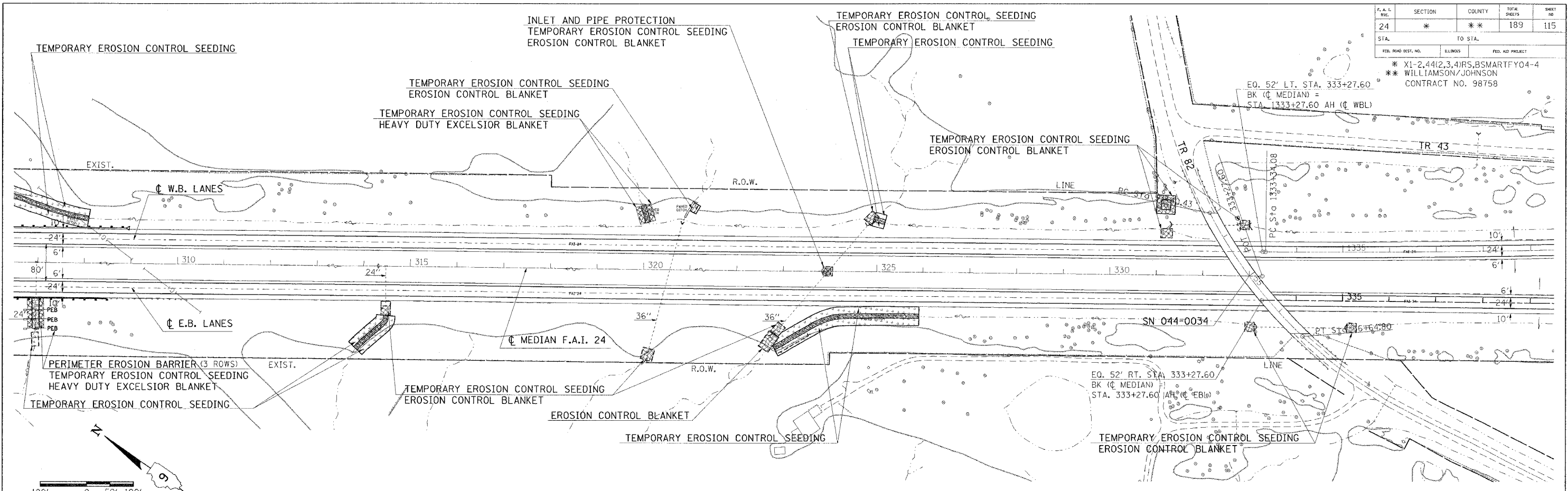
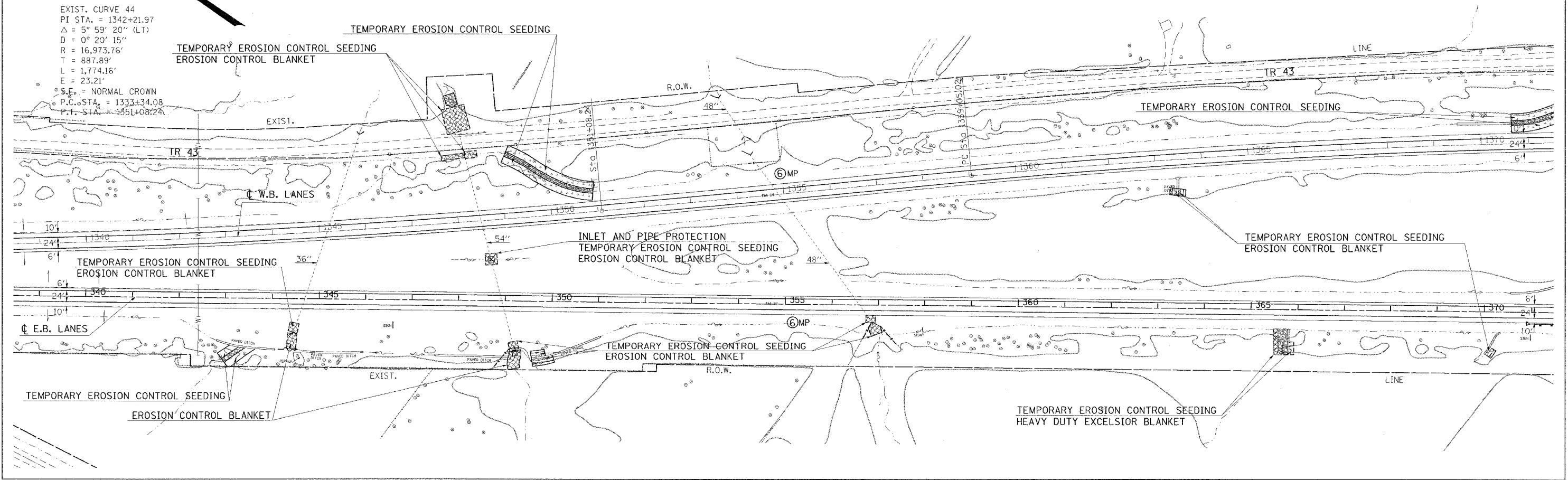

TEMPORARY EROSION CONTROL STA. 307+00 TO STA. 371+00

Wednesday, October 27, 2004 4:24:55 PM
 c:\projects\982102\982102.dwg LV:2,4-35,37-47,52-63
 107AA c:\projects\982102\982102.dwg LV:1,2,3,5,37-47,51-62
 107TP c:\projects\982102\982102.dwg LV:1,2,3,5,37-47,51-62