

TEMPORARY BENCH MARKS		
B.M.	ELEV.	DESCRIPTION
TBM L	582.59	CHIS. □, S. EDGE OF 1ST RWNY LIGHT, SE. OF MID-FIELD, S. SIDE OF RWNY 5, STATION 48+77, RT. 86°
TBM XX	581.63	CHIS. □, TXWY C HOLD SIGN, N. SIDE OF RWNY 5, STATION 53+88, LT. 200°

PROPOSED CONSTRUCTION SEEDING AND GRADING LIMITS

STA. 155+50, MEET EXTG., SAW CUT

LEGEND:

	EDGE LIGHT
	GUIDANCE SIGN
	ELECTRICAL CABLE
	STORM SEWER OR UNDERDRAIN
	INLET
	OUTLET
	STORM MANHOLE
	ELECTRICAL MANHOLE
	DRAINAGE DITCH
	CONDUIT OR DUCT BANK
	PROPOSED PAVEMENT MILLING
	PROPOSED PAVEMENT REMOVAL

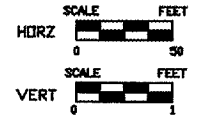

- NOTES:
- MILL EXISTING PAVEMENT TO A POINT THAT IS BOTH:
 - AT LEAST 0.10' BELOW THE EXISTING PAVEMENT AND
 - AT LEAST 0.20' BELOW THE PROPOSED PAVEMENT.
 - THE CONTRACTOR SHALL INSTALL TEMPORARY TRANSITION RAMPS ON ALL TRANSVERSE AND LONGITUDINAL CONSTRUCTION JOINTS ON RUNWAY 9-27 AT THE END OF EACH NIGHT SHIFT.
 - THE CONTRACTOR SHALL INSTALL GUIDE WIRES AND UTILIZE AN AUTOMATIC GRADE CONTROL SYSTEM TO INSTALL THE OVERLAY.

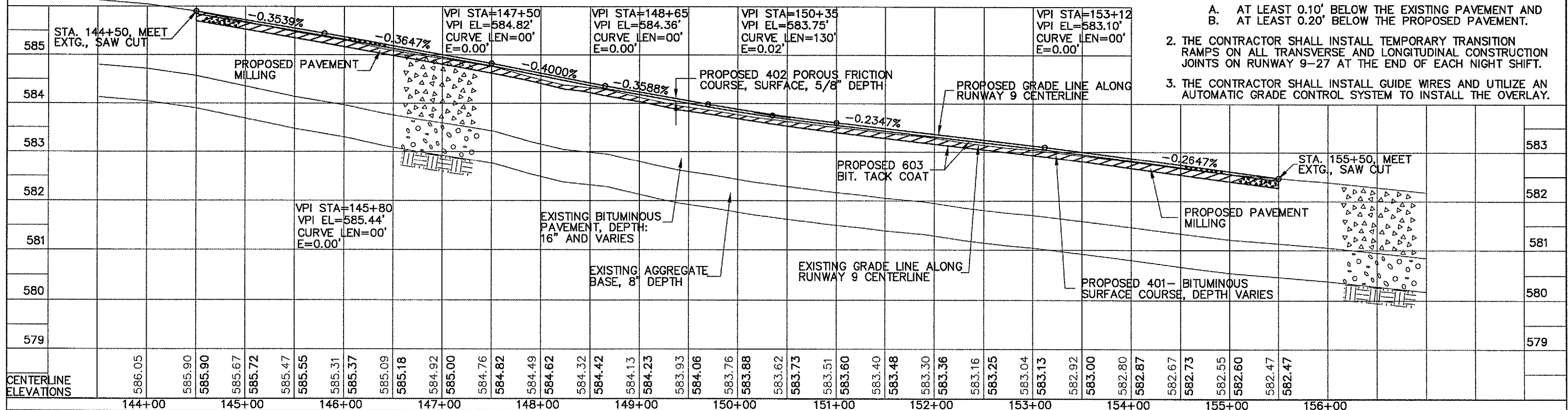

RUNWAY 9-27 PLAN & PROFILE STA 144+00 TO STA 156+00 17/63