

STAGE 1 SUB 1 - PHASE 1  
 STA. 8+00.00 TO STA. 15+00.00  
 ③\* TEMPORARY CONCRETE BARRIER FROM  
 STA. 11+54.63 TO STA. 13+45.15

LEGEND

- ① TEMPORARY PAVEMENT (SEE SPECIAL PROVISION)
- ② TYPE II BARRICADES WITH STEADY BURNING LIGHTS  
(50 FT C-C TANGENTS, 25 FT C-C @ TAPERS  
& 12 FT C-C ALONG RADII)
- ③ VERTICAL PANELS WITH STEADY BURNING LIGHTS  
@ 50 FT C-C
- ④ WET TEMPORARY PAVEMENT MARKING TAPE
- ⑤ VERTICAL BARRICADES WITH STEADY BURNING LIGHTS  
(50 FT C-C @ TANGENTS, 25 FT C-C @ TAPERS  
& 12 FT C-C ALONG RADII)

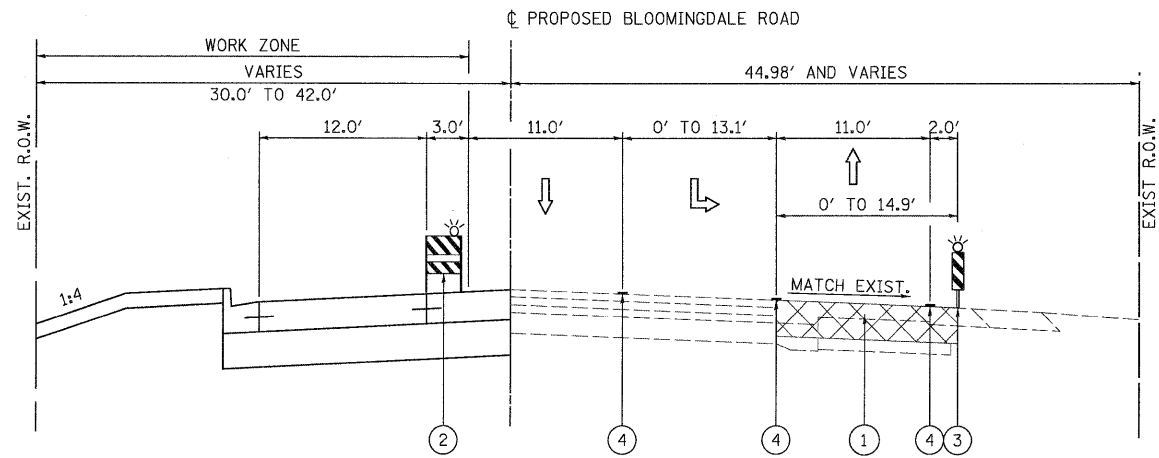

STAGE 1 SUB 1 - PHASE 1  
 STA. 15+00.00 TO STA. 19+70.78

PATRICK ENGINEERING INC. 4870 VARSITY DRIVE LISLE, IL 60532 patrickengineering.com	USER NAME = okersten@lisle.RI PLOT CONFIG = PDF(Greg_Large).plt PLOT SCALE = 1/6.66667 PLOT DATE = 12/3/2010	DESIGNED - MJV DRAWN - EJB CHECKED - CPK DATE - 12/3/2010	REVISED - REVISED - REVISED - REVISED -	Illinois Department of Transportation	<b>NORDIC ROAD / BLOOMINGDALE ROAD          SUGGESTED MAINTENANCE OF TRAFFIC          TYPICAL SECTIONS - STAGE 1 SUB 1 PHASE 1</b>		F.A. RTE. 2578	SECTION 532B	COUNTY DUPAGE	TOTAL SHEETS 781	SHEET NO. 135
	SCALE: 1"=50'		SHEET MOT-29 OF 136		STA. TO STA.	CONTRACT NO. 60477			FED. ROAD DIST. NO. ILLINOIS FED. AID PROJECT		