

STAGE 1 SUB 2 - PHASE 1
 STA. 8+00.00 TO STA. 15+00.00
 (3) TEMPORARY CONCRETE BARRIER FROM
 STA. 11+54.63 TO STA. 13+45.15

LEGEND

- (1) TEMPORARY PAVEMENT (SEE SPECIAL PROVISION)
- (2) TYPE II BARRICADES WITH STEADY BURNING LIGHTS (50 FT C-C TANGENTS, 25 FT C-C @ TAPERS & 12 FT C-C ALONG RADII)
- (3) VERTICAL PANELS WITH STEADY BURNING LIGHTS @ 50 FT C-C
- (4) WET TEMPORARY PAVEMENT MARKING TAPE
- (5) VERTICAL BARRICADES WITH STEADY BURNING LIGHTS (50 FT C-C @ TANGENTS, 25 FT C-C @ TAPERS & 12 FT C-C ALONG RADII)

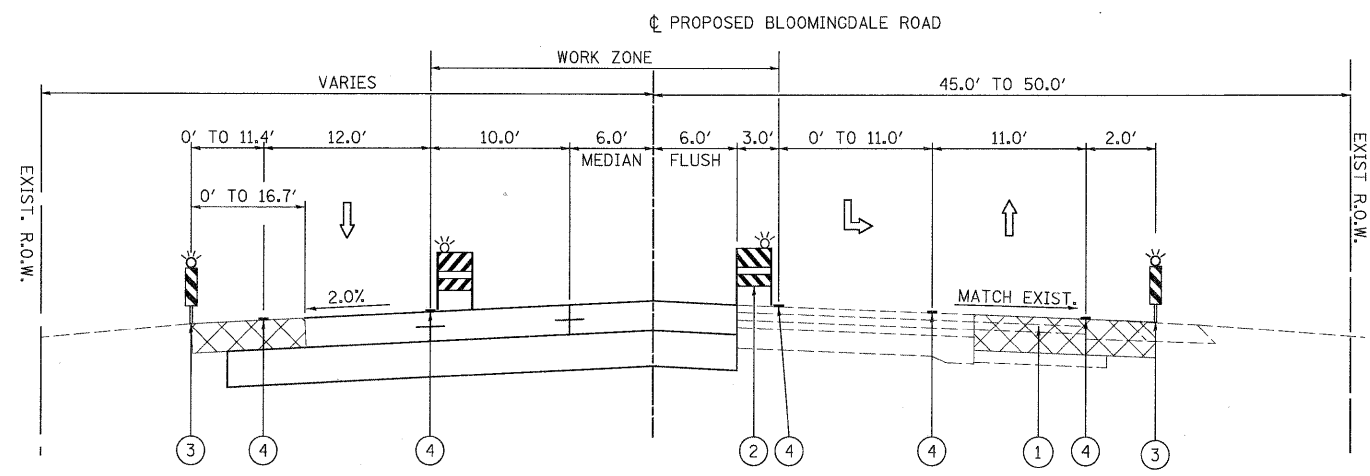

STAGE 1 SUB 2 - PHASE 1
 STA. 15+00.00 TO STA. 19+70.78

PATRICK ENGINEERING INC. 4970 VARSITY DRIVE LISLE, IL 60532 patrickengineering.com	USER NAME = ckersten(Lisle_R) PLOT CONFIG = PDF(Grey_Large).plt PLOT SCALE = 1:6.66667 PLOT DATE = 12/3/2010	DESIGNED - MJV DRAWN - EJB CHECKED - CPK DATE - 12/3/2010	REVISED - REVISED - REVISED - REVISED -	Illinois Department of Transportation	NORDIC ROAD /BLOOMINGDALE ROAD SUGGESTED MAINTENANCE OF TRAFFIC TYPICAL SECTIONS - STAGE 1 SUB 2 PHASE 1		F.A. RTE. 2578 SECTION 532B COUNTY DUPAGE TOTAL SHEETS 781 SHEET NO. 136	CONTRACT NO. 60477
	SCALE: 1"=50' SHEET MOT-30 OF 136 STA. TO STA.				FED. ROAD DIST. NO. ILLINOIS FED. AID PROJECT			

G:\DOT\9356.AB (IL 53)\Drawings\CA00 Sheets\019139797-sht-stagingtypical_110-171.dgn