

ADVANCE SIGNING DETAIL:

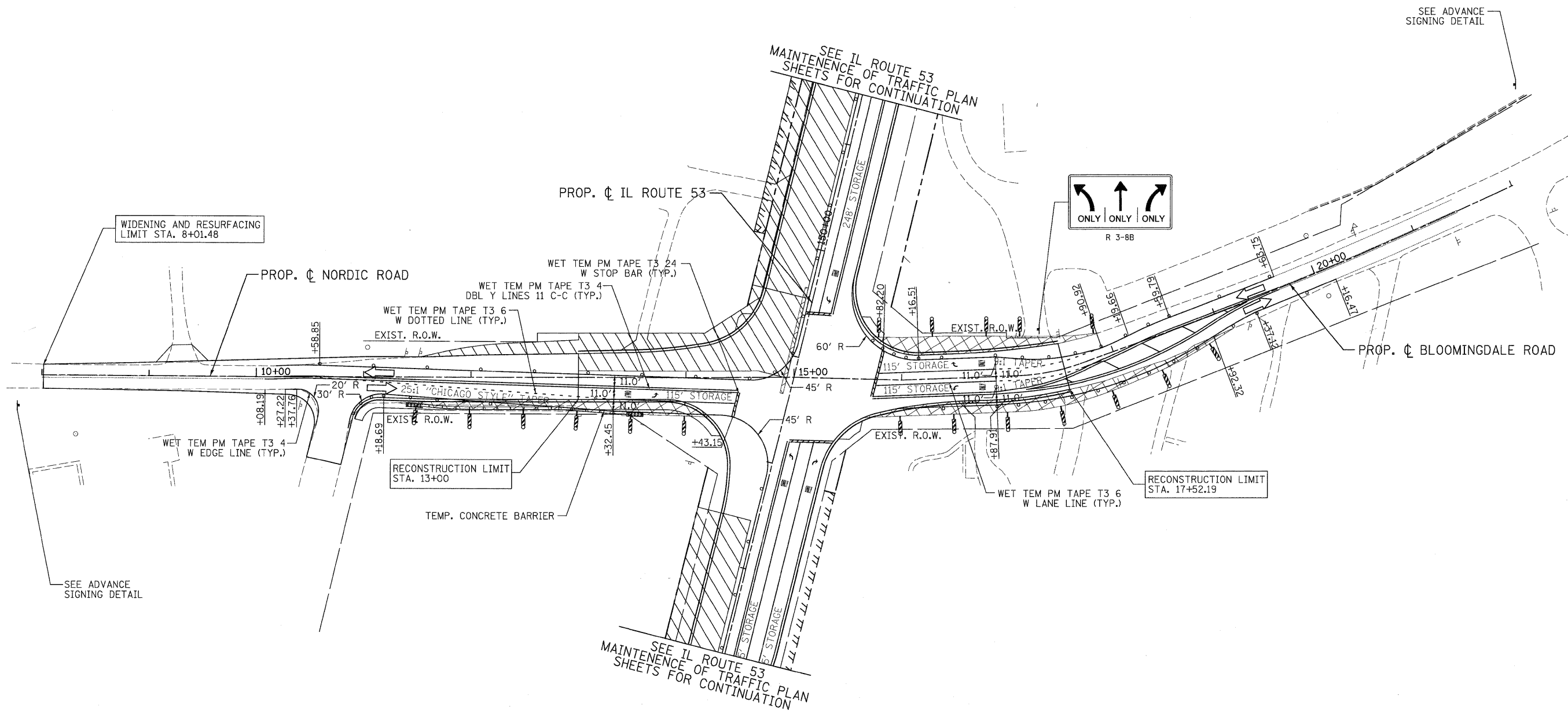

W20-1(O)-48
48 x 48 In.



LEGEND

	TEMPORARY PAVEMENT		TYPE II BARRICADES OR DRUMS WITH STEADY BURNING LIGHTS @ 50 FT CENTERS ALONG ROADWAY (TANGENT), 25 FT CENTERS ALONG TAPERS AND 12 FT CENTERS ALONG RADII		VERTICAL PANEL WITH STEADY BURNING LIGHT 50 FT C-C
	WORK ZONE		TYPE III BARRICADES WITH FLASHING LIGHTS		DIRECTION OF TRAFFIC
	ARROW BOARD				

PATRICK ENGINEERING INC. 4970 VARSITY DRIVE LISLE, IL 60532 patrickengineering.com	USER NAME = akersten@lisle.ri	DESIGNED - MJV	REVISED -
	PLOT CONFIG = PDFI@reg_large.plt	DRAWN - MJV	REVISED -
	PLOT SCALE = 1:50	CHECKED - JJC	REVISED -
	PLOT DATE = 12/3/2010	DATE - 12/3/2010	REVISED -

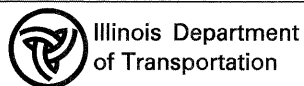

NORDIC ROAD/BLOOMINGDALE ROAD
SUGGESTED STAGES OF CONSTRUCTION & TRAFFIC CONTROL
STAGE 2 SUB-STAGE 3 PHASE 1

SCALE: 1"=50' SHEET MOT-93 OF 136 STA. TO STA.

F.A. RTE.	SECTION	COUNTY	TOTAL SHEETS	SHEET NO.
2578	532B	DUPAGE	781	199
FED. ROAD DIST. NO. ILLINOIS FED. AID PROJECT			CONTRACT NO. 60477	