

LEGEND:

	TOPSOIL FURNISH AND PLACE, 4" SODDING, SALT TOLERANT NITROGEN AND POTASSIUM FERTILIZER NUTRIENT		TOPSOIL FURNISH AND PLACE, 8" SEEDING, CLASS 4 EROSION CONTROL BLANKET (ADJACENT TO WETLANDS)
	TOPSOIL FURNISH AND PLACE, 24" SEEDING, CLASS 2A NITROGEN AND POTASSIUM FERTILIZER NUTRIENT EROSION CONTROL BLANKET		TOPSOIL FURNISH AND PLACE, 12" COMPOST FURNISH AND PLACE, 2" (NOISE WALL LOCATIONS, SEE VINE PLANTING DETAIL)
	TOPSOIL FURNISH AND PLACE, 6" SEEDING, CLASS 4 EROSION CONTROL BLANKET		

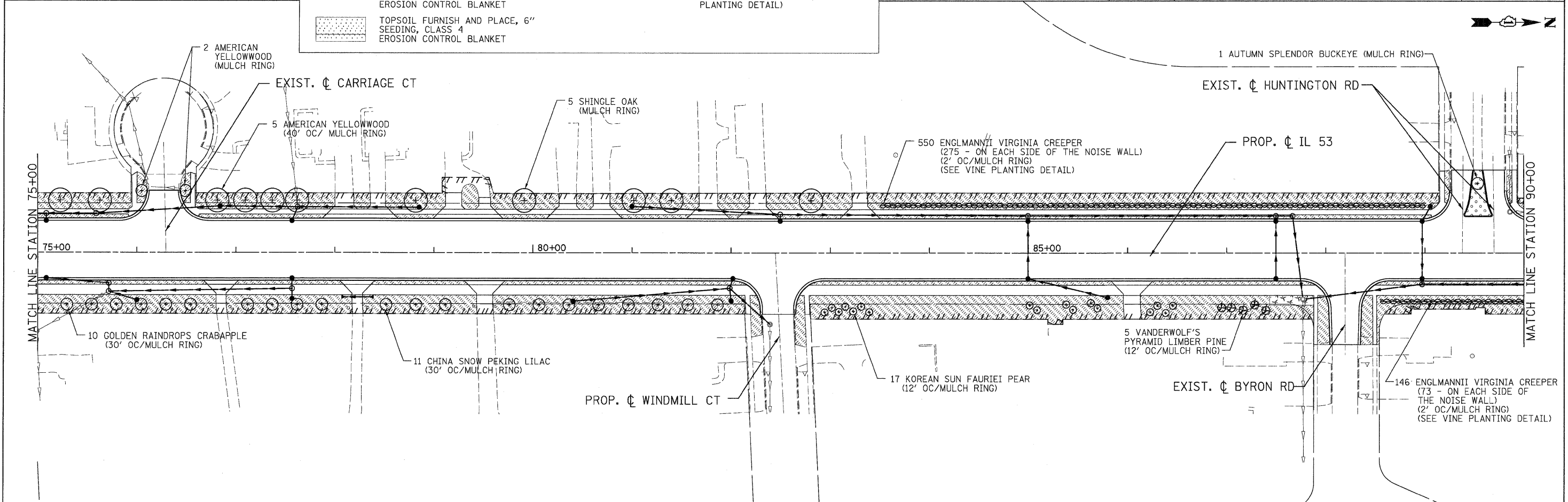

 PATRICK ENGINEERING INC. 4970 VARSITY DRIVE LISLE, IL 60532 patrickengineering.com	USER NAME = Rdey.Lisle	DESIGNED - D. DOERFLER	REVISED -	 Illinois Department of Transportation	ILLINOIS ROUTE 53 LANDSCAPING DETAILS		F.A.U. RTE. 2578	SECTION 532B	COUNTY DUPAGE	TOTAL SHEETS 781	SHEET NO. 337
	PLOT CONFIG= PDFI@reg.Large.plt	DRAWN - C. HELLAND	REVISED -		SCALE: 1"=50'	SHEET LCPE-2 OF 13	STA. 60+00 TO STA. 90+00	FED. ROAD DIST. NO. [ILLINOIS] FED. AID PROJECT		CONTRACT NO. 60477	
	PLOT SCALE = 1:50	CHECKED - A. JAMES	REVISED -								
	PLOT DATE = 12/3/2010	DATE - 12/3/2010	REVISED -								

G:\IDOT\9356_A0_ILL53\Drawings\CADD Sheets\DI9139797-sht-1\discp_337.dgn