

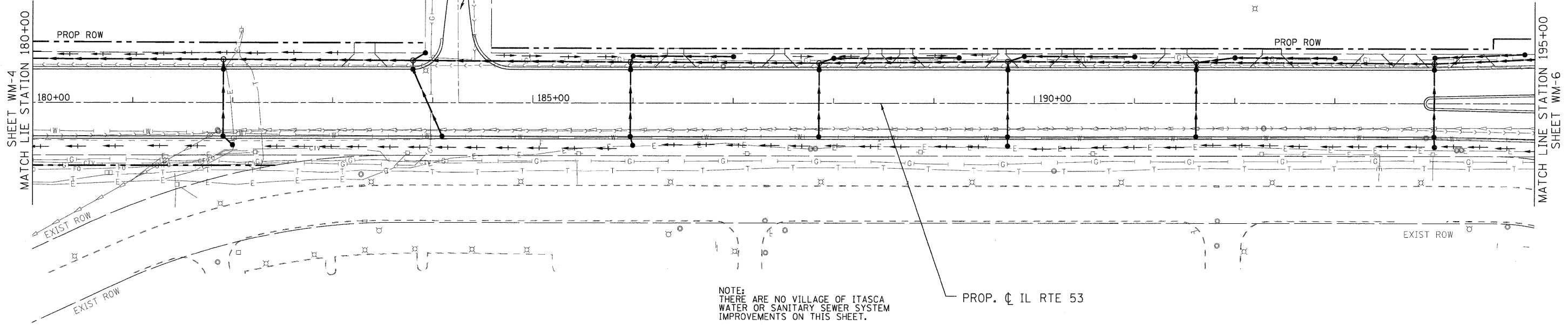

RECONSTRUCTION LIMIT
O/S = 111.62' LT

EXIST. ϕ WOODVIEW DR



NOTE:
THERE ARE NO VILLAGE OF ITASCA
WATER OR SANITARY SEWER SYSTEM
IMPROVEMENTS ON THIS SHEET.

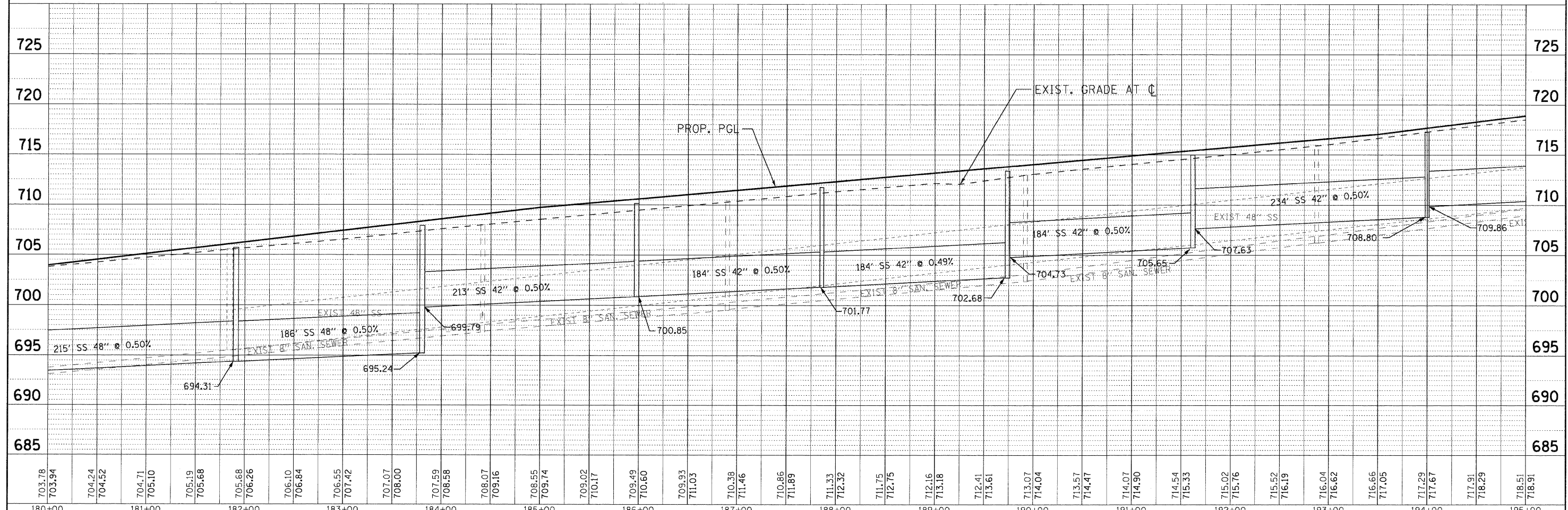

PLAN	DATE
NO.	BY
NO.	DATE
NO.	DATE
NO.	DATE

PROFILE	DATE
NO.	BY
NO.	DATE
NO.	DATE
NO.	DATE

	USER NAME = (username) PLOT CONFIG = PDF22X34.plt PLOT SCALE = 1:50 PLOT DATE = 11/24/2010 8:42:53 AM	DESIGNED - SMV DRAWN - UKB CHECKED - SMV DATE - 7-30-2010	REVISED - REVISED - REVISED - REVISED -		ILLINOIS ROUTE 53 WATER AND SEWER REPLACEMENT PLAN AND PROFILE		F.A.U. RTE. 2578 SECTION 532B COUNTY DUPAGE TOTAL SHEETS 781 SHEET NO. 353	CONTRACT NO. 60477
	SCALE: 1"=50'		SHEET NO. WM-5 OF 17		STA. 180+00 TO STA. 195+00	FED. ROAD DIST. NO. ILLINOIS FED. AID PROJECT		

\\Crystal Lake\1\ASV\100547-Rt 53 W and SXCADD-SURVEY\DRAWINGS\GDNS\B&W-WM-PP-shr.266.dgn