

Sections 19, 25 & 30, Township 40 North, Range 11 East of the 3rd P.M., DuPage County, Illinois

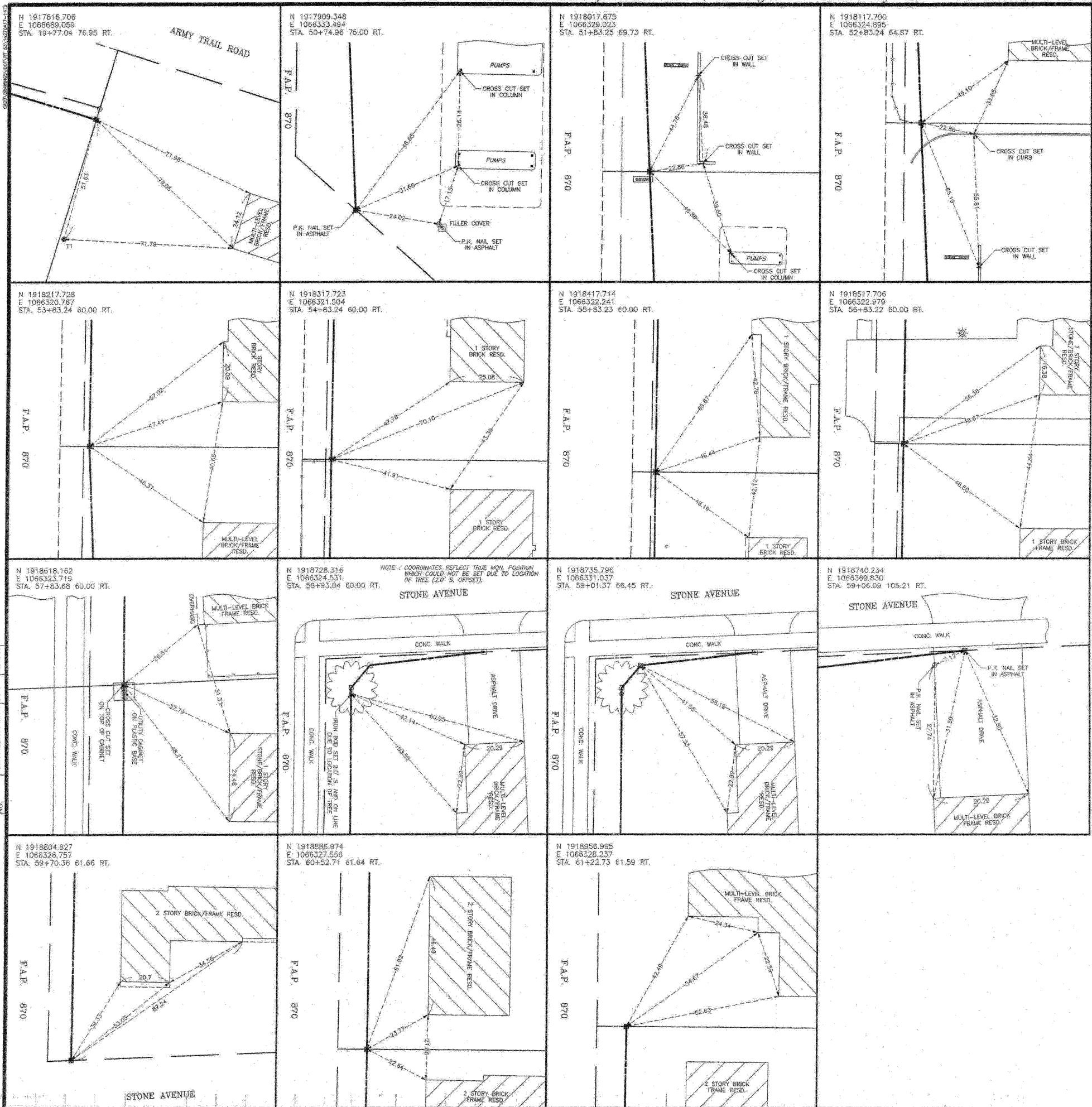

- LEGEND**
- SECTION LINE
  - QUARTER SECTION LINE
  - QUARTER, QUARTER SECTION LINE
  - PLATTED LOT LINE
  - PROPERTY (DEED) LINE
  - A.P.L. APPARENT PROPERTY LINE
  - CENTER LINE
  - EXISTING RIGHT-OF-WAY LINE
  - PROPOSED RIGHT-OF-WAY LINE
  - PROPOSED EASEMENT
  - 129.32' MEASURED DIMENSION
  - 129.32' (COMP) COMPUTED DIMENSION
  - (129.32') RECORD DATA
  - [Hatched Box] EXISTING BUILDING
  - Q IRON PIPE OR ROD FOUND
  - + CUT CROSS FOUND OR SET
  - T1 THESE STAKES REFERENCE FOUND OR SET MONUMENTATION. SET 5/8 INCH IRON ROD FLUSH WITH GROUND TO TIE FOUND IRON STAKE, IDENTIFIED BY COLORED PLASTIC CAP BEARING SURVEYORS REGISTRATION NUMBER.
  - T2
  - T3
  - BT1 THESE STAKES, IN CULTIVATED AREAS, REFERENCE FOUND OR SET MONUMENTATION. BURIED 5/8 INCH IRON ROD 20 INCHES BELOW GROUND TO THE FOUND IRON STAKE, IDENTIFIED BY COLORED PLASTIC CAP BEARING SURVEYORS REGISTRATION NUMBER.
  - BT2
  - BT3
  - STAKING OF PROPOSED RIGHT-OF-WAY. SET DIVISION OF HIGHWAYS SURVEY MARKER TO MONUMENT THE POSITION SHOWN, IDENTIFIED BY INSCRIPTION DATA AND SURVEYORS REGISTRATION NUMBER.
  - M STAKING OF PROPOSED RIGHT-OF-WAY IN CULTIVATED AREAS. BURIED 5/8 INCH METAL ROD 20 INCHES BELOW GROUND TO MARK FUTURE SURVEY MARKER POSITION. IDENTIFIED BY COLORED PLASTIC CAP BEARING SURVEYORS REGISTRATION NUMBER.
  - ⊕ PERMANENT SURVEY MARKER, I.D.O.T. STD. 21.35 (TO BE SET BY OTHERS)
  - RIGHT-OF-WAY STAKING PROPOSED TO BE SET

STATE OF ILLINOIS  
 COUNTY OF DUPAGE

THIS IS TO CERTIFY THAT I, DOMINIC J. MARCHESE, AN ILLINOIS PROFESSIONAL LAND SURVEYOR, HAVE SURVEYED THE PLAT OF HIGHWAYS SHOWN HEREON BETWEEN SECTION 25, TOWNSHIP 40 NORTH, RANGE 11 EAST AND SECTION 19, TOWNSHIP 40 NORTH, RANGE 11 EAST OF THE THIRD PRINCIPAL MERIDIAN. COUNTY OF DUPAGE, ILLINOIS. THAT THE SURVEY IS TRUE AND COMPLETE AS SHOWN TO THE BEST OF MY KNOWLEDGE AND BELIEF; THAT THE PLAT CORRECTLY REPRESENTS SAID SURVEY, THAT ALL MONUMENTS FOUND AND ESTABLISHED ARE OF PERMANENT QUALITY AND OCCUPY THE POSITIONS SHOWN THEREON AND THAT THE MONUMENTS ARE SUFFICIENT TO ENABLE THE SURVEY TO BE RETRACED. MADE FOR THE DEPARTMENT OF TRANSPORTATION, STATE OF ILLINOIS.



DATED AT ROSELLE, ILLINOIS THIS 18th DAY OF APRIL, 2009 A.D.

*Dominic J. Marchese*  
 ILLINOIS REGISTERED PROFESSIONAL LAND SURVEYOR NO. 2335  
 MY CURRENT LICENSE EXPIRES ON NOVEMBER 2010  
 THIS PROFESSIONAL SERVICE CONFORMS TO THE CURRENT ILLINOIS MINIMUM STANDARDS FOR A BOUNDARY SURVEY.



**COORDINATE VALUES**

COORDINATES AND BEARINGS ARE REFERENCED TO THE ILLINOIS STATE PLANE COORDINATE SYSTEM AT CONTROL. POINTS SUPPLIED BY THE ILLINOIS DEPARTMENT OF TRANSPORTATION. ALL COORDINATES SHOWN HEREON ARE GROUND POSITIONS.

RECEIVED  
 SEP 16 2009  
 PLATS & LEGALS

**WITNESS SKETCHES**  
 STATE OF ILLINOIS  
 DEPARTMENT OF TRANSPORTATION  
 F.A.P. 870 (IL 53)

SECTION : \_\_\_\_\_ DUPAGE COUNTY  
 PROJECT : \_\_\_\_\_ JOB NO.: R-91-069-00  
 STATION : 19+77.04 TO STATION : 61+22.75  
 SCALE : (NOT TO SCALE) SHEET : A17 of A17

BUREAU OF LAND ACQUISITION  
 201 WEST CENTER COURT  
 SCHAUMBURG, ILLINOIS 60196-1096

Marchese and Sons, Inc.  
 NUMBER 184-002782  
 land - marine - construction surveys  
 10 HONKOG DRIVE, ROSELLE, IL 60772  
 PHONE : (630) 894-9800 FAX : (630) 384-8869