

SIGNAL HEAD PLACEMENTS FOR
STAGE: S2

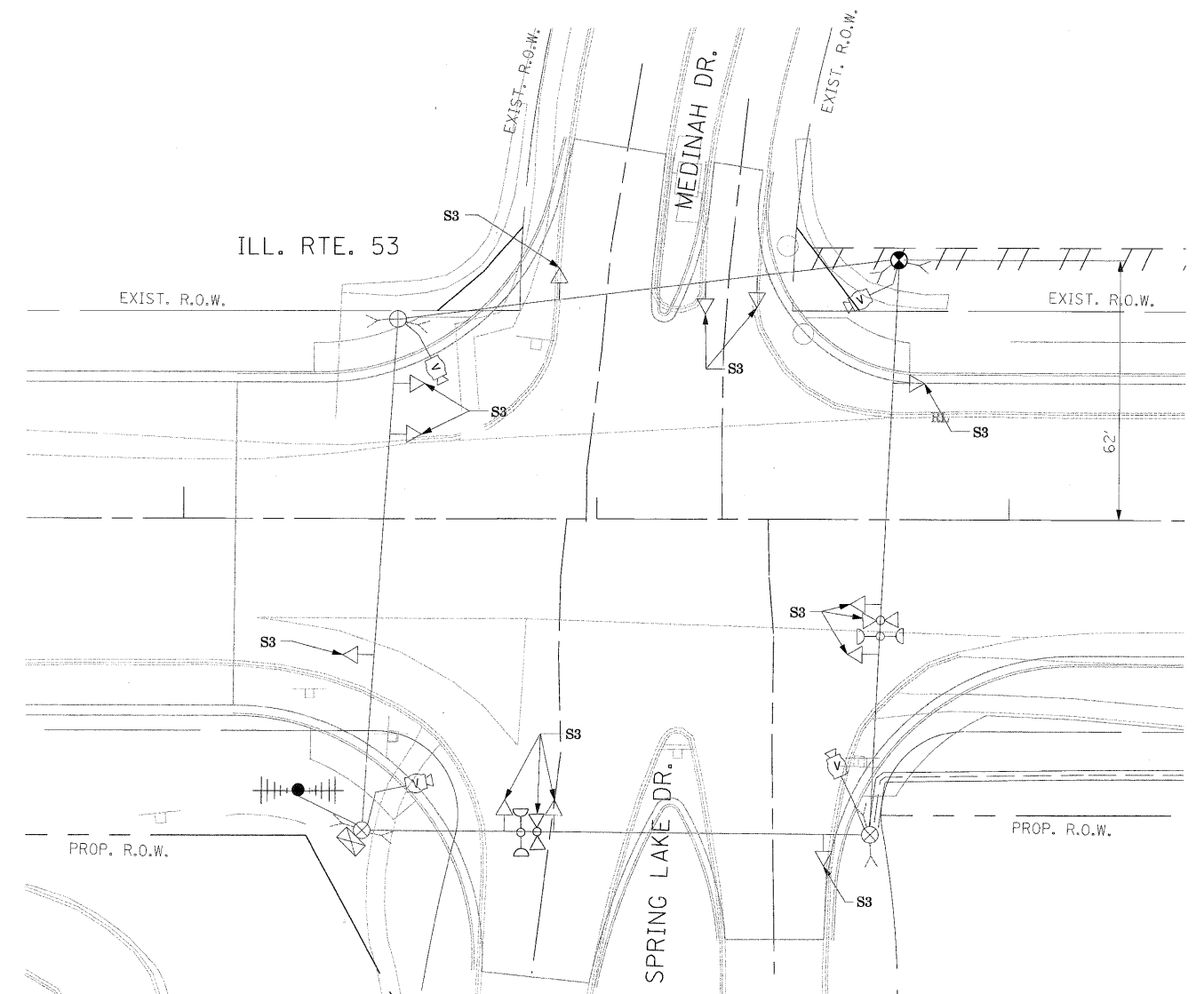

SIGNAL HEAD PLACEMENTS FOR
STAGE: S3

NOTE 1: THE VIDEO DETECTION ZONES SHOWN ON THE PLANS ARE FOR CONSTRUCTION STAGE 1 - YEAR 2 AND SHALL BE REDEFINED FOR EACH CONSTRUCTION STAGE AS A PART OF "TEMPORARY TRAFFIC SIGNAL INSTALLATION" WORK.

NOTE 2: THE SIGNAL HEAD PLACEMENT FOR MEDINAH/SPRING LAKE DRIVE FOR CONSTRUCTION STAGES S2 AND S3 SHALL BE DETERMINED IN FIELD BY THE CONTRACTOR DEPENDING ON THE CONSTRUCTION STAGING USED BY THE CONTRACTOR FOR MEDINAH/SPRING LAKE DRIVE.

THE TRAFFIC SIGNAL CONTROL EQUIPMENT FOR THIS PROJECT SHALL BE "ECONOLITE" TO MATCH THE EXISTING ADJACENT SYSTEM.

FILE NAME = #FILE#	USER NAME = #USER#	DESIGNED - PKG	REVISED -
		DRAWN - MAA, EA	REVISED -
		CHECKED - PKG, EA	REVISED -
		DATE - 5/10/2010	REVISED -

**STATE OF ILLINOIS
DEPARTMENT OF TRANSPORTATION**

EXISTING TEMPORARY TRAFFIC SIGNAL, MODIFICATION PLAN, AND REMOVAL PLAN			
ILLINOIS ROUTE 53 (ROHLWING RD.) AT MEDINAH DR./SPRING LAKE DR.			
STAGE 2 AND STAGE 3 (SHEET 2 OF 3)			
SCALE: 1"=20'	SHEET NO.	OF SHEETS	STA. TO STA.

F.A.P. RTE. 2578	SECTION 532B	COUNTY DuPage	TOTAL SHEETS 781	SHEET NO. 473
FED. ROAD DIST. NO. - ILLINOIS			FED. AID PROJECT CONTRACT NO. 60477	