

THE TRAFFIC SIGNAL CONTROL EQUIPMENT FOR THIS PROJECT SHALL BE "ECONOLITE" TO MATCH THE EXISTING ADJACENT SYSTEM.

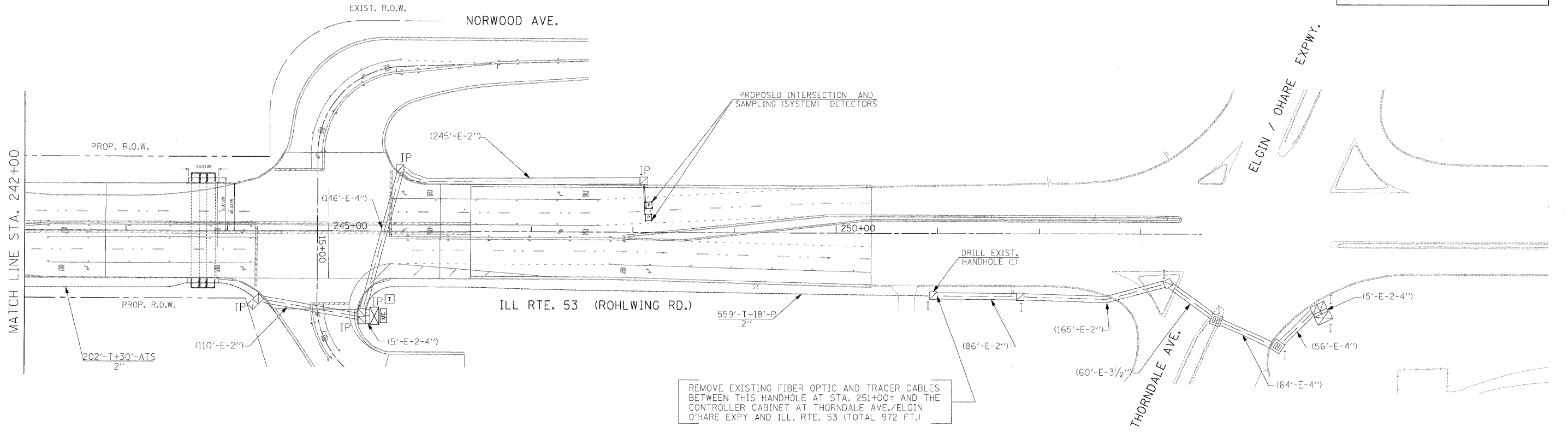

FILE NAME = #FILEL#	USER NAME = #USER#	DESIGNED - PKG	REVISED -
		DRAWN - MAA, EA	REVISED -
		CHECKED - PKG, EA	REVISED -
		DATE - 5/10/2010	REVISED -

**STATE OF ILLINOIS
DEPARTMENT OF TRANSPORTATION**

PROPOSED INTERCONNECT PLAN		F.A.P. RTE. 2578	SECTION 532B	COUNTY DuPage	TOTAL SHEETS 781	SHEET NO. 545
ILL. RTE. 53 (ROHLWING RD.) FROM NORDIC RD./BLOOMINGDALE RD. TO ELGIN-O'HARE EXPWY/THORNDALE AVE. (SHEET 4 OF 4)		SCALE: 1"=50'		SHEET NO. OF SHEETS	STA. TO STA.	CONTRACT NO. 60477
FED. ROAD DIST. NO. ILLINOIS FED. AID PROJECT						