

NOTES:

1. ALL OF THE TEMPORARY LIGHTS ON CIRCUITS E, F, G, AND H ARE CONNECTED TO THE EXISTING LIGHTING CONTROLLER LOCATED ON ILL. RTE. 53 AND I-355 EXIT RAMP (SB), AND SHALL REMAIN IN PLACE AND OPERATIONAL UNTIL PERMANENT LIGHTING ARE INSTALLED, THE PERMANENT LIGHTING ARE CONNECTED TO THE SAME CIRCUITS. THE SWITCH FROM TEMPORARY LIGHTING TO PERMANENT LIGHTING SHALL BE PERFORMED DURING THE DAY HOURS BY REWIRING THE CONTROLLER TO THE PERMANENT LIGHTING.
2. THE CONTRACTOR SHALL PROVIDE AND INSTALL 60' WOOD POLES IN THE LOCATIONS SPECIFIED TO SUPPORT THE PROPOSED TEMPORARY AERIAL CABLES.
3. THE CONTRACTOR SHALL PROTECT ALL LIGHTING EQUIPMENT IN THE CONSTRUCTION ZONE. THIS PROTECTION SHALL APPLY TO ALL LIGHT POLES; EXISTING, TEMPORARY, AND PROPOSED.

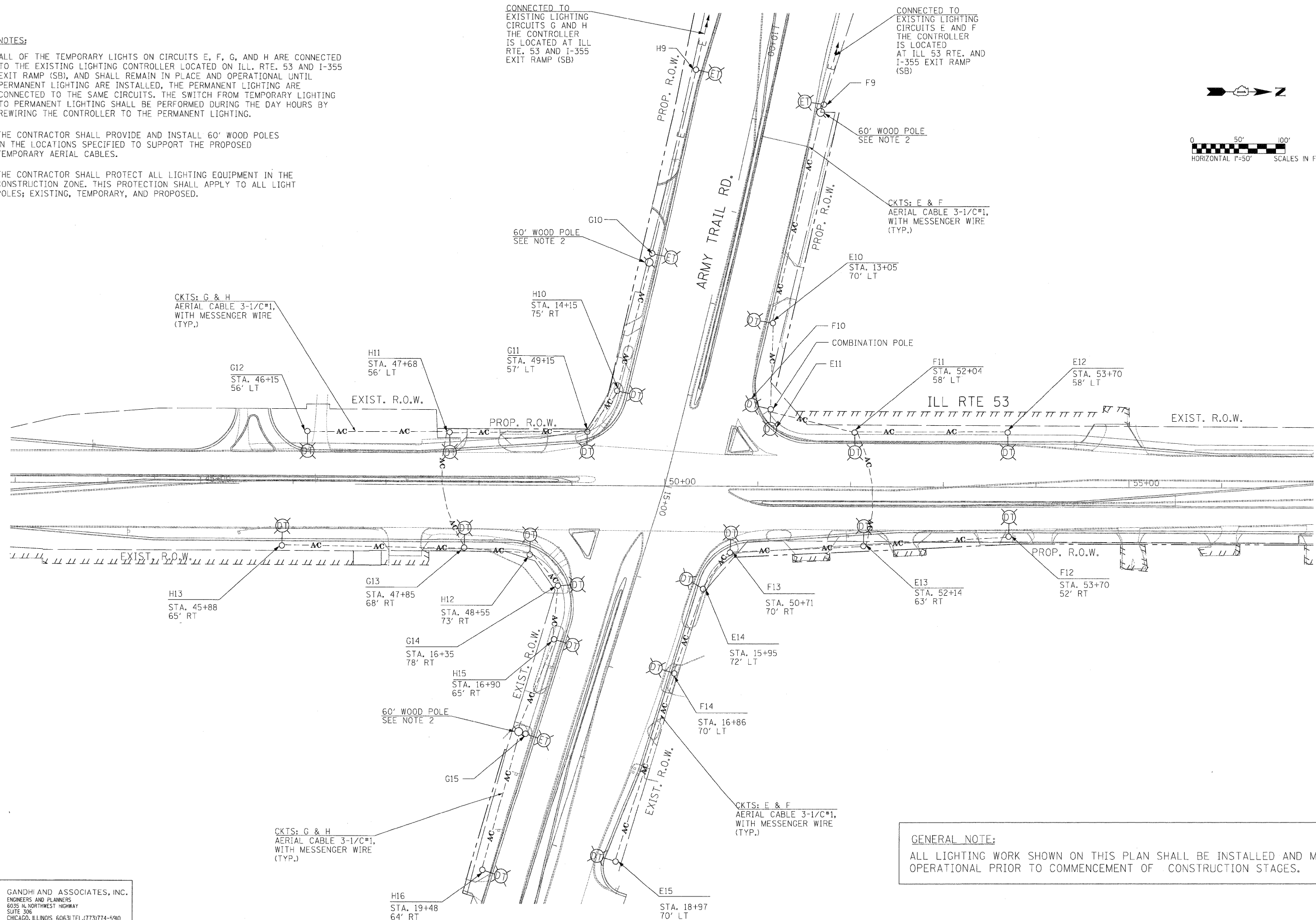
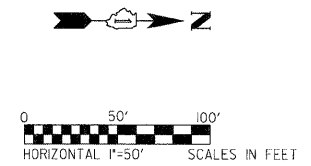

GENERAL NOTE:
ALL LIGHTING WORK SHOWN ON THIS PLAN SHALL BE INSTALLED AND MADE OPERATIONAL PRIOR TO COMMENCEMENT OF CONSTRUCTION STAGES.

GA GANDHI AND ASSOCIATES, INC.
ENGINEERS AND PLANNERS
6035 N. NORTHWEST HIGHWAY
SUITE 306
CHICAGO, ILLINOIS 60631 TEL: 773/774-5900

FILE NAME =	USER NAME = DAL	DESIGNED - PKG	REVISED -
#FILEL#		DRAWN - MAA, SHM	REVISED -
	PLOT SCALE = 1"=50'	CHECKED - PKG	REVISED -
	PLOT DATE = 11/24/2010	DATE -	REVISED -

**STATE OF ILLINOIS
DEPARTMENT OF TRANSPORTATION**

**TEMPORARY LIGHTING PLAN
ILL. RTE. 53 AT ARMY TRAIL ROAD**

SCALE: 1"= 50' SHEET NO. OF SHEETS STA. TO STA.

F.A.P. RTE.	SECTION	COUNTY	TOTAL SHEETS	SHEET NO.
2578	532B	DuPage	781	565
FED. ROAD DIST. NO. 1 ILLINOIS FED. AID PROJECT			CONTRACT NO. 60477	