

WEST EDGE OF SLAB

Location	Station	Offset	Theoretical Grade Elevations
S. End of S. Appr. Slab	240+29.25	-46.08	717.05
A	240+39.25	-46.08	716.99
B	240+49.25	-46.08	716.93
N. End of S. Appr. Slab	240+59.25	-46.08	716.87
S. End of N. Appr. Slab	246+10.75	-46.08	717.67
C	246+20.75	-46.08	717.74
D	246+30.75	-46.08	717.81
N. End of N. Appr. Slab	246+40.75	-46.08	717.88

WEST SLOPE BREAK

Location	Station	Offset	Theoretical Grade Elevations
S. End of S. Appr. Slab	240+29.25	-31.50	717.41
A	240+39.25	-31.50	717.35
B	240+49.25	-31.50	717.29
N. End of S. Appr. Slab	240+59.25	-31.50	717.23
S. End of N. Appr. Slab	246+10.75	-31.50	718.03
C	246+20.75	-31.50	718.10
D	246+30.75	-31.50	718.17
N. End of N. Appr. Slab	246+40.75	-31.50	718.24

S.B. PGL

Location	Station	Offset	Theoretical Grade Elevations
S. End of S. Appr. Slab	240+29.25	0.00	718.04
A	240+39.25	0.00	717.98
B	240+49.25	0.00	717.92
N. End of S. Appr. Slab	240+59.25	0.00	717.86
S. End of N. Appr. Slab	246+10.75	-6.50	718.53
C	246+20.75	-6.50	718.60
D	246+30.75	-6.50	718.67
N. End of N. Appr. Slab	246+40.75	-6.50	718.74

IL RTE 53 & STAGE CONSTR. LINE

Location	Station	Offset	Theoretical Grade Elevations
S. End of S. Appr. Slab	240+29.25	0.00	718.04
A	240+39.25	0.00	717.98
B	240+49.25	0.00	717.92
N. End of S. Appr. Slab	240+59.25	0.00	717.86
S. End of N. Appr. Slab	246+10.75	0.00	718.66
C	246+20.75	0.00	718.73
D	246+30.75	0.00	718.80
N. End of N. Appr. Slab	246+40.75	0.00	718.87

N.B. PGL

Location	Station	Offset	Theoretical Grade Elevations
S. End of S. Appr. Slab	240+29.25	0.00	718.04
A	240+39.25	0.00	717.98
B	240+49.25	0.00	717.92
N. End of S. Appr. Slab	240+59.25	0.00	717.86
S. End of N. Appr. Slab	246+10.75	6.50	718.53
C	246+20.75	6.50	718.60
D	246+30.75	6.50	718.67
N. End of N. Appr. Slab	246+40.75	6.50	718.74

EAST SLOPE BREAK

Location	Station	Offset	Theoretical Grade Elevations
S. End of S. Appr. Slab	240+29.25	31.50	717.41
A	240+39.25	31.50	717.35
B	240+49.25	31.50	717.29
N. End of S. Appr. Slab	240+59.25	31.50	717.23
S. End of N. Appr. Slab	246+10.75	31.50	718.03
C	246+20.75	31.50	718.10
D	246+30.75	31.50	718.17
N. End of N. Appr. Slab	246+40.75	31.50	718.24

EAST EDGE OF SLAB

Location	Station	Offset	Theoretical Grade Elevations
S. End of S. Appr. Slab	240+29.25	46.08	717.05
A	240+39.25	46.08	716.99
B	240+49.25	46.08	716.93
N. End of S. Appr. Slab	240+59.25	46.08	716.87
S. End of N. Appr. Slab	246+10.75	46.08	717.67
C	246+20.75	46.08	717.74
D	246+30.75	46.08	717.81
N. End of N. Appr. Slab	246+40.75	46.08	717.88

**TOP OF APPROACH SLAB ELEVATIONS
STRUCTURE NO. 022-0012**

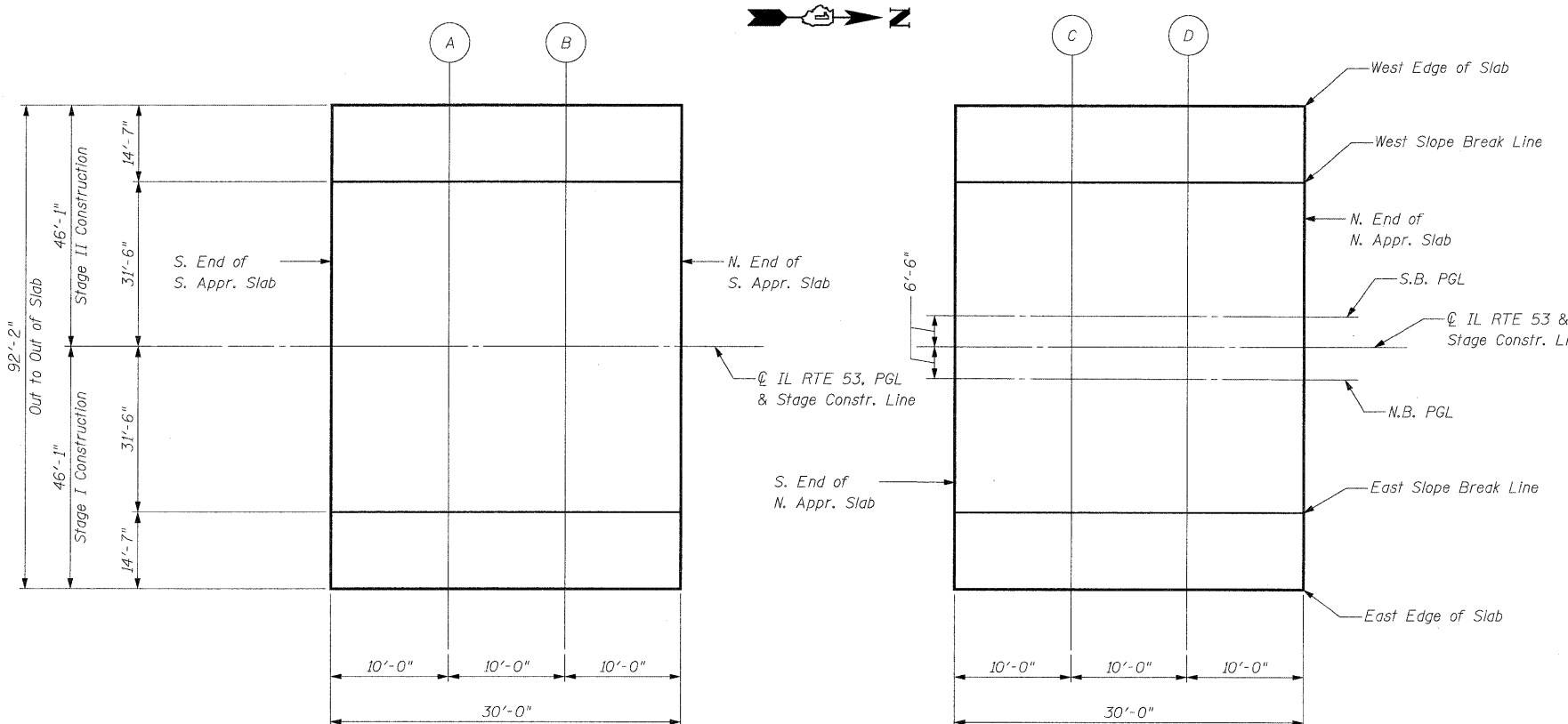

PLAN

DESIGNED	- J. Refvik
CHECKED	- J. Vermillion
DRAWN	- J. Vermillion
CHECKED	- R. DiGiulio

E-AS 11-1-09

PATRICK ENGINEERING INC.
 4970 VARSITY DRIVE
 LISLE, IL 60532
 patrickengineering.com

SHEET NO. SAB OF SA37	F.A.P RTE. 2578	SECTION 532B	COUNTY DUPAGE	TOTAL SHEETS 781	SHEET NO. 612
	CONTRACT NO. 60477				
12/3/2010		ILLINOIS FED. AID PROJECT			