

SOUTH APPROACH PLAN

* Tilt #9 b₁₃(E) bars as required to maintain clearance.

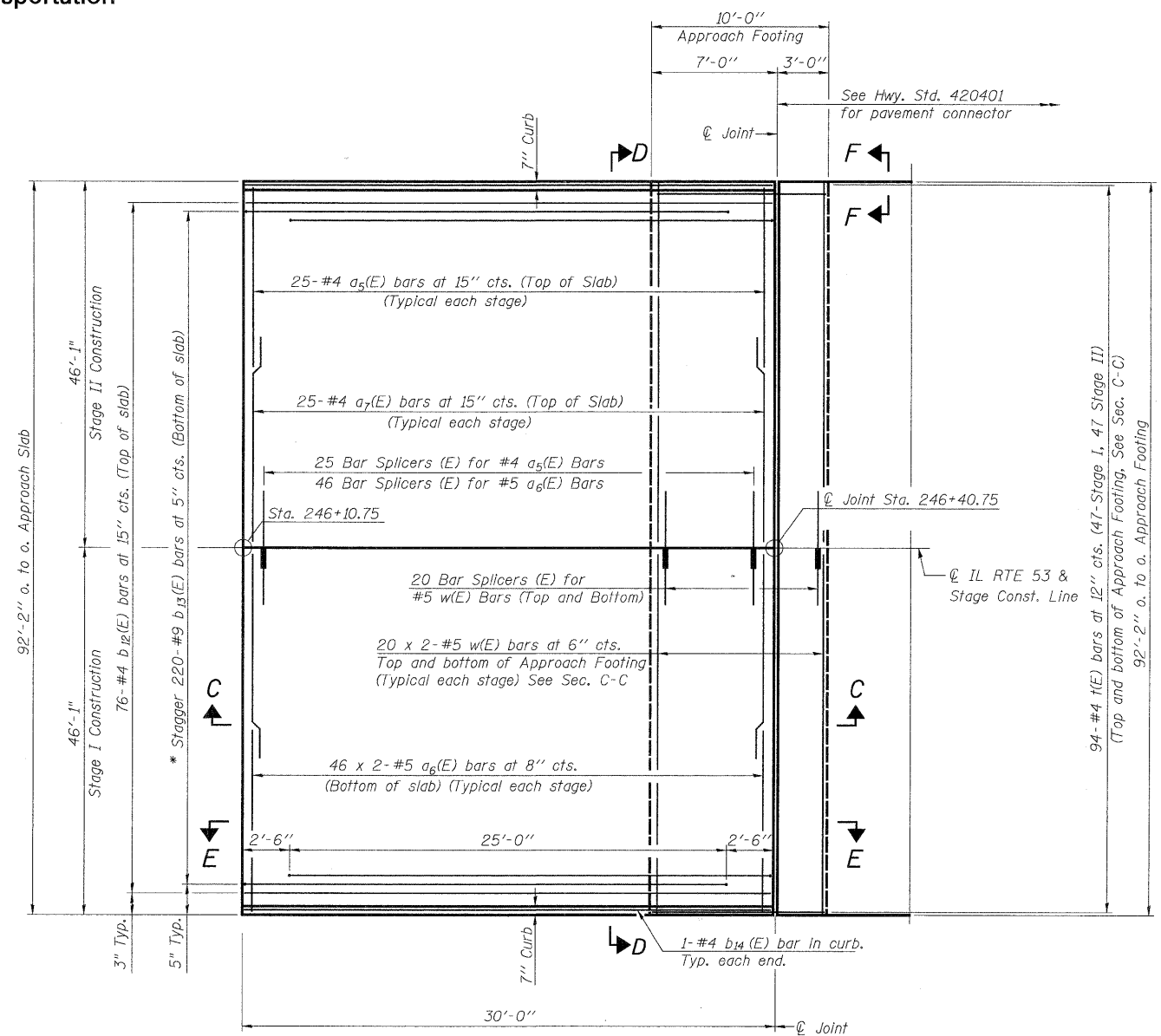

NORTH APPROACH PLAN

* Tilt #9 b₁₃(E) bars as required to maintain clearance.



TYP. LAP SPLICE

BAR SIZE	MIN. LAP
#4	2'-4"
#5	2'-7"

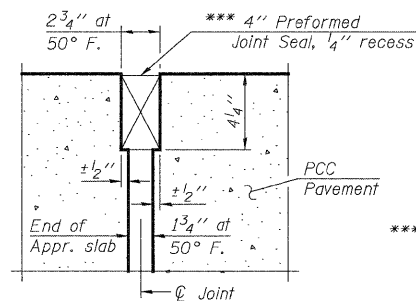

RIGID PAVEMENT

DETAIL A

*** Cost included with Concrete Superstructure.

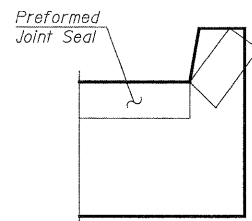

VIEW F-F

Angle Preformed Joint Seal at 45° at curbs when req'd for drainage.

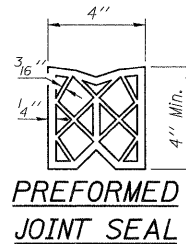

Notes:

See Sheet SA15 for Sections C-C, D-D, & G-G and View E-E. a₅(E), a₆(E), & a₇(E) bar spacings measured along \bar{C} Rdwy.

DESIGNED - J. Vermillion
CHECKED - J. Refvik
DRAWN - J. Vermillion
CHECKED - R. DiGiulio

PATRICK ENGINEERING INC.
4970 VARSITY DRIVE
LISLE, IL 60532
patrickengineering.com

SHEET NO.	F.A.P RTE.	SECTION	COUNTY	TOTAL SHEETS	SHEET NO.
SA14 OF SA37	2578	532B	DUPAGE	781	618
CONTRACT NO. 60477					
			12/3/2010	ILLINOIS FED. AID PROJECT	

IL 53 APPROACH SLAB I
STRUCTURE NO. 022-0012