

DATE	
BY	
FINISHED SURVEY	
PLOTTED TEMPLATE	
NOTE BOOK	
AREAS CHECKED	
NO.	

DATE	
BY	
ORIGINAL SURVEY	
PLOTTED TEMPLATE	
NOTE BOOK	
AREAS CHECKED	
NO.	

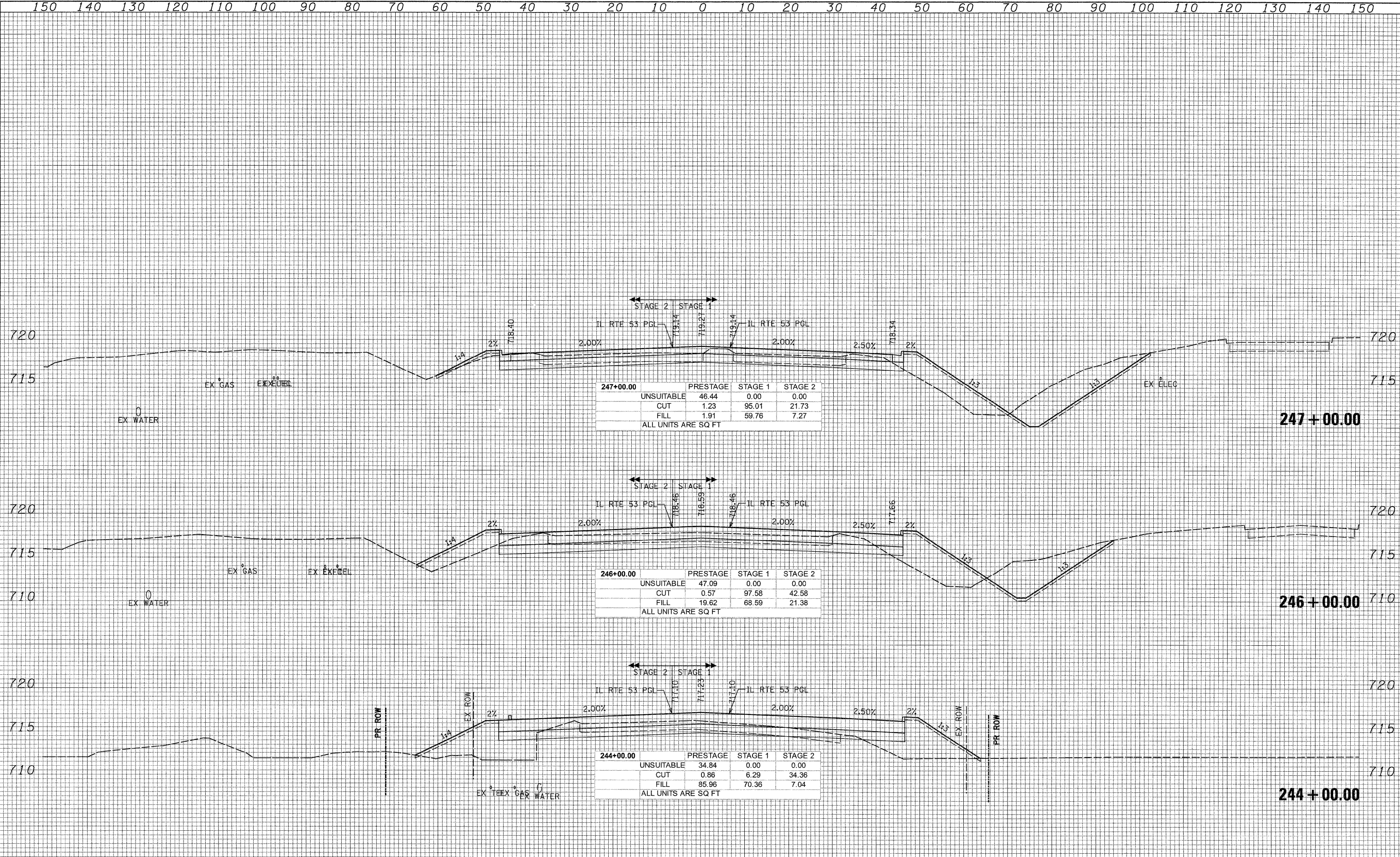

150	140	130	120	110	100	90	80	70	60	50	40	30	20	10	0	10	20	30	40	50	60	70	80	90	100	110	120	130	140	150					
PATRICK ENGINEERING INC. 4570 VARSITY DRIVE LISLE, IL 60532 patrickengineering.com																USER NAME = tkoeppen(fdwj_L1s1e) DESIGNED - DRAWN - CHECKED - DATE - 12/3/2010				REVISED - REVISED - REVISED - REVISED -				STATE OF ILLINOIS DEPARTMENT OF TRANSPORTATION				ILLINOIS ROUTE 53 CROSS SECTIONS				F.A.U. RTE. 2578 SECTION 532B COUNTY DUPAGE TOTAL SHEETS 781 SHEET NO. 747		CONTRACT NO. 60477 FED. ROAD DIST. NO. ILLINOIS FED. AID PROJECT	
PLOT SCALE = 10,000.00' / IN. PLOT DATE = 12/3/2010																STA. 244+00.00 TO STA. 247+00.00				SCALE: 1"=10' HORIZ. 1"=5' VERT. SHEET NO.															

D:\1001\9356_A0 (IL 53)\Drawings\CADD Sheets\019139797-sht-xssht.657-748.dgn