

150 140 130 120 110 100 90 80 70 60 50 40 30 20 10 0 10 20 30 40 50 60 70 80 90 100 110 120 130 140 150

| | |
|--------------|--|
| DATE | |
| BY | |
| REVIEWED | |
| PLOTTED | |
| TEMPLATE | |
| AREAS | |
| CHECKED | |
| FINAL SURVEY | |
| NOTE BOOK | |
| NO. | |

| | |
|-----------------|--|
| DATE | |
| BY | |
| REVIEWED | |
| PLOTTED | |
| TEMPLATE | |
| AREAS | |
| CHECKED | |
| ORIGINAL SURVEY | |
| NOTE BOOK | |
| NO. | |

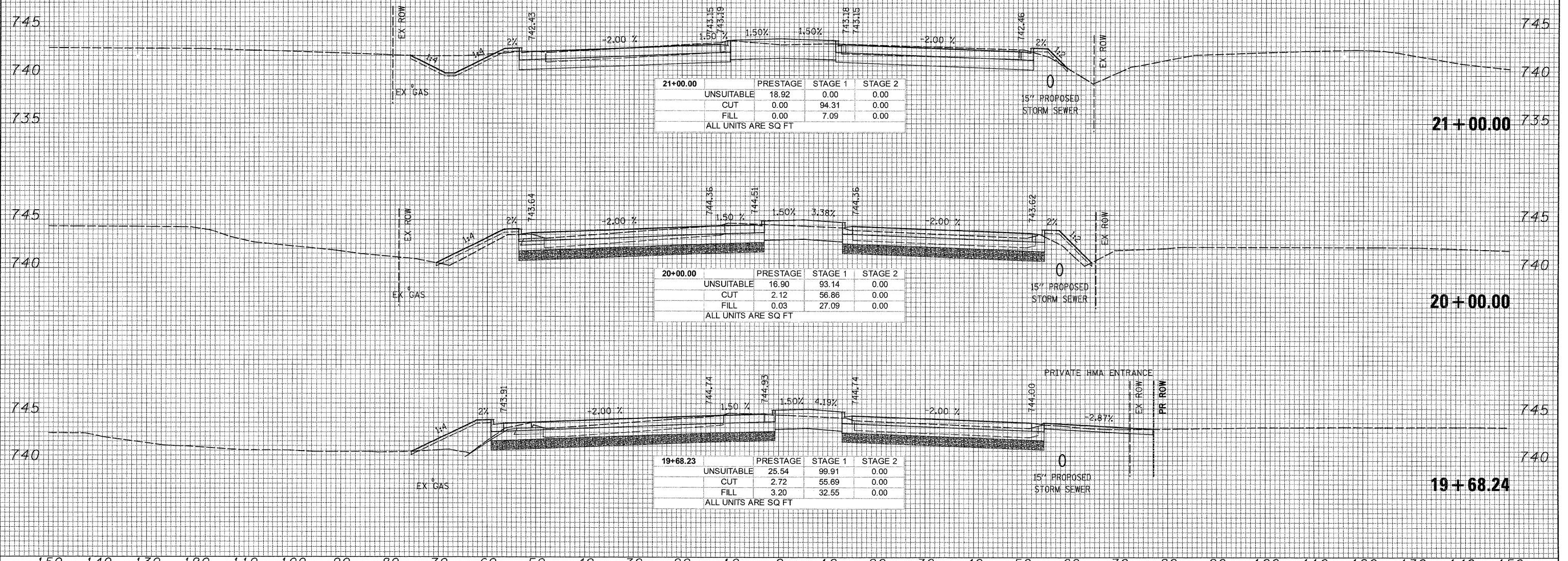

150 140 130 120 110 100 90 80 70 60 50 40 30 20 10 0 10 20 30 40 50 60 70 80 90 100 110 120 130 140 150

PATRICK ENGINEERING INC.
4970 VARSITY DRIVE
LISLE, IL 60532
patrickengineering.com

USER NAME = tkoeppen(Rdwy_Lisle)
DESIGNED -
DRAWN -
CHECKED -
DATE = 12/3/2010

REVISED -
REVISED -
REVISED -
REVISED -

**STATE OF ILLINOIS
DEPARTMENT OF TRANSPORTATION**

**ARMY TRAIL
CROSS SECTIONS**
SCALE: 1"=10' HORIZ.
1"=5' VERT. SHEET NO. STA. 19+68.24 TO STA. 21+00.00

| | | | | |
|---|---------|--------|--------------------|-----------|
| F.A.U. RTE. | SECTION | COUNTY | TOTAL SHEETS | SHEET NO. |
| 2578 | 532B | DUPAGE | 781 | 753 |
| FED. ROAD DIST. NO. ILLINOIS FED. AID PROJECT | | | CONTRACT NO. 60477 | |

Q:\100T\9356_A0_GL53\Drawings\CADD Sheets\019139797-sht-xshtL749-753.dgn